

N

MOUZA - ASANGI  
THANA - SARAIKELA  
THANA NO - 131  
SHEET NO - 1  
DIST. - (SERAIKELA KHARSWAN)  
SCALE - 16"= 1 Mile  
YEAR - 1958 - 59

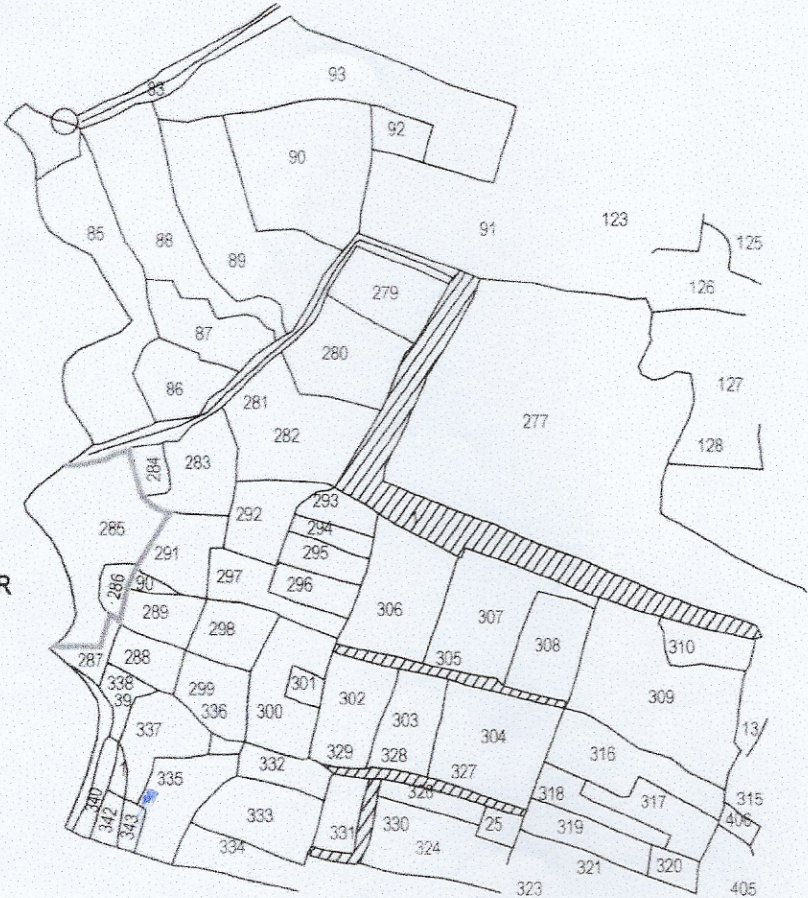

VILLAGE PARVATIPUR

AREA SHOWN IN

| KHATA NO | PLOT NO | AREA                     |
|----------|---------|--------------------------|
| 155      | 285 (P) | 3239 Sq.ft.              |
| 156      | 286 (P) | 761 Sq.ft.               |
|          |         | Total Area = 4000 Sq.ft. |

NORTH - ROAD & PORTION OF PLOT NO.285,286  
 SOUTH - PORTION OF PLOT NO. 285 & 287  
 EAST - PLOT NO. 283,284,291,290,289 & 287  
 WEST - VILLAGE PARVATIPUR & PORTION OF PLOT NO.285 & 286

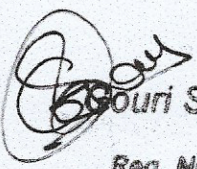

*Signature*  
 26.04.2015.

  
**Gour Shankar Roy**  
 Amin  
 Reg. No.- 4480/2014