

BOUNDARY MAP OF DINDY SECTOR NO 6 H.I. A. PLOT NO H/164 WHICH IS  
 ALLOTTED TO SRI SHARAD BAJAJ. Sd/- MADAN LAL BAJAJ. VIAD BOARD'S  
 LETTER NO 1181 DATED 28/7/07 IN LIEU OF PREVIOUS ALLOTTED PLOT NO  
 H/124 AT DINDY KOTYAPUR JAMSHEDPUR. SCALE: 1" = 20' 0"  
 REFERENCE TO PLAN H-65-0'x29-0'=1005.00 Sd/- SPOKIN SWA:-

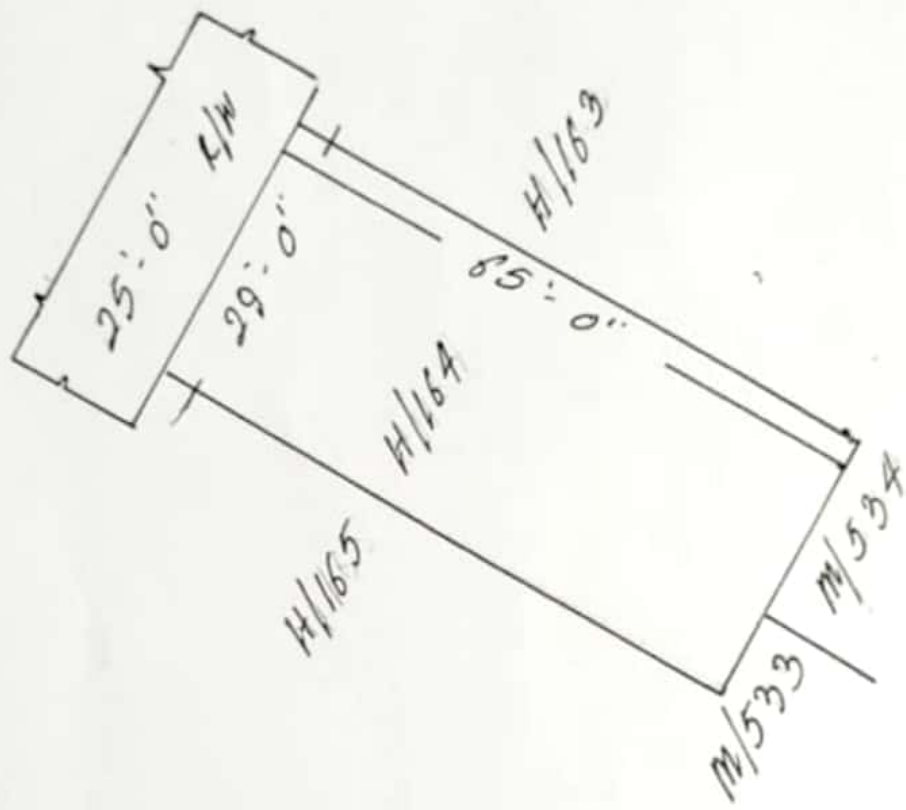

CERTIFIED THAT THE ORIGINAL AND DUPLICATE MAPS ARE TRUE AND EXACT  
 REPRODUCTION OF EACH OTHER

Sharat Bajaj

*[Signature]*  
28/8/2017

*[Signature]* 28/8/2017

SIGNATURE  
 OF THE  
 OFFICER

A.E.  
 S. K. SINGH  
 DM

SIGNATURE OF THE OFFICER IN CHARGE  
 ON BEHALF OF S.C.S. & D.  
 JAMSHEDPUR