

N

MOUZA - ASANGI

THANA - SERAIKELA

THANA NO - 131

SHEET NO - 2

DIST. - (SERAIKELA - KHARSWAN)

SCALE - 16"= 1 Mile

YEAR - 1958 - 59

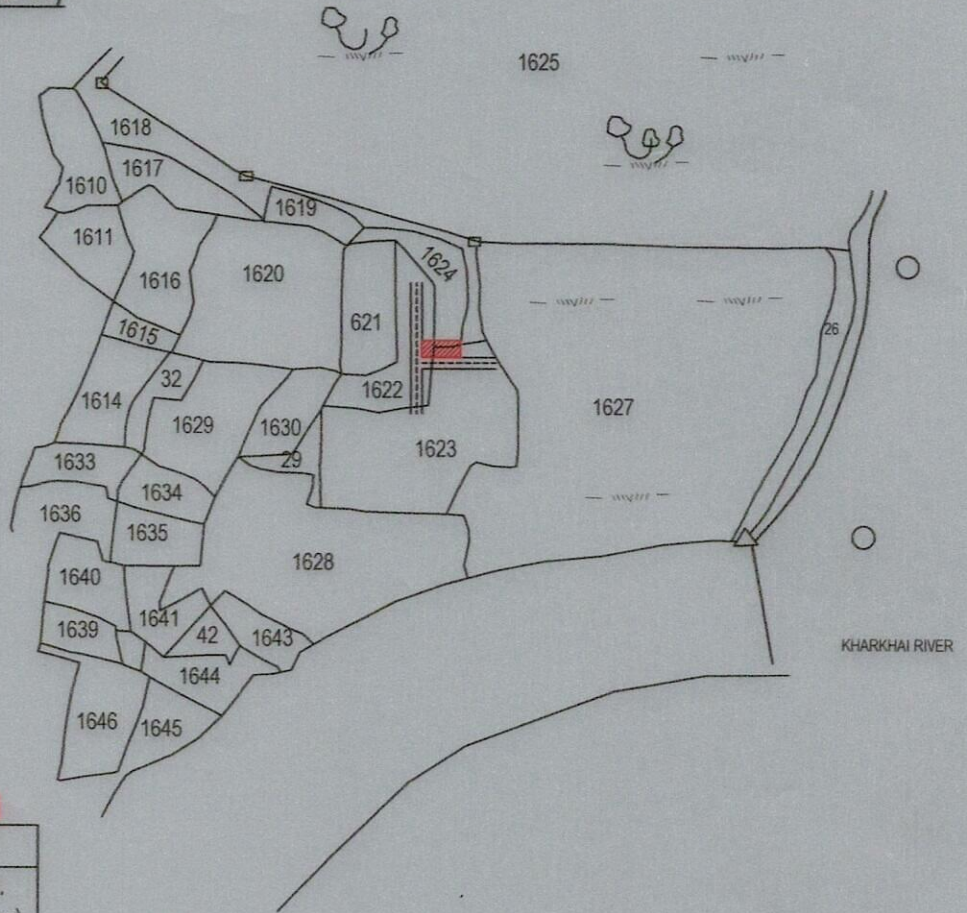

AREA SHOWN AS



KHATA NO	PLOT NO	AREA
O - 181 N - 39	O - 1624 (P) N - 411 (P)	750 Sq.ft. or (1.72 Dec)
O - 179 N - 40	O - 1622 (P) N - 409 (P)	499 Sq.ft. or (1.15 Dec)
O - 179 N - 40	O - 1623 (P) N - 407 & 408 (P)	934 Sq.ft. or (2.14 Dec)
Total Area = 2183 Sq.ft. or (5.01 Dec)		

NORTH - PORTION OF PLOT NO. 1622 & 1624

SOUTH - 20' WIDE ROAD

EAST - PORTION OF PLOT NO. 1623 & 1618

WEST - 20' WIDE ROAD



*[Handwritten signature]*

*[Handwritten signature]*

*[Handwritten signature]*  
A Amin

Reg.no:- 784/02-03