

PART PLAN OF LAND IN MOUZA - CHAS. SHEET NO 1 - THANA - CHAS. -
 NO 30 PARGANA - KHASPEL, DIST - DHANBAD. - SCALE - 16 INCHES
 TO ONE MILE = 1" = 330 FT (OR) 1" = 100 METERS. - - -

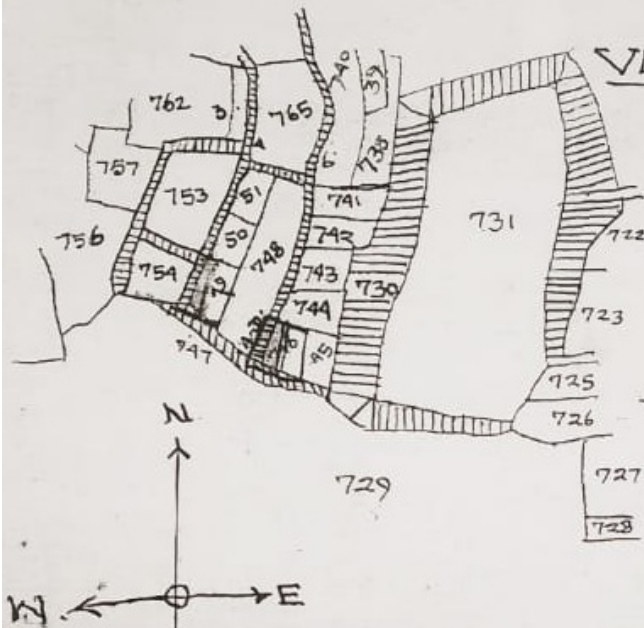

VENDOR → SALIGRAM CHAR-MODAK
 S/O LATE ANANTA-CHAR-MODAK
 OF CHAS-P.S.-CHAS, DIST-DHANBAD. - -

VENDEE → SRI-KAILASH-PRASAD-S/O
 BALDEO-PRASAD-OF CHAS-
 B-S-CITY - - - - -

SCHEDULE OF LAND - A-D-MARK AREA - 10 1/2 DECI

KHATA-NO 172-UNDER PLOT-NO 746 ARE
 -16 DECI- OUT OF WHICH -"A" MARK -
 AREA-05 1/2 DECI- AND PLOT-NO 766
 AREA- OUT OF WHICH D." MARK AREA
 -0 1/2 DECI- TOTAL AREA-10 1/2 DECI
 -MAL. ONLY-SHOWS RED-COLOUR.
 PLOT-NO 747 AREA-OUT OF WHICH
 -"E" MARK-00 3/4 DECI -
 TOTAL - 10 1/2 Decimal -

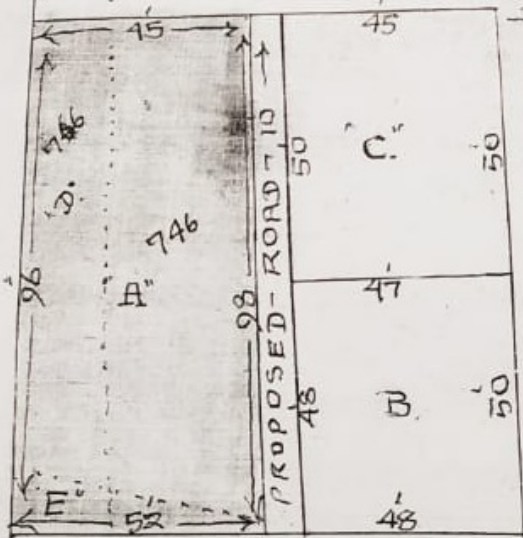

TRUE COPY

(Handwritten signature)

(Handwritten signature)

(Handwritten signature)

(Handwritten signature)

SCALE 1" = 40'

Traced by -
 Nibaran Chandra Bha
 Am at Chas
 9-4-83