

BRIEF SPECIFICATION

STEEL = Fe-500 Grade TMT Steel Shall be used.
 FOUNDATION = CEMENT CONCRETE(1:1.5:3)M20 Grade.
 SUPERSTRUCTURE = BRICK WORK IN CM(1:6)
 FLOORING = 25 MM L.P.S. MARBLE/MOSAIC OVER 3" THICK P.C.C.
 D.P.C. = 25 MM TH. D.P.C. IN CEMENT CONCRETE(1:1.5:3)
 PLINTH = 0.15 M TH. R.C.C. BAND ALL ROUND IN M20 CONCRETE
 LINTELS = 0.15 M TH. R.C.C. LINTEL IN M20 GRADE CONCRETE
 WOOD WORK = ALL WOOD WORK IN HARD WOOD.
 PLASTERING = 12mm TH. CEMENT PLASTER BOTH SIDE IN CM (1:6)
 FINISHING = FIRST CLASS APPROVED QUALITY.
 ANTITERMITE = ANTI TERMITTE TREATMENT IN FLOOR SHALL BE DONE.
 WATER PROOFING = ROOF AND WALL SHALL BE OF WATER RESISTANT.
 DRAINAGE = ADEQUATE DRAINAGE SHALL BE PROVIDED.
 IS CODES = BUILDING CODE OF INDIA SHALL BE FOLLOWED.
 CEMENT = 53 GRADE PRODUCED FROM 'A' GRADE PLANT.
 WALL = OUTER(0.23 THICK) & INNER(0.12 THICK)

SCHEDULE OF OPENINGS

D = 1.00X2.10	D1 = 0.90X2.10	D2 = 0.75X2.10
W = 1.20X1.20	W1 = 0.90X1.20	V = 0.60X0.45

SCHEDULE OF AREA

Basement	Ground Floor	1st & 2nd Floor	Terrace
12.00	12.00	12.00	12.00

TITLE OF DRAWING

SIGNATURE OF OWNER

SIGNATURE OF ENGINEER

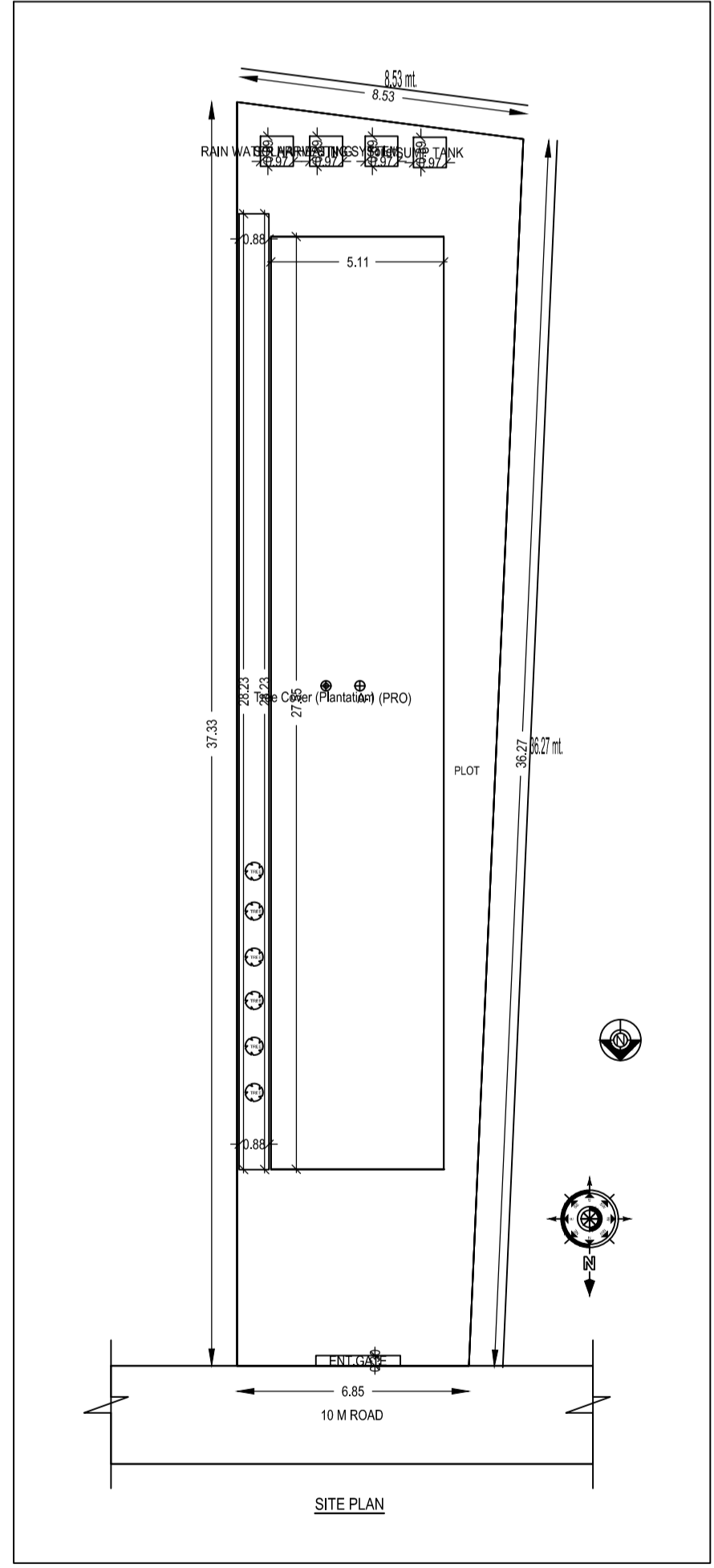

A (PRO)