

Baraga Kharfel mouza Chas sheet No 1 Thang Chas No. 30  
 18th St. Bakoro. 'Jharkhand'  
 Scale. 1" = 330 feet

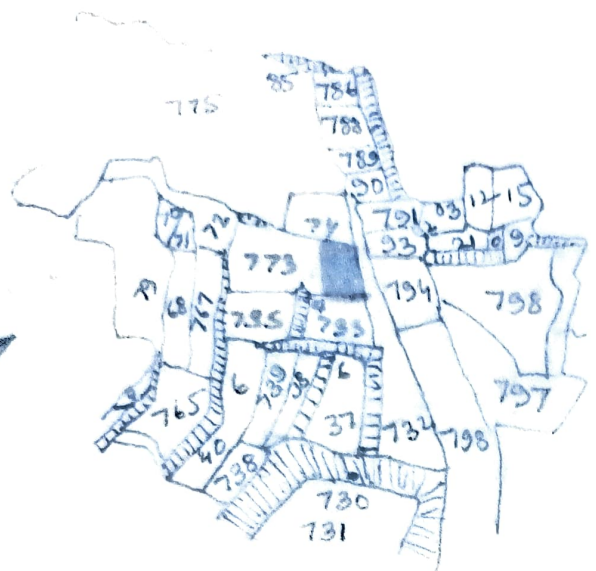

Schedule of land Red class		
Khatam	Plot m	Area
172	773	10 1/2 Bg
Total Area		10 1/2 Bg only

Vendor

---



---



---



---



---



---



---



---

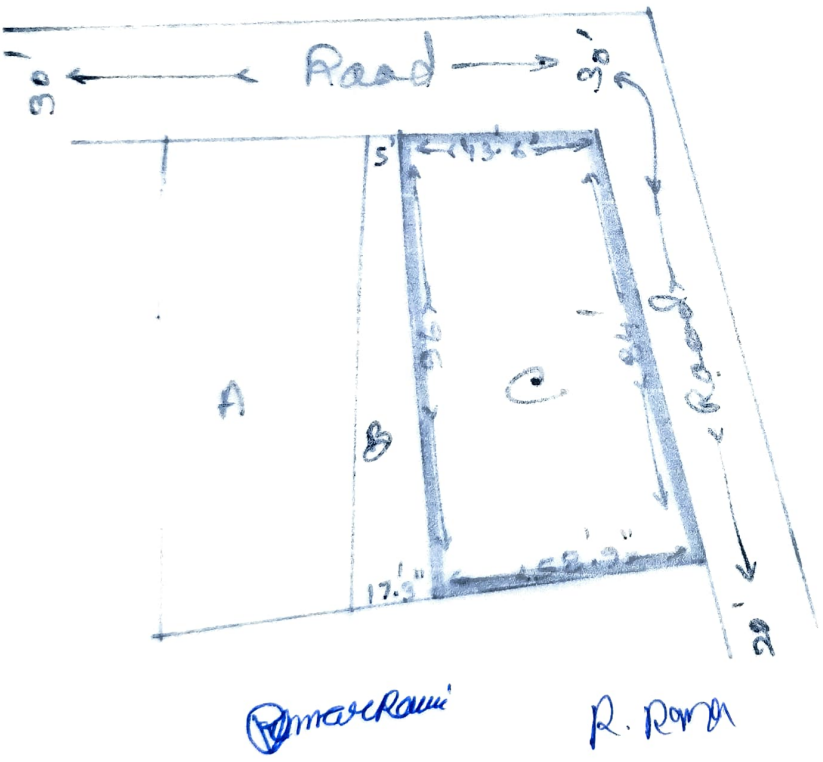

V.B → Details of area schedule of land e. mark True Copy  
 Dairies filled with red line with Red Traced to  
 class in this map. Amin?  
 [Signature]