

A Part Plan of Mouza - Bhawanipur
 alais solagidih sheet NO-1. Thana
 - Chas. No-52. Paragona Khaspel
 Dist - Bokara. Scale 1" = 330'.
 Jharkhand.

Schedule of Land A _{1/3}			
Khata NO:-	plot NO:-	out of area	
		A.	D.
119	296	-	2 ¹ / ₄
Total area:-			2 ¹ / ₄

Vender: Sri Upendra Singh.
 s/o Sri jityu Singh.
 of chas Bokara

Vendee: ① Basudeo Mahata
 ② Rajesh Kumar Mahata
 ③ Bijay Kumar Mahata
 s/o Sri Chet Lal Mahata.
 of godhadikmore chas
 Bokara.

Boundary of This Land.
 N:- Sahadeo modi.
 S:- 8' Road;
 E:- Chas Dhanbad Rd.
 W:- Vender's own Land.



34/23/14/1
 19/7/13

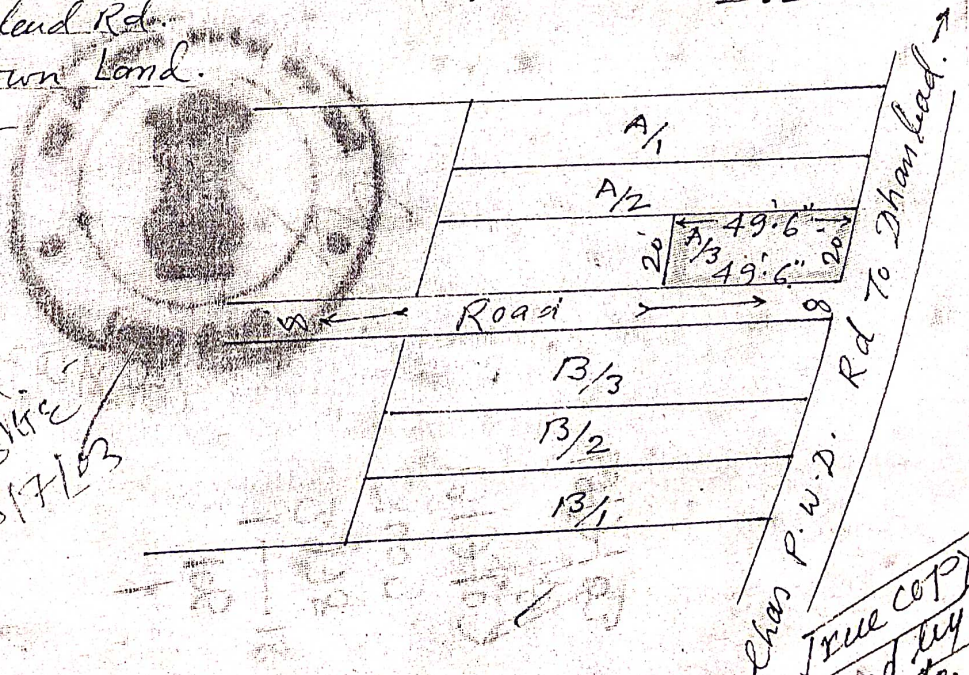

Chas P.W.D. Rd To Dhanbad. →
 True copy
 Traced by
 Chas
 Bokra

NB:- Details of area schedule "A_{1/3}" dimar cated
 with red line with red colour in This map.

Basudeo Mahata
 LICHA SMC NEER
 Vign

A Part Plan of Mouza Bhawanipur
 colais solagidih street no-1. Thana
 Chas no-52. Paragona-Khaspel
 Dist - Bokaro scale 1" : 330'
 Jharkhand.

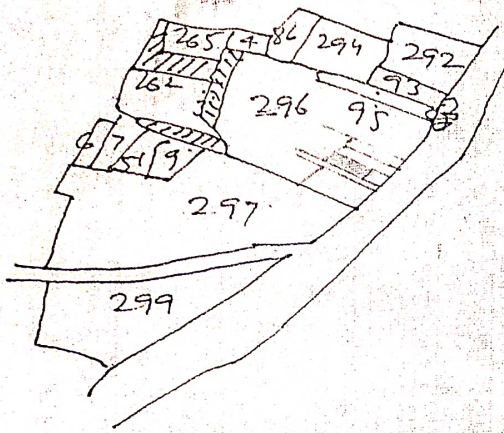

Schedule of Land A/31			
Khata No.	Plot No.	out of area	
		A.	D.
119	296	-	2 $\frac{3}{4}$
Total area :- 2 $\frac{3}{4}$ Dec only			

Vender: Sri Upendra Singh.
 S/o Sri Jityu Singh.
 of Chas Bokaro

Vendee: - Basudeo Mahato
 ① Rajesh Kumar Mahato.
 ② Bi Bijay Kumar Mahato
 S/o Sri Chet Lal
 Mahato. of jodhadikmore
 Chas Bokaro.

Boundary of this land.
 N: Sahades Modi
 S: 8' Road.
 E: Basudeo Mahato & others
 W: Chet Lal Mahato

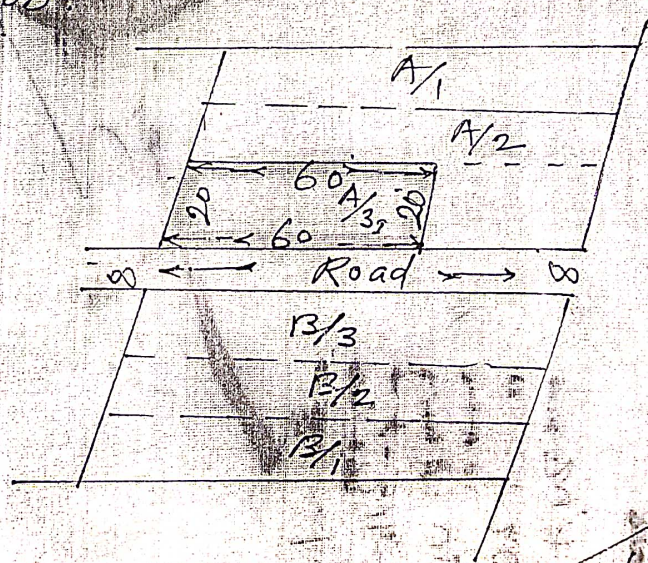

S/o Sri Jityu Singh

NB: - Details of area Schedule A/31 limar Cated with Red line with Red Colour in this map.

True copy
 Traced by
 Basudeo Mahato
 of Chas Bokaro

Basudeo Mahato
 श्री बासुदेव महतो
 विस 7