

PART PLAN OF LAND IN  
 MOUZA - CHAS  
 THANA No - 30  
 THANA - CHAS  
 DIST - BOKARO  
 SCALE - 1" = 330'

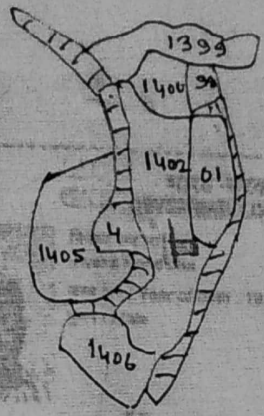

SCHEDULE OF LAND RED MARK		
KHATA No	PLOT No	AREA
584	1402	(3750) SLP
Total area of -		8.60 dec

BOUNDRY

- N - PLOT NO 1402
- S - PLOT NO 1402
- E - PLOT NO 1402
- W - RASTA

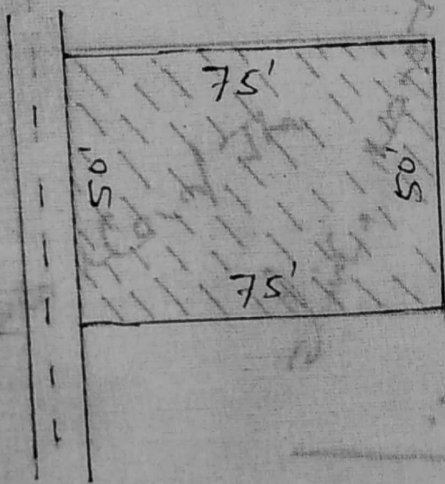

*Director, Rang*

*Amin  
 Suresh Chandra  
 Chas Bokaro  
 06/12*

ATTESTED  
*[Signature]*  
 Dayodar Kumar  
 NOTARY PUBLIC  
 Bokaro (Jharkhand)  
 Reg. No - 960/J