

Chas Municipal Corporation

SITE VISIT REPORT

Proposal Details

| | |
|--|--------------------------------------|
| Owner Name : RAM VIJAY PRASAD | Site Visit Date : 07 September, 2021 |
| Applicant Name : DINABANDHU RAJAK | File No. : CMC/BP/0202/W11/2021 |
| Ward No. : W11 | Case Type : Addition Alteration |
| Thana No. : 30 | Plot No. : 5970 |
| Road No. / Name : SUBHASH CO-OPERATIVE COLONY CHAS | Registration No. : CMC/ENG/0001/2020 |

Site Visit Checklist

| # | Description | As On Site | Objection | Remark |
|-----|--|---------------------------------------|-----------|---|
| 1. | Whether Existing at Site | Yes | | |
| 2. | Whether connected with an existing public road | Yes | | |
| 3. | Status of road | Public | | |
| 4. | Nature of Road | Kutchha | | |
| 5. | Width of approach road | 6.10 | | |
| 6. | Whether road side drain exists | No | | |
| 7. | if Whether road side drain exists is No - Distance from nearest drain | 300 MTR | | |
| 8. | if Whether road side drain exists is No - easibility to connect | Yes | | |
| 9. | if Whether road side drain exists is No - Scope of widening of road | YES | | |
| 10. | Whether the site is at road junction | No | | |
| 11. | Level of site in relation to approach road | 0.45 | | |
| 12. | Whether the area is subject to | NA | | |
| 13. | Whether the locality is | Developing | | |
| 14. | Distance of the plot from the nearest temple/ monument / Airport/ Other important building | NO | | |
| 15. | The vertical and horizontal distance from 33 KV/11 KV electric line | NO HT ELECTRIC LINE AVAILABLE AT SITE | | |
| 16. | Whether the Site is vacant | No | | |
| 17. | if Whether the Site is vacant No - Stage of construction | 1 | | |
| 18. | if Whether the Site is vacant No - No of Storey | ONE STROREY | | |
| 19. | if Whether the Site is vacant No - Nature of construction | RCC | | |
| 20. | if Whether the Site is vacant No - Sketch enclosed at page | Yes | | |
| 21. | Plot size (As per measurement)(In Sqmt) | 242.89 | | |
| 22. | Whether the applicant encroached the Govt. land/road land/any other land/drainage channel | No | | |
| 23. | Sketch site plan showing the location of the site, important land marks and connectivity with the main road is enclosed. (For site not located on main road) at page | YES, | | |
| 24. | Any other information. | YES | | GROUND FLOOR MAP SANCTIONED OFFLINE MODE AND CONSTRUCTED AS PER PREVIOUS SANCTIONED MAP |
| 25. | Verified the Amins report with/without site inspection and found correct | Yes | | |
| 26. | Land Use | Residential | | |

| | | | | |
|-----|--|----------------------------|--|--|
| 27. | Road | Yes | | |
| 28. | Sewerage | No | | |
| 29. | Drainage | No | | |
| 30. | Water facility | No | | |
| 31. | Availability of drain | No | | |
| 32. | Telephone | No | | |
| 33. | Electricity | Yes | | |
| 34. | Dealing with inflammable/chemical | No | | |
| 35. | Occupancy | No | | |
| 36. | EAST | 6.10 MTR WIDE ROAD | | |
| 37. | WEST | CO-OPERATIVE PLOT NO.- 343 | | |
| 38. | NORTH | CO-OPERATIVE PLOT NO.- 341 | | |
| 39. | SOUTH | SURVEY PLOT NO.- 5970,5972 | | |
| 40. | Length of the Road(In Mtr.) | Up to 50 meter | | |
| 41. | Existing Width of the Road(In Mtr.) | 6.1 | | |
| 42. | Proposed Width of the Road as per Master Plan(In Mtr.) | 0 | | |
| 43. | Width of the RoadWidening(In Mtr.) | 0 | | |
| 44. | Plot area (As per deed) | 242.89 | | |

Site Visit Photographs :



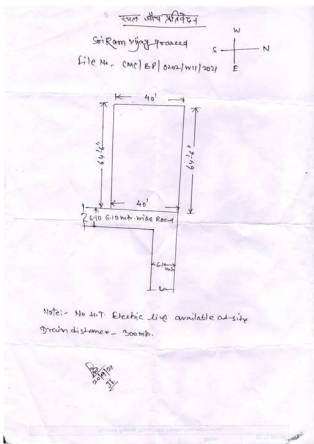

Recommendation : Verified & found Ok

Remark : OK

Bishwas Kumar
Junior Engg