

A Part Plan of Land in Mauza -
 Chas. Sheet No. 1, P.S. Chas. No. 30
 Barguna Khaspel, Dist. Borara
 (Jharkhand) Scale - 1:200

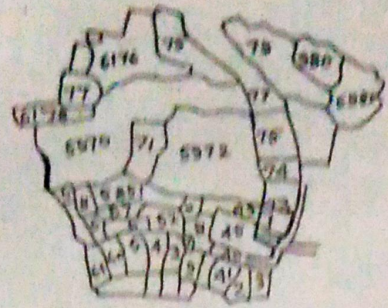

Schedule of Land A/1 Max			
Khata No.	Plot No.	Out of area.	
		A	D
336	5973	-	04 de. only
Total area		- 04 de.	

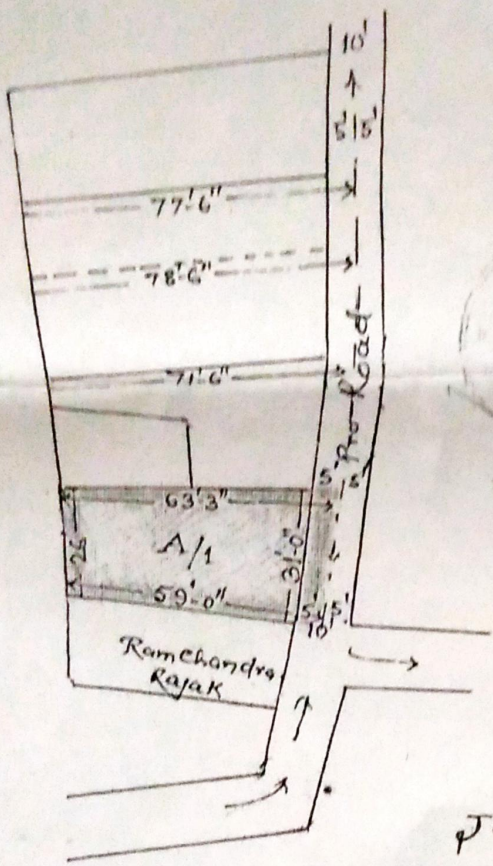

Vendor: -> Gyanti Devi
 w/o Sri Ram Darshan Sah -
 Add - Sec 1-c Vikash Nagar
 Jhopri patti, B.S. city Borara.

Vendee: - Smt Sunita w/o Sri
 Yogendra Singh - Add -
 Sec 2-c B.No.2-052 Street-5
 B.S. city Dist-Borara.

ग्यांती देवी

20/12

True copy
 traced by
 Atlas
 Chas

Sunita