

A part plan of Mouza - chas. Thana NO - 30.
 Pargana - Khaspel. P.S - chas. Dist - Bokaro.
 Scale - 16" inch = 1 mile

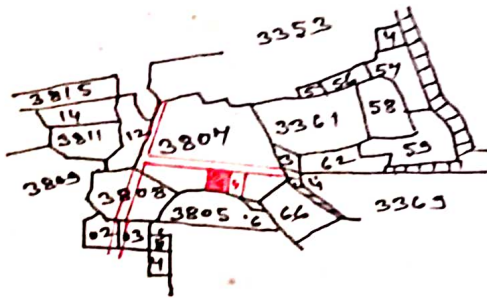

Schedule of Land - D/6			
Khata No	Plot No	Area	
		A.	Deei
476	3807	-	05

Vendar: - Sri Fatik Chandra Mahto
 Sotate Durga Das Mahto
 of - Chas. Tal. Sakagdih
 P.O. + P.S. Chas. Dist. Bokaro

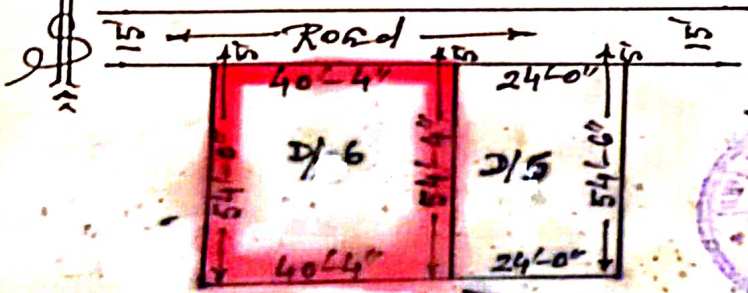

Vendee: - Smti Asha Devi
 W/o Sri Shrawan Kumar Thakur
 of - Sec - IX Street 14
 B. NO - 733, P.O. Sec - IX
 P.S. Hasla Dist Bokaro

Boundary: -
 North: - 15'-0" wide Rasta
 South: - Survey Plot No - 3805
 East: - Smti. Punam Devi
 West: - Part Plot No - 3807

NO:- Details of area Schedule D/3 demarketed with red line with red colour in this map.

True copy
 Traceed by
 (Signature)
 Chas. Bokaro.