

A Part Plan of Mouza Chas Sheet No-1
 Thana Chas No 30 Pargona Khaspel
 Dist Bokaro Scale 1" = 330'

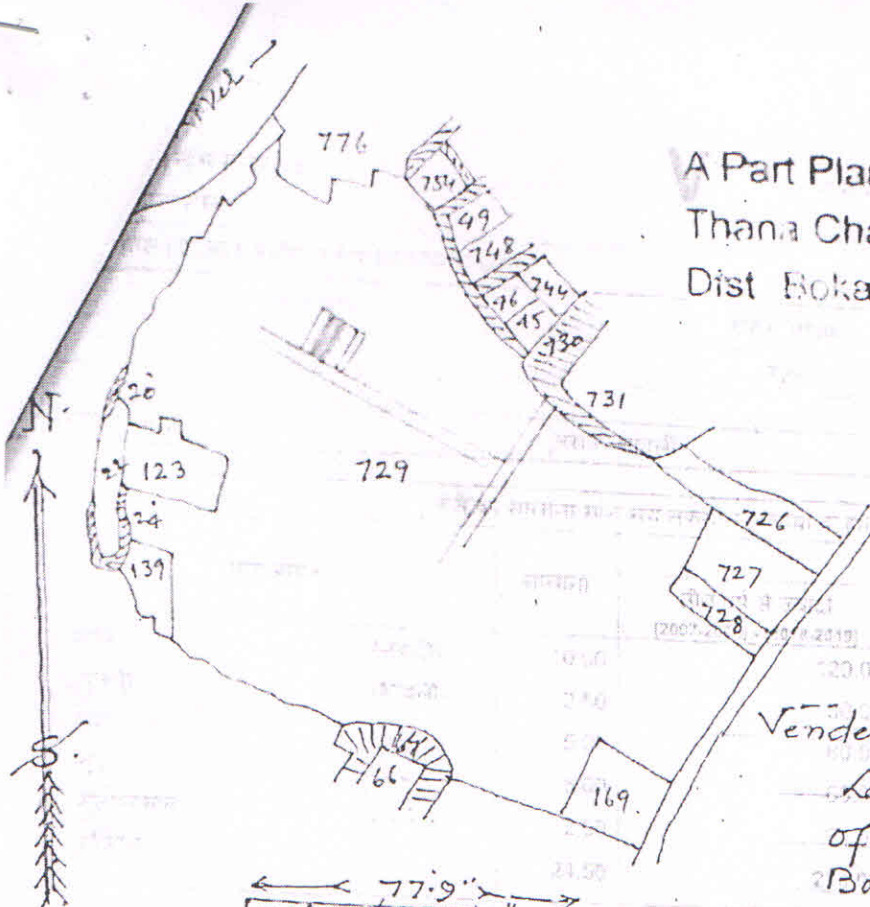

Schedule of Land A ₂			
Khata No.	Prote No	Out of Area	
		A	Dec.
307	729	-	5.082
Total Area :-			5.082

Dec only.

Vender:- Pramila Jha. w/o
 Late Ashok Kumar Jha
 of & No-1023 Sec 4C
 Bokaro Steel City (Bokaro)

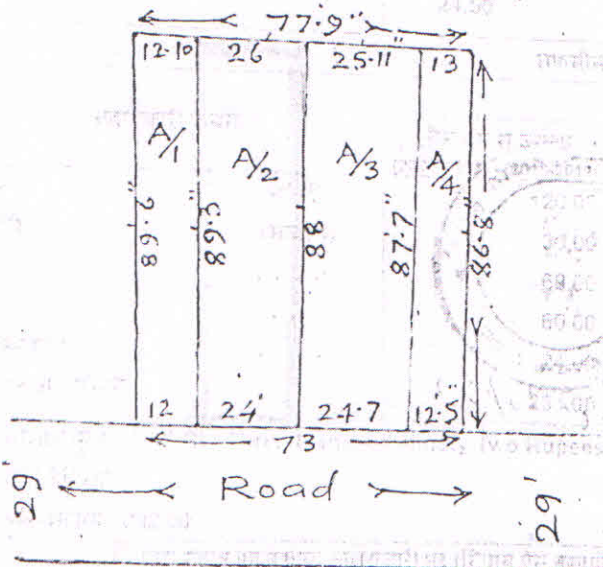

Vendee:- Sri Sanjay Kumar. S/o
 Late Braj Kishore Kumar
 of plot no-729 Chira Chas
 P.O + P.S - Chas, Dist - Bokaro

For sale to
 B. Kumar & Co

For KISHAN CONSTRUCTION

Kishan
 Proprietor

NB:- Details of Area Schedule - Dimar Cated
 With Red Line With Red Colour In This Map

7/10/20
 Submitted to
 District
 Panchayat