

SITE PLAN

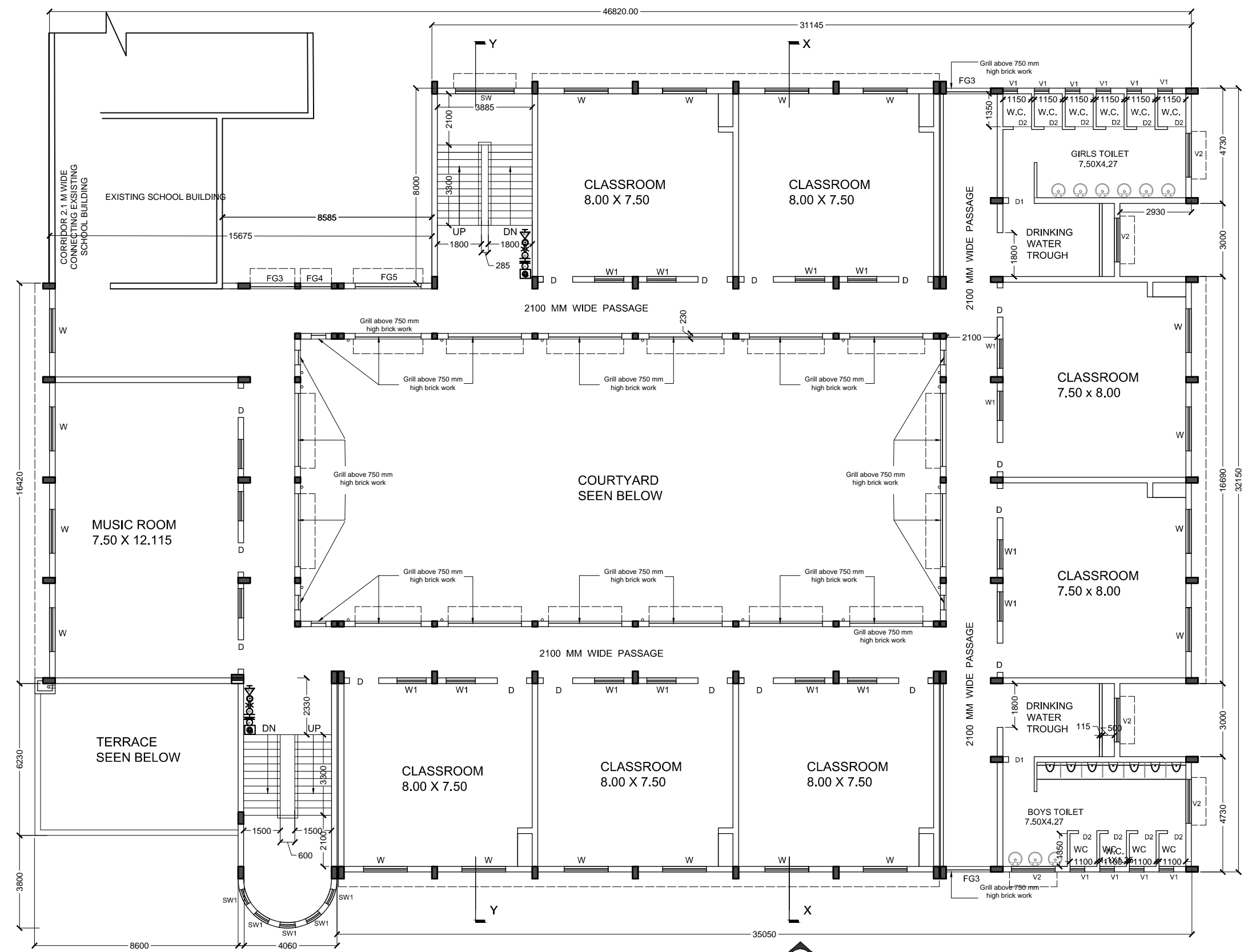



ELEVATION - A



Proposed First Floor Plan  
SCALE 1:100

Schedule of openings :-

S.No.	Type	Size	Sill lvl from respective floor lvl	Lintel lvl
1.	D	1.20 X 2.10	+0.00	+2.10
2.	D1	1.05 X 2.10	+0.00	+2.10
3.	D2	0.75 X 2.10	+0.00	+2.10
4.	W	2.40 X 1.50	+0.90	+2.10
5.	W1	1.20 X 1.50	+0.90	+2.10
6.	V1	0.60 X 0.60	+1.50	+2.10
7.	V2	1.80 X 0.60	+1.50	+2.10
8.	SW1	0.60 X 1.35	+0.75	+2.10
9.	SW	2.40 X 1.35	+0.75	+2.10

- GENERAL SPECIFICATION**
- FOUNDATION: R.C.C COLUMN FOUNDATIONS
  - SUPERSTRUCTURE: R.C.C FRAME STRUCTURE.
  - ROOF AND INTERMEDIATE SLABS: 115MM TH. R.C.C SLAB.
  - FLOORING: KOTA/ TILES ABOVE R.C.C SLAB
  - WALLS: EXTERNAL : 230 TH BRICK WALL WITH PLASTER  
INTERNAL : 230/ 115 THK BRICK WALL WITH PLASTER.
  - TOILET: IWC & EWG WITH FIRST CLASS FITTINGS.

SIGNATURE OF SPECIAL OFFICER, J.N.A.C.

SIGNATURE OF HEAD, LAND & MARKETS, TATA STEEL

SIGNATURE OF EIC. (DE & TP)

Proposed First & Second Floor of New Building for JUSCO School South Park, Bistupur on New Plot no. 870(p), 871(p), 872, 873, 874, 875(p), 876, 877, 878,879,880,980 & 981 of Ward no. 4 , Khata no.2 Jamshedpur Notified Area Committee  
This piece of land appears in Appendix 'C' of the Indenture of Renewed Lease dated : 20.08.2005

OWNER:	<b>TATA STEEL LIMITED</b> JAMSHEDPUR		
CONSULTANTS:	<b>JUSCO</b> PLANNING ENGINEERING & CONSTRUCTION SANKHIBHOLLYARD ROAD, NORTHERN TOWN, JAMSHEDPUR, JHARKHAND - 83101		
DRAWN:	M.Dutta	SCALE: 1 : 100	DATE: 28/05/2016
CHECKED:	A.Balmuchu	SUBJECT: First floor plan & Elevation A	
MANAGER (P):	J.Singh	DWG. No.: TPE/17794	
EIC (D.E&T.P):	J.Singh	REVISION:	
GM (EPC)	P.Sinha		

REVISION	DATE	DESCRIPTION	DRN.	CHKD.	MGR(D)	CHIEF(Arch.)	DRG. NO.	DESCRIPTION
A	27.06.2016		S.J	A.B	M.D	J.SINGH		



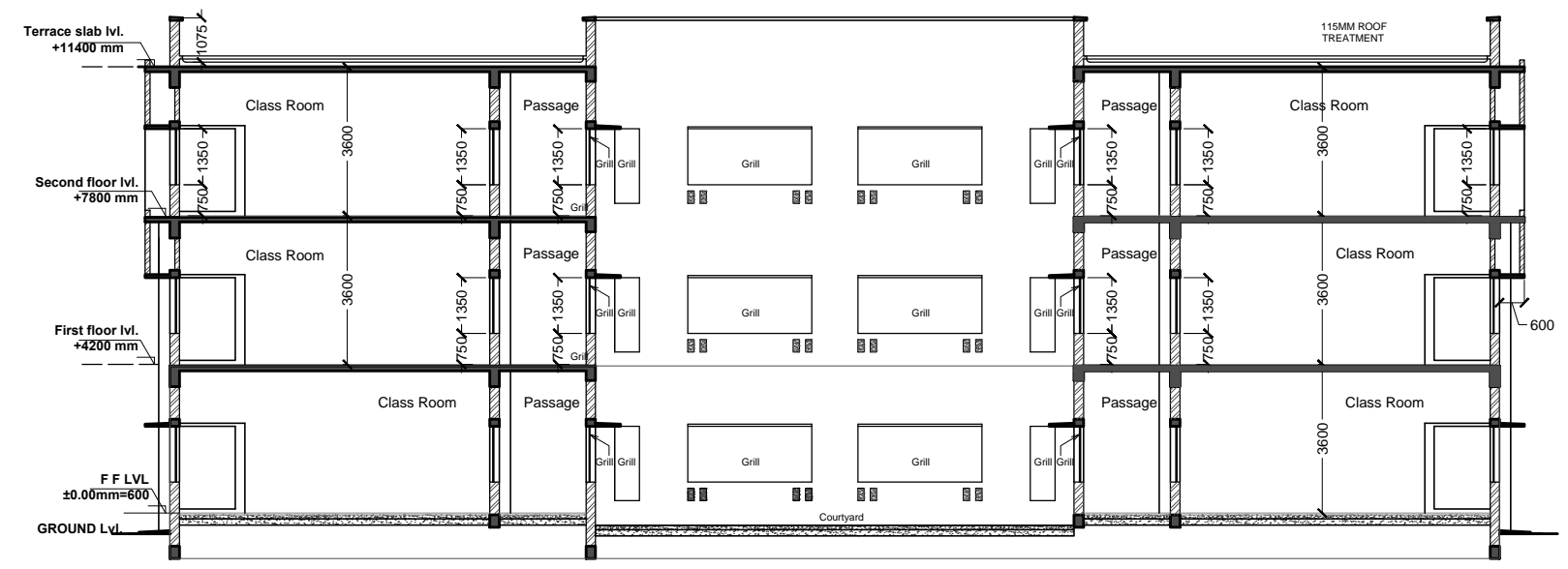

SECTION XX

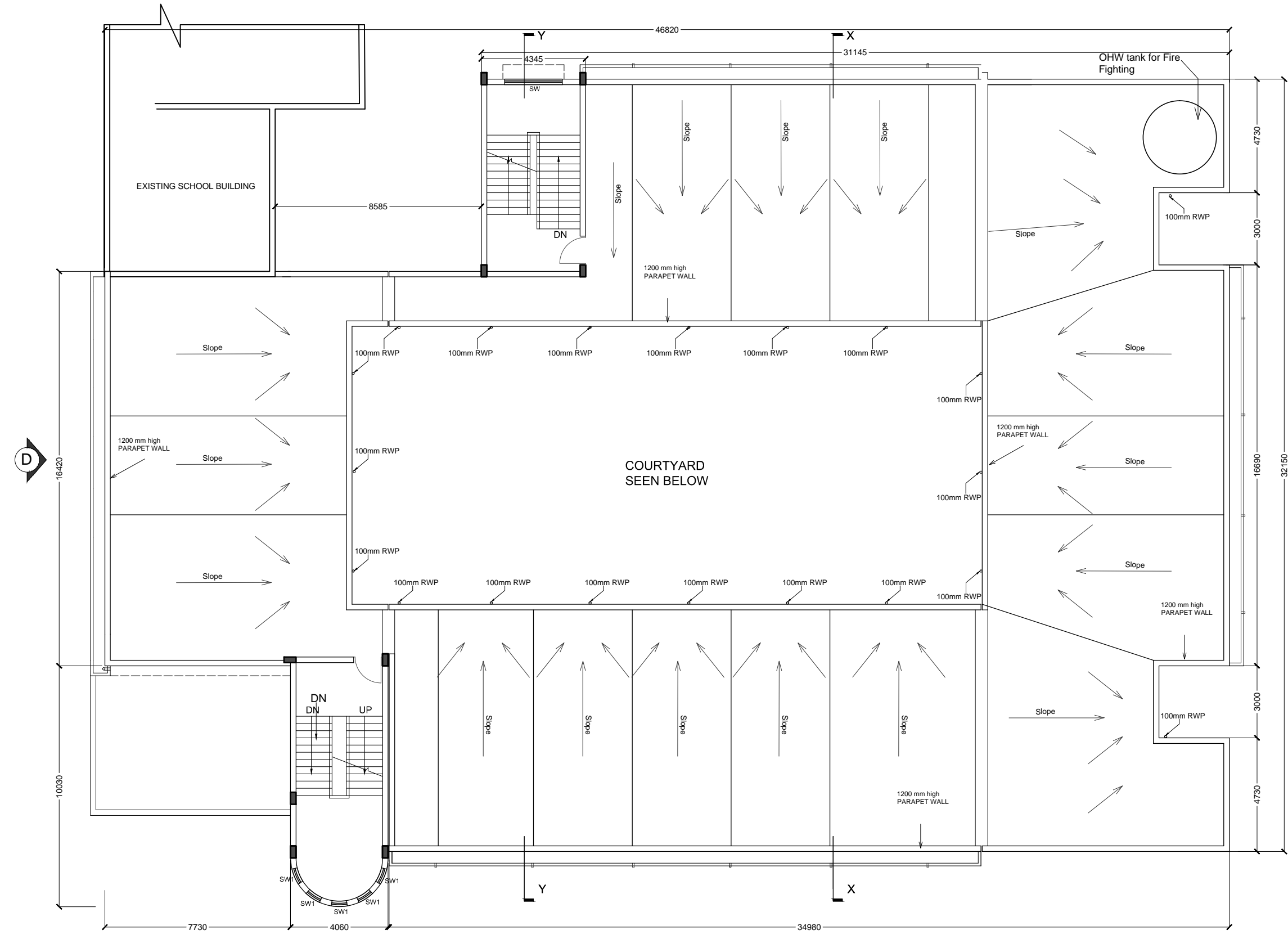

Proposed Roof Plan  
SCALE 1:100

Schedule of openings :-

S.No.	Type	Size	Sill lvl from respective floor lvl	Lintel lvl
1.	D	1.20 X 2.10	+0.00	+2.10
2.	D1	1.05 X 2.10	+0.00	+2.10
3.	D2	0.75 X 2.10	+0.00	+2.10
4.	W	2.40 X 1.50	+0.90	+2.10
5.	W1	1.20 X 1.50	+0.90	+2.10
6.	V1	0.60 X 0.60	+1.50	+2.10
7.	V2	1.80 X 0.60	+1.50	+2.10
8.	SW1	0.60 X 1.35	+0.75	+2.10
9.	SW	2.40 X 1.35	+0.75	+2.10

SIGNATURE OF SPECIAL OFFICER, J.N.A.C.

SIGNATURE OF HEAD, LAND & MARKETS, TATA STEEL

SIGNATURE OF EIC. (DE & TP)

Proposed First & Second Floor of New Building for JUSCO School South Park, Bistupur on New Plot no. 870(p), 871(p), 872, 873, 874, 875(p), 876, 877, 878, 879, 880, 980 & 981 of Ward no. 4, Khata no.2 Jamshedpur Notified Area Committee  
This piece of land appears in Appendix 'C' of the Indenture of Renewed Lease dated : 20.08.2005

OWNER:	<b>TATA STEEL LIMITED JAMSHEDPUR</b>		
CONSULTANTS:	<b>JUSCO PLANNING ENGINEERING &amp; CONSTRUCTION</b> SACHBI BOULEVARD ROAD, NORTHERN TOWN, JAMSHEDPUR, JHARKHAND - 83101		
DRAWN:	M.Dutta	SCALE: 1 : 100	DATE: 28/05/2016
CHECKED:	A.Balmuchu	SUBJECT: Roof Plan & Section XX	
MANAGER (P):	S.Jaiswal		
EIC (D.E&T.P):	J.Singh	DWG. No.: TPE/17796	
GM (EPC):	P.Sinha	REVISION:	5 of 5

REVISION	DATE	DESCRIPTION	DRN.	CHKD.	MGR(D)	CHIEF(Arch.)
A	27.06.2016		S.J	A.B	M.D	J.SINGH

REFERENCES	DESCRIPTION
DRG. NO.	

NOTES