

12.20M WIDE ROAD

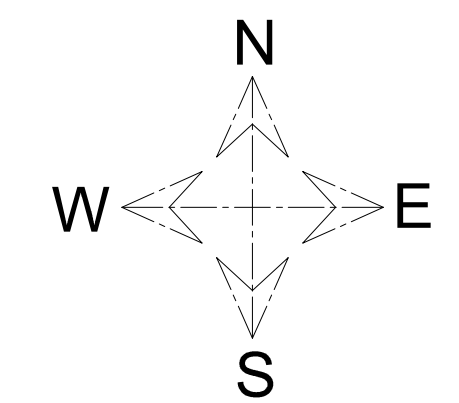
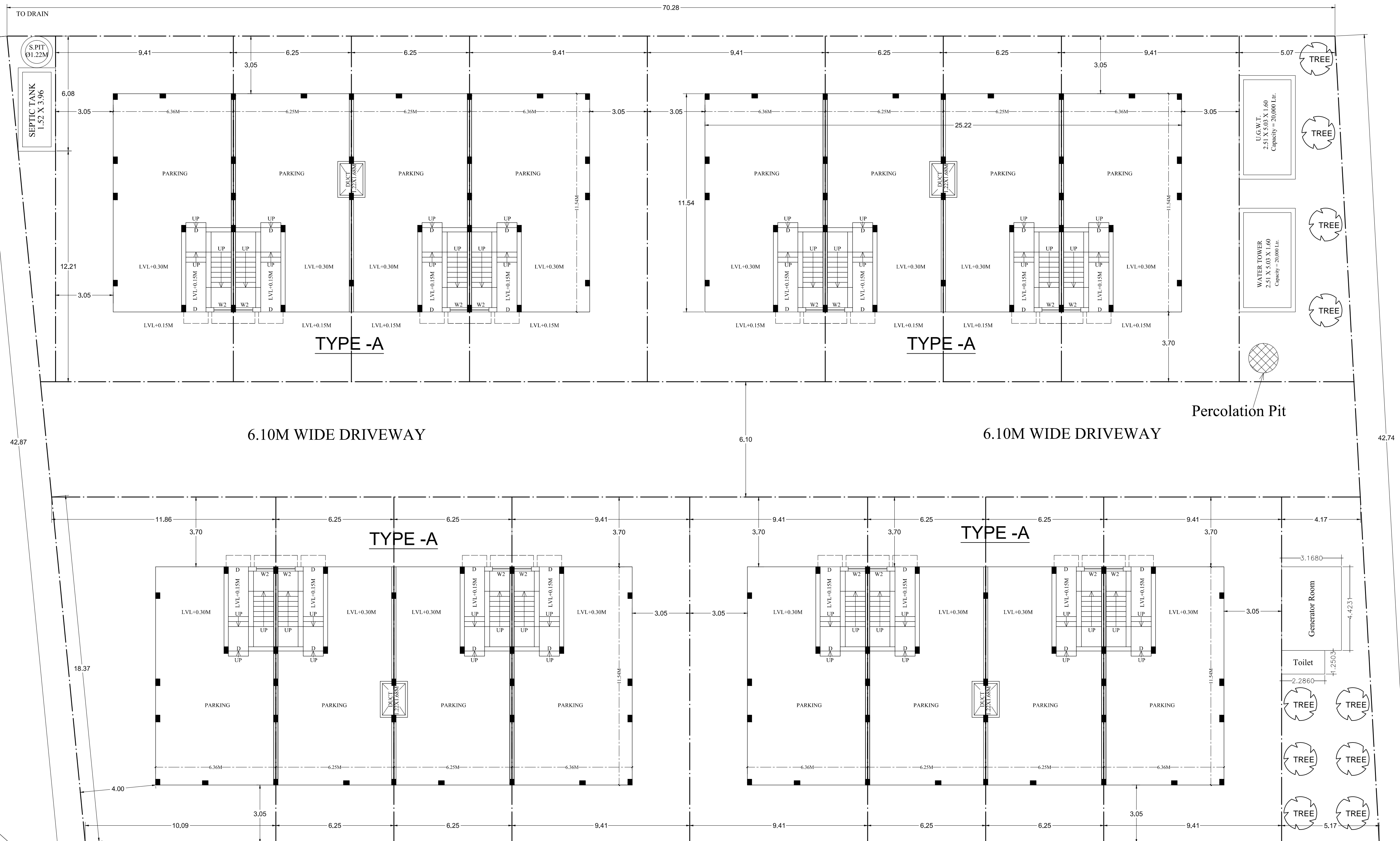

GENERAL SPECIFICATION :-
 FOUNDATION : PLAIN CEMENT CONCRETE AS PER DESIGN.
 : R.C.C. COLUMN FOOTING & COLUMN AS PER STRUCTURAL DESIGN.
 SUPER STRUCTRE : R.C.C. COLUMN AND BEAM AS PER STRUCTURAL DESIGN.
 : 0.23m THK. EXTERNAL WALL & 0.11m THK. PARTITION WALL.
 : IN CEMENT MORTAR.
 : R.C.C. ROOF SLAB AS PER STRUCTURAL DESIGN.
 DOORS & WINDOW: AS PER SCHEDULE.
 NOTE : COLUMN LAYOUT AND OPENING MAY CHANGE AS PER WORKING

PROPOSED HOUSING PROJECT FOR- M/S KEDARNA BUILDERS
PROJECT NAME:- EMERALD VILLAS

NEW PLOT NO.	R.S. PLOT NO.	NEW KHATA NO.	R.S. KHATA NO.
656(P)	4604(P)	16	13
658(P)	4598(P)	16	13
673	4603(P)	47	12
674(P)	4602(P)	17	9

VILLAGE: MOHARDA
 SURVEY WARD NO. 17 J. N. A. C.
 P. S. BIRSANAGAR, THANA NO. 1200
 BARIDIH, JAMSHEDPUR

SCALE - 1 : 100
 SHEET NO. - 01/04
SHEET CONTENTS:
 SITE PLAN & AREA CALCULATION

SIGN. OF ARCHITECT/ENGINEER
 SIGNATURE OF DEVELOPER
 SPECIAL OFFICER J.N.A.C APPROVED

SITE PLAN

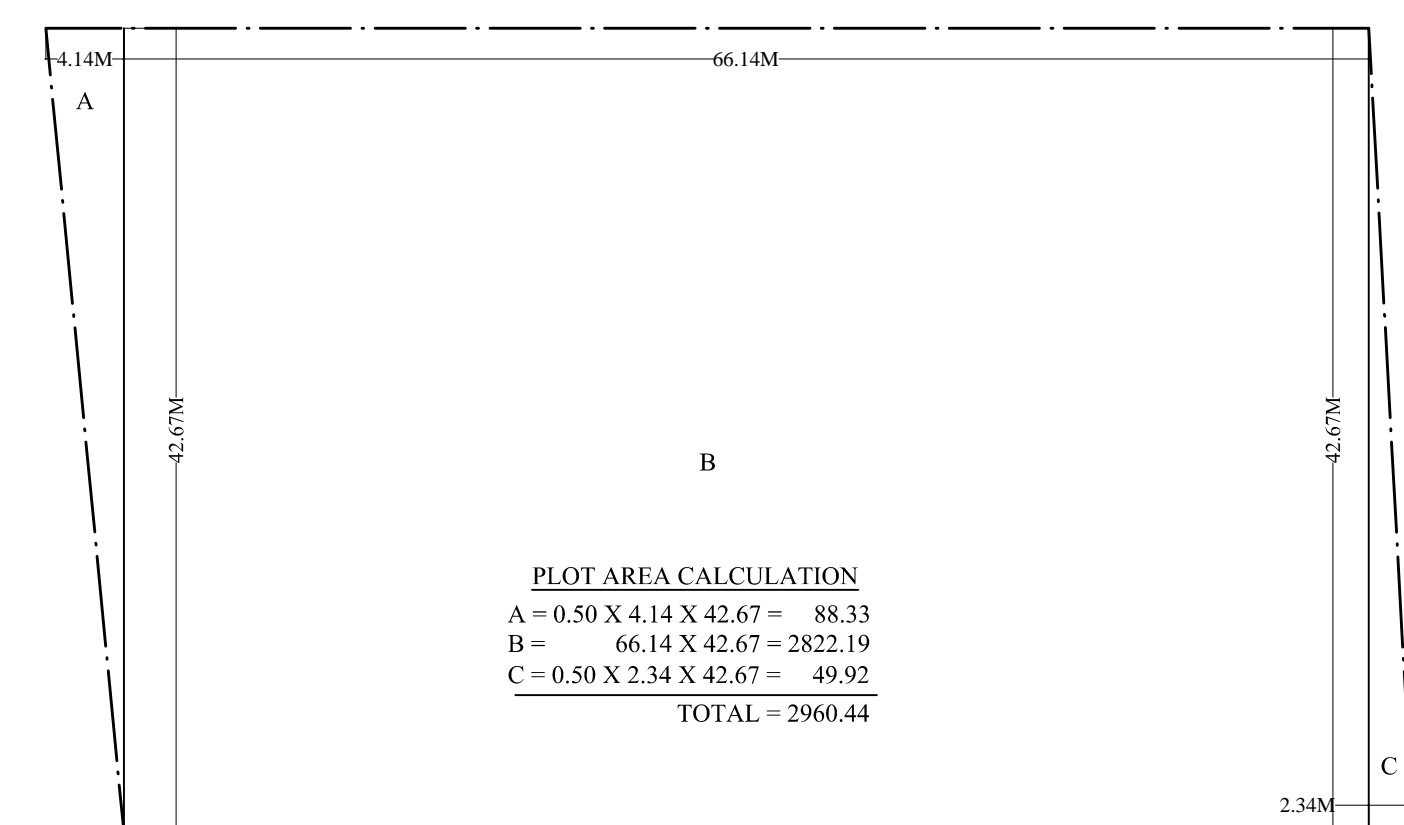

AREA CALCULATION
 PLOT AREA = 2960.44 SQ.MT.
 TYPE "A" AREA = 2465.52 SQ.MT.
 TOTAL BUILTUP AREA = 2465.52 SQ.MT.
 F.A.R. = 2465.52 / 2960.44 = 0.83
 TOTAL COVERED AREA = 1164.16 SQ.MT.
 COVERAGE = 1164.16 X 100 / 2960.44 = 39.22%

