

FORM - 0

No	Particulars	Qty	Unit	Total		Remarks
				Area	Volume	
1	Concrete	100.00	m <sup>3</sup>	100.00		
2	Reinforcement	100.00	kg			
3	Brickwork	100.00	m <sup>3</sup>	100.00		
4	Plaster	100.00	m <sup>2</sup>	100.00		
5	Paint	100.00	liters	100.00		
6	Roofing	100.00	m <sup>2</sup>	100.00		
7	Electrical	100.00	kg			
8	Sanitary	100.00	kg			
9	Water	100.00	kg			
10	Other	100.00	kg			
11	Subtotal			100.00		
12	Grand Total			100.00		

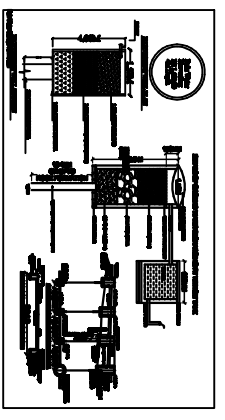
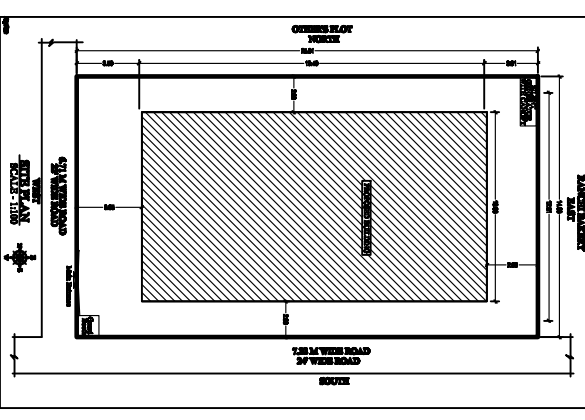
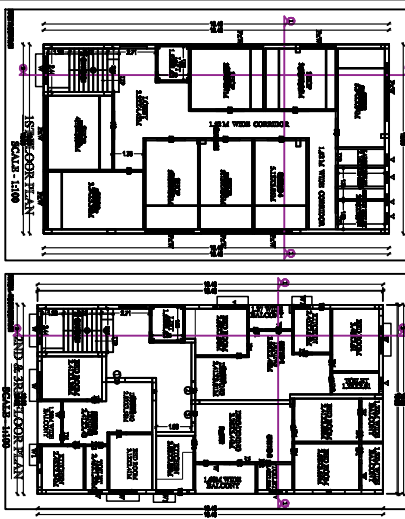
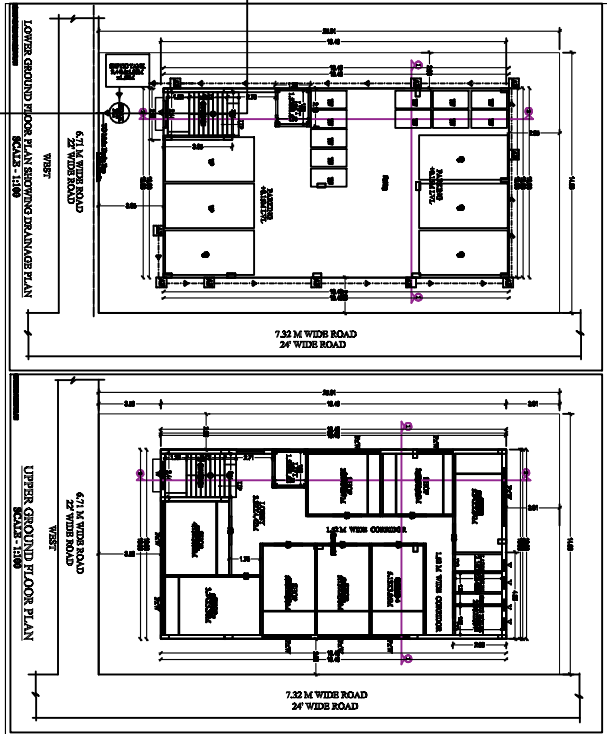

**GENERAL NOTES:**

1. ALL DIMENSIONS ARE IN METERS UNLESS OTHERWISE SPECIFIED.
2. REFER TO THE ARCHITECT'S DRAWINGS FOR MATERIAL SPECIFICATIONS.
3. THE CONTRACTOR SHALL BE RESPONSIBLE FOR OBTAINING ALL NECESSARY PERMITS AND APPROVALS.
4. THE CONTRACTOR SHALL MAINTAIN ACCESS TO ALL ADJACENT PROPERTIES AT ALL TIMES.
5. ALL WORK SHALL BE COMPLETED WITHIN THE SPECIFIED TIME FRAME.
6. THE CONTRACTOR SHALL BE RESPONSIBLE FOR THE PROTECTION OF ALL EXISTING UTILITIES AND STRUCTURES.
7. ALL MATERIALS AND WORKMANSHIP SHALL BE SUBJECT TO INSPECTION AND APPROVAL BY THE ARCHITECT.
8. THE CONTRACTOR SHALL MAINTAIN A NEAT AND ORDERLY WORK SITE AT ALL TIMES.
9. ALL WASTE SHALL BE PROPERLY DISPOSED OF AT THE END OF EACH DAY.
10. THE CONTRACTOR SHALL BE RESPONSIBLE FOR THE SAFETY OF ALL WORKERS AND THE PUBLIC.

**PLANNING:**

PLANNING: AS AMAC

**RESOURCES:**

RESOURCES: AS AMAC

**DATE:** 1/1

No	Description	Qty	Unit	Total
1	Concrete	100.00	m <sup>3</sup>	100.00
2	Reinforcement	100.00	kg	
3	Brickwork	100.00	m <sup>3</sup>	100.00
4	Plaster	100.00	m <sup>2</sup>	100.00
5	Paint	100.00	liters	100.00
6	Roofing	100.00	m <sup>2</sup>	100.00
7	Electrical	100.00	kg	
8	Sanitary	100.00	kg	
9	Water	100.00	kg	
10	Other	100.00	kg	
11	Subtotal			100.00
12	Grand Total			100.00

No	Description	Qty	Unit	Total
1	Concrete	100.00	m <sup>3</sup>	100.00
2	Reinforcement	100.00	kg	
3	Brickwork	100.00	m <sup>3</sup>	100.00
4	Plaster	100.00	m <sup>2</sup>	100.00
5	Paint	100.00	liters	100.00
6	Roofing	100.00	m <sup>2</sup>	100.00
7	Electrical	100.00	kg	
8	Sanitary	100.00	kg	
9	Water	100.00	kg	
10	Other	100.00	kg	
11	Subtotal			100.00
12	Grand Total			100.00