

Particulars	Existing	Proposed	Total
Plot Area	88.80 M Sq.	—	88.80 M Sq.
Covered Area	—	89.30 M Sq.	89.30 M Sq.
(a) Permitted (Permitted)	—	89.30 M Sq.	89.30 M Sq.
(b) Ground Floor	—	89.30 M Sq.	89.30 M Sq.
(c) 1st Floor	—	89.30 M Sq.	89.30 M Sq.
(d) 2nd Floor	—	89.30 M Sq.	89.30 M Sq.
TOTAL	88.80 M Sq.	177.90 M Sq.	177.90 M Sq.
% Ground Coverage	89.30 M Sq. - X-100 = 80.14%	—	—
F.A.R. - 86.80 M Sq. - 1.8 (Max Permissible FAR)	—	—	—

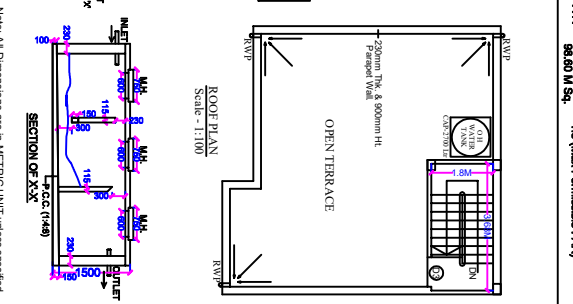

- WATER CONSUMPTION DATA**
1. No of Floors = 3
  2. No of Persons = 3 X 8 = 18
  3. Consumption/Person = 48 Litres/Day
  4. TOTAL Consumption = 2250 L/Day
  5. No of Office/Person = 1 Nos.
  6. Each Off Size = 1.5 X 1.5 X 1.2 M = 27 Q.M
  7. Tank Size = 0.8 X 2.0 X 1.5 M = 4800 Ltr.
- SEPTIC TANK DATA**
1. No of Floors = 3
  2. No of Persons = 3 X 8 = 18
  3. Consumption/Person = 48 Litres/Day
  4. PER DAY CAPACITY = 675.0 L/Day
  5. SOLID WASTE QUANTITY = 180.0 Ltr. ON 1.25 CM
  6. TOTAL CAPACITY = 150.0 Ltr. ON 1.25 CM
  7. TANK SIZE = 0.8 X 2.0 X 1.5 M = 4800 Ltr.

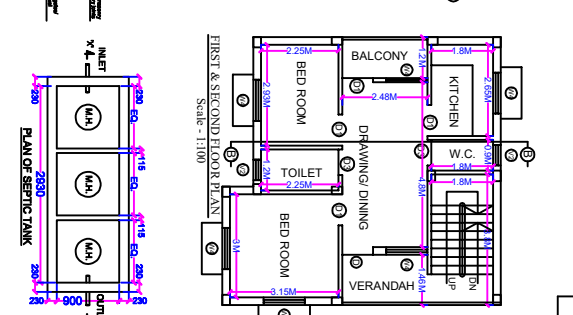
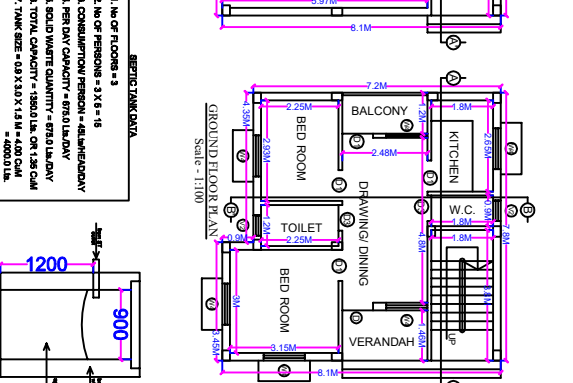
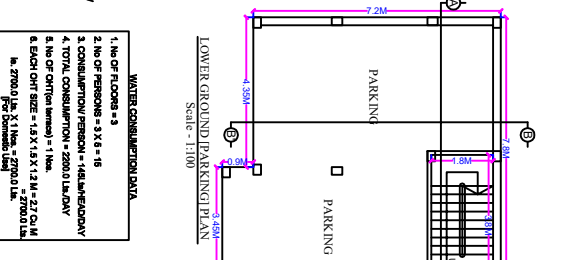
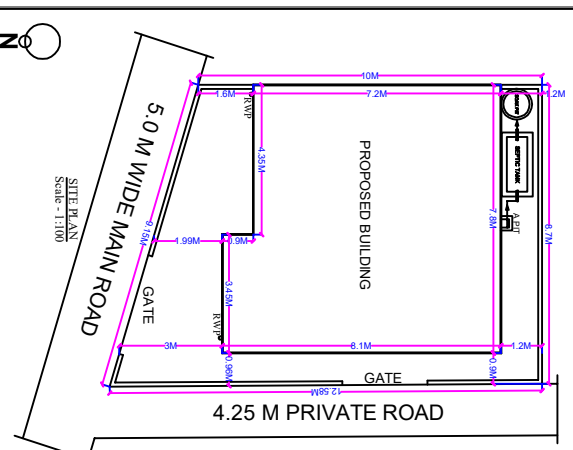
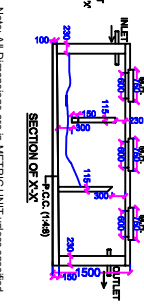
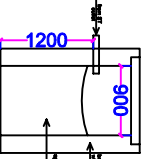

CLIENT  
PROPOSED RESIDENTIAL BUILDING OF Mrs. RUMA DEVI; w/o PRAMOD KUMAR,  
ON NEW PLOT No - 3468PJ; NEW KHATA No - 294; Mouza - Mango; PS Mango; Thana No - 1642;  
WARD No - 10 (MNA.C); JAMSHEDPUR, EAST SINGHBHUM. [Holding No - 0100001363000M0]

SIGNATURE  
OWNER/ POA/ LEASEE  
SPL. OFFICER M.N.A.C.  
APPROVED

**ARCHITECTS:**  
NEMISH K UDANI  
Reg. No. : ARCC/002/2019  
PH: 09534826154

**OTHER SPECIFICATION**

FOUNDATION :- RCC FOOTING AND COLUMN AS PER STRUCTURAL DESIGN.

SUPER STRUCTURE :- GOOD QUALITY BRICKS IN 1.6 CM IN 9" THK. WALLS & IN 1.4 CM PROVIDING CHICKEN WIRE MESH AT EVERY 3rd OR 4th LAYER IN 4.5" THK. WALLS AS PER DESIGN.

FLOORING :- USER DESIRED FLOORING OVER 4.5" THK. PCC (1:4:8) OR 4.5" THK. RCC (1:1.5:3).

ROOF :- 4.5" THK. R.C.C SLAB (1.5:3) WITH USER DESIRED CHEMICAL TREATMENT ON INTERNAL WALLS.

PLASTERING :- 1/2" THK. CEMENT MORTAR PLASTER PROVIDED ON BOTH EXTERNAL & INTERNAL WALLS.

DOORS :- D2=36"x70" D1=30"x70" D2=2'9"x7'0" D3=2'2"x7'0"

WINDOWS :- W5=5'0"x4'0" W4=4'0"x4'0" W3=3'6"x4'0" S/W=4'6"x16" (as per section)

VENTILATORS :- V3=9'0"x2'0" V2=2'0"x1'6" V1=1'6"x1'6"

TOILET :- L.W./E.W.C WITH P.V.C SYSTEM AND ALL PIPES & FITTINGS SHALL BE OF GI MAKE.

TANK :- PROVIDED WITH FIRST CLASS SYNTHETIC OVER HEAD WATER TANK.

Note: All Dimensions are in METRIC UNIT unless specified.

DATE: 24-05-2020