

GENERAL SPECIFICATION :-

FOUNDATION : PLAIN CEMENT CONCRETE AS PER DESIGN.
: R.C.C. COLUMN FOOTING & COLUMN AS PER STRUCTURAL DESIGN.

SUPER STRUCTURE : R.C.C. COLUMN AND BEAM AS PER STRUCTURAL DESIGN.
: 0.23M THK. EXTERNAL WALL & 0.11M THK. PARTITION WALL.
: IN CEMENT MORTAR.
: R.C.C. ROOF SLAB AS PER STRUCTURAL DESIGN.
: I.P.S. FLOORING ON P.C.C. BED ALL OVER FLOOR.

INTERNAL FINISH : WHITE WASHING OVER CEMENT PLASTER

SANITARY : VITRIOUS CHAINA SANITARY WARE
: G.I. PIPE WATER SUPPLY.
: C.I. PIPE FOR DISPOSAL.

DOORS & WINDOWS : AS PER SCHEDULE.

ELECTRICAL : COPPER CONDUCTOR WITH P.V.C. CONDUIT.

PROPOSED RESIDENTIAL BUILDING FOR :

Mrs. LALITA KUMARI

PLOT NO. : 1579 (b)

KHATA NO. : 384

THANA : M.G.M. THANA

THANA NO. : 1150

HALKA NO. : I

MAUZA : BALIGUMA

P.S. : MANGO

DISTRICT : EAST SINGHBHUM

ALL FLOOR PLANS, SECTION, ELEVATION, SITE PLAN, MAUZA MAP,

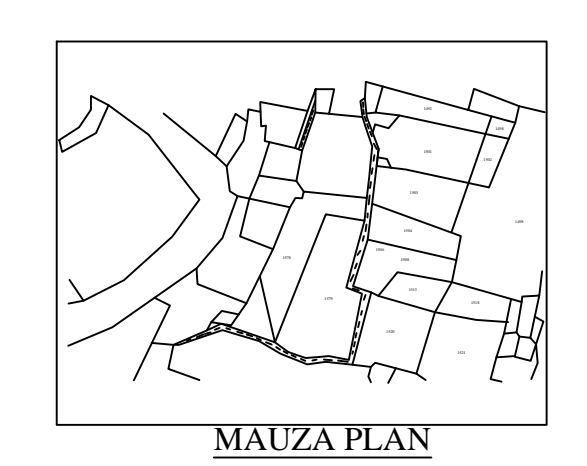
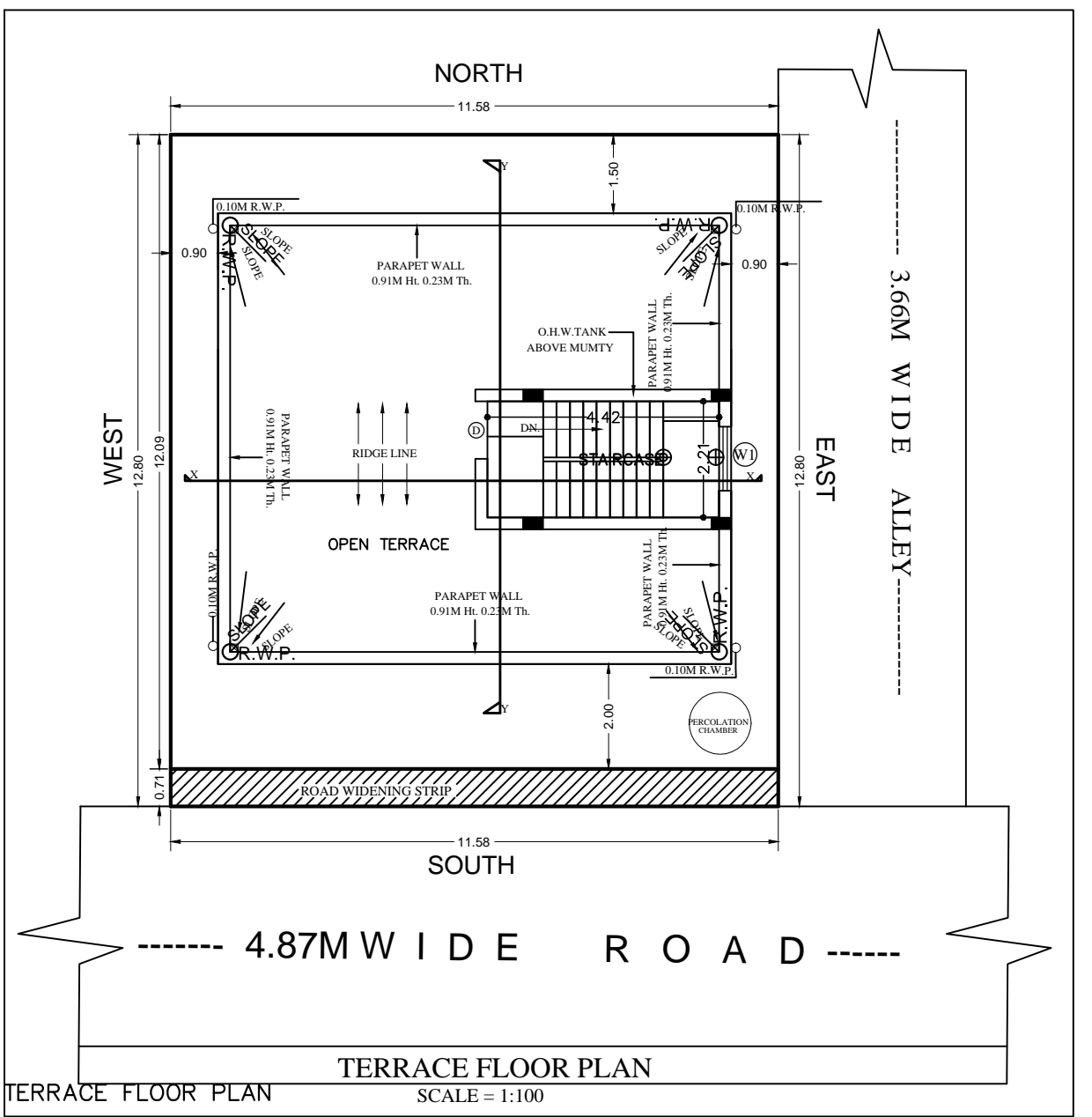
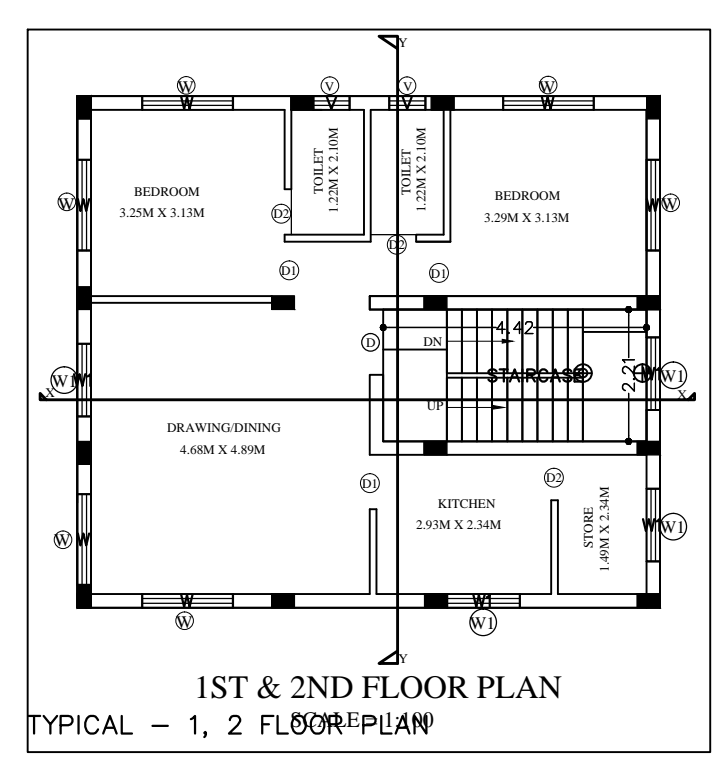
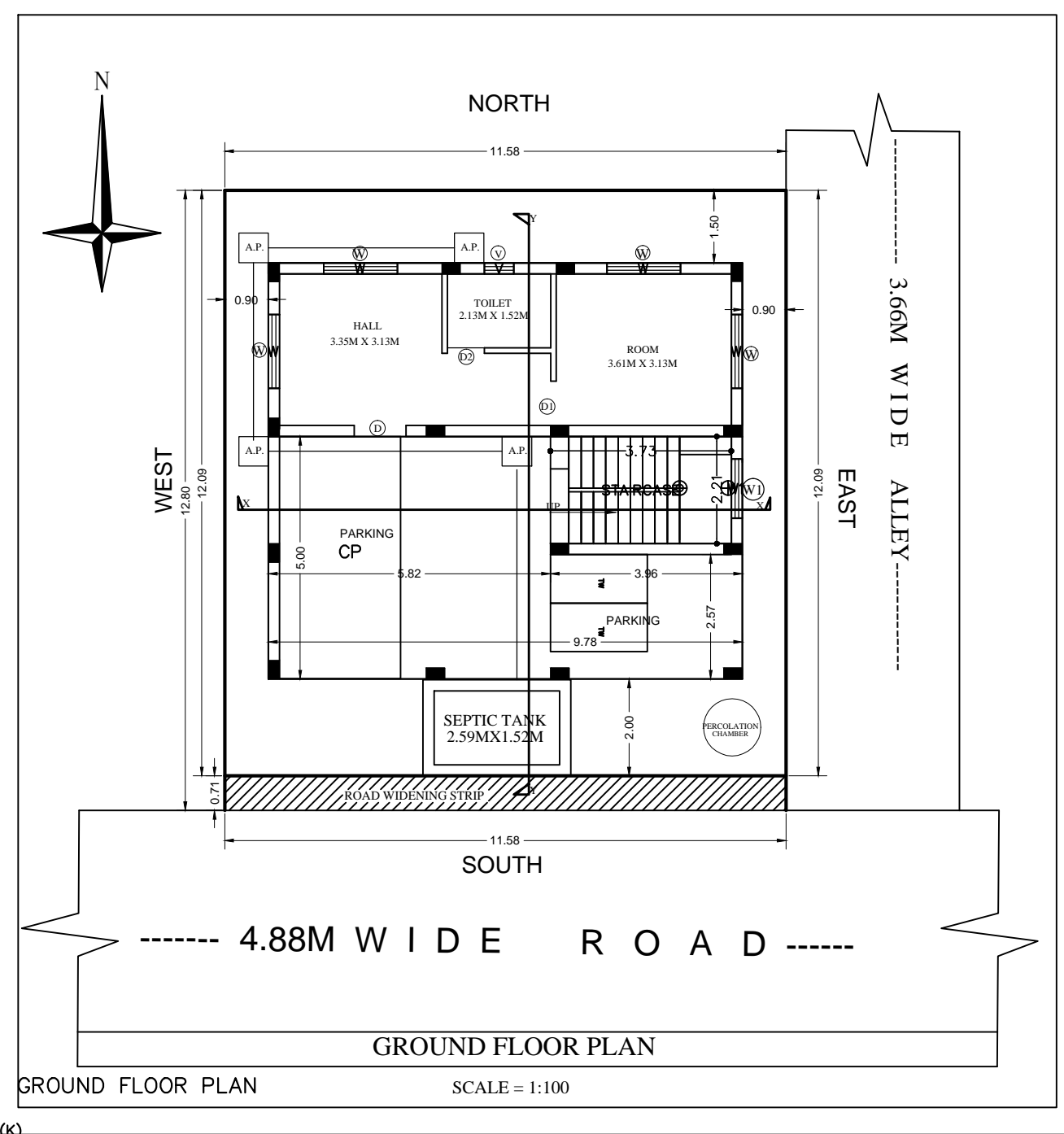
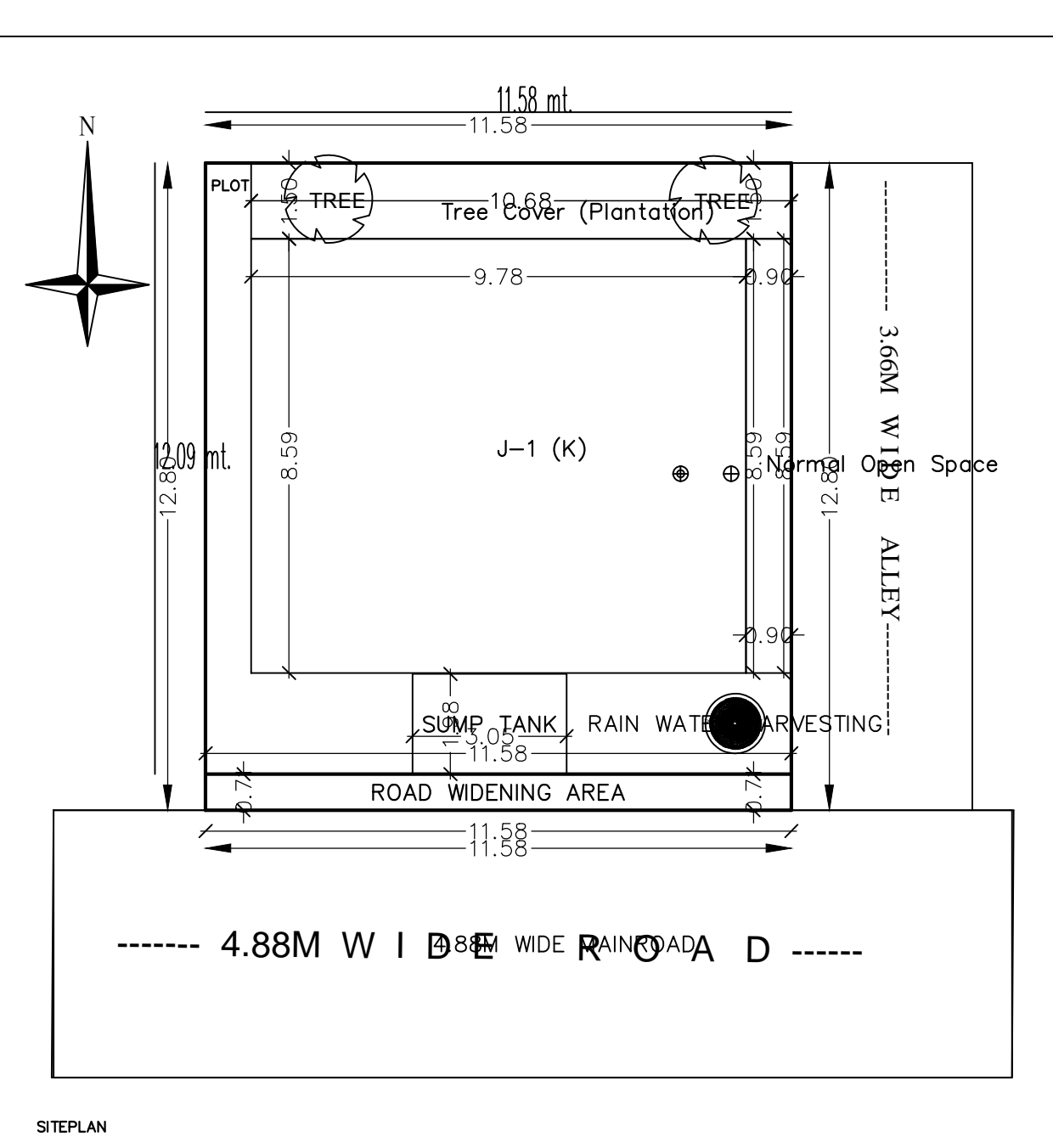

AREA CALCULATION :-

PLOT AREA	= 148.27 SQMT
COVERED AREA	= 84 SQMT
GROUND FLOOR AREA	= 84 SQMT
1st FLOOR AREA	= 84 SQMT
2nd FLOOR AREA	= 84 SQMT
TOTAL	= 252 SQMT
COVERAGE	= 84 X 100 / 148.27 = 56.65 %
F.A.R. ACHIEVED	= 252 / 148.27 = 1.69
OPEN SPACE	= 148.27 - 84 = 64.27 SQMT
CAR PARKING AREA	= 5.00 X 5.82 = 29.1 SQMT
SCOOTER PARKING AREA	= 3.95 X 2.57 = 10.15 SQMT

SCHEDULE OF OPENINGS

S.NO.	MKD.	SIZE	DESCRIPTION
1.	D	1 M X 2.13M	Pannelled single shutter door.
2.	DI	0.96 M X 2.13M	Pannelled single shutter door.
3.	D2	0.76 M X 2.13M	Pannelled single shutter door.
4.	W	1.52 M X 1.22 M	Glazed steel framed window 3. shutt.
5.	W1	1.22 M X 1.22 M	Glazed steel framed window 2. shutt.
6.	V	0.61M X 0.61M	Top hung steel ventilator.

1:100, 1:200 SHEET NO.- 1 OF 1

SIGNATURE OF ARCHITECT / ENGINEER

SIGNATURE OF OWNER

APPROVED AUTHORITY