

Project Title :PROJECT TITLE : MD YAKUB & ABDUL AZIZ

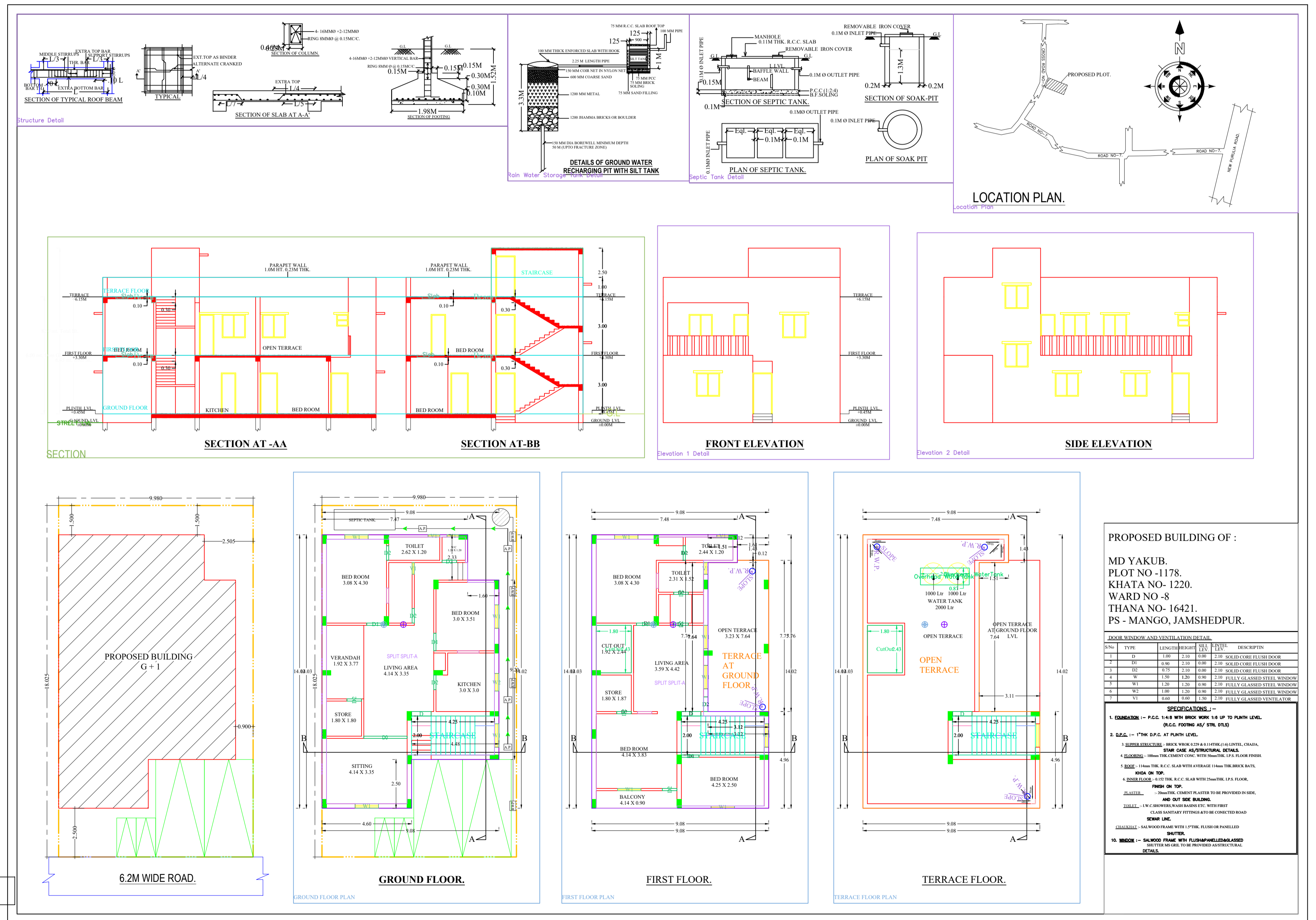

PROPOSED BUILDING OF :

MD YAKUB.
PLOT NO -1178.
KHATA NO- 1220.
WARD NO -8
THANA NO- 16421.
PS - MANGO, JAMSHEDPUR.

S/N	TYPE	LENGTH	HEIGHT	DESCRIPTION
1	D	1.00	2.10	2.10 SOLID CORE FLUSH DOOR
2	DD	0.90	2.10	2.10 SOLID CORE FLUSH DOOR
3	DD	0.75	2.10	2.10 SOLID CORE FLUSH DOOR
4	W	1.50	1.20	2.10 FULLY GLASSED STEEL WINDOW
5	W	1.50	1.20	2.10 FULLY GLASSED STEEL WINDOW
6	W	1.00	1.20	2.10 FULLY GLASSED STEEL WINDOW
7	V	0.60	0.90	2.10 FULLY GLASSED VENTILATOR

SECTIONALATIONS

- FOUNDATION :- R.C.C. 150x150 WITH BRICK WORK UP TO PLUMB LEVEL. (R.C.C. FOOTING AS STR. DLTS)
- D.E.C. :- 1"THK D.P.C. AT PLUMB LEVEL.
- SUPERSTRUCTURE :- BRICK WORK 230x230x1100MM (24) LINTEL, CHASSIS, STAIR CASE AS STRUCTURAL DETAILS.
- FLOORING :- 100mm THK CEMENT CONC. WITH 30mm THK L.P.S. FLOOR FINISH.
- ROOF :- 150mm THK R.C.C. SLAB WITH AVERAGE 150mm THK BRICK BATS.
- ROOF OR TOP FINISH ON TOP.
- INNER FLOOR :- 150 THK R.C.C. SLAB WITH 125mm THK L.P.S. FLOOR FINISH ON TOP.
- AND OUT SIDE BUILDING.
- WALLS :- 200mm THK CEMENT PLASTER TO BE PROVIDED IN SIDE.
- TOILET :- 150 C.BRICKWORK AS STRUCTURE WITH FIRST CLASS SANITARY FITTINGS TO BE CONNECTED ROAD SEWER LINE.
- CHASSIS :- 60x60 WOOD FRAME WITH 150THK FLUSH OR PANELED SHUTTER.
- WINDOW :- 60x60 WOOD FRAME WITH 150THK FLUSH OR PANELED SHUTTER AS PER TO BE PROVIDED ARCHITECTURAL DETAILS.

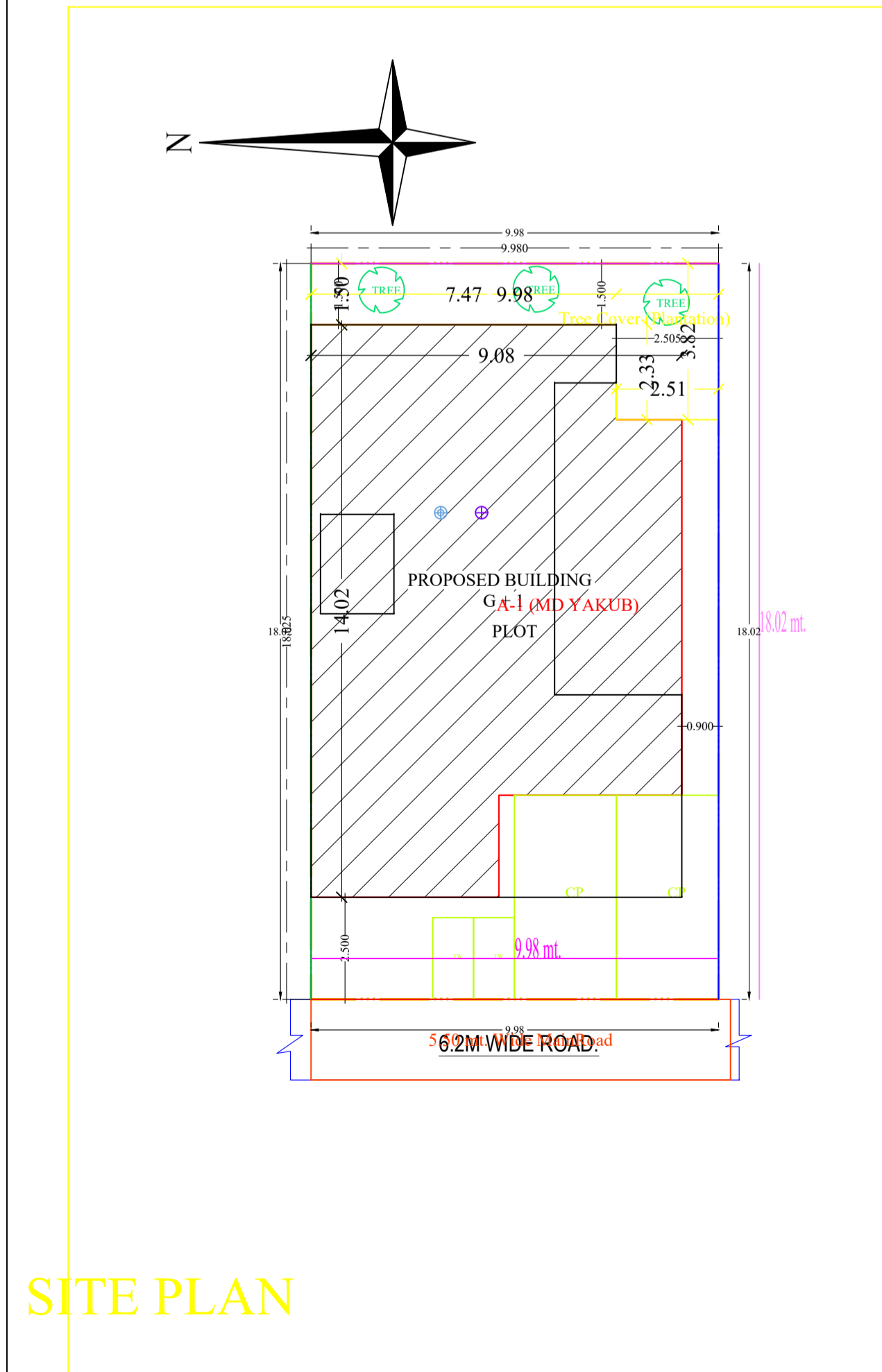

Building 'A' (MD YAKUB)

Floor Name	Gross Builtup Area	Deductions From Gross BUA/Area in Sq.mt.	Total Built Up Area (Sq.mt.)	Proposed FAR Area (Sq.mt.)	Total FAR Area (Sq.mt.)	Territ (No.)
Ground Floor...	112.42	0.00	112.42	112.42	112.42	01
First Floor...	101.26	4.38	96.88	96.88	96.88	00
Terrace Floor...	0.00	0.00	0.00	0.00	0.00	00
Total	213.68	4.38	209.30	209.30	209.30	01
Total Number of Same Buildings :						
Total	213.68	4.38	209.30	209.30	209.30	01