

CROSS ROAD 3.66M WIDE (NORTH)

PROPOSED AREA
61.75 SQM

FRONT ROAD 6.20M (WEST)
TOTAL ROAD LENGTH=90.0 M

SITE PLAN

SCALE 1:100

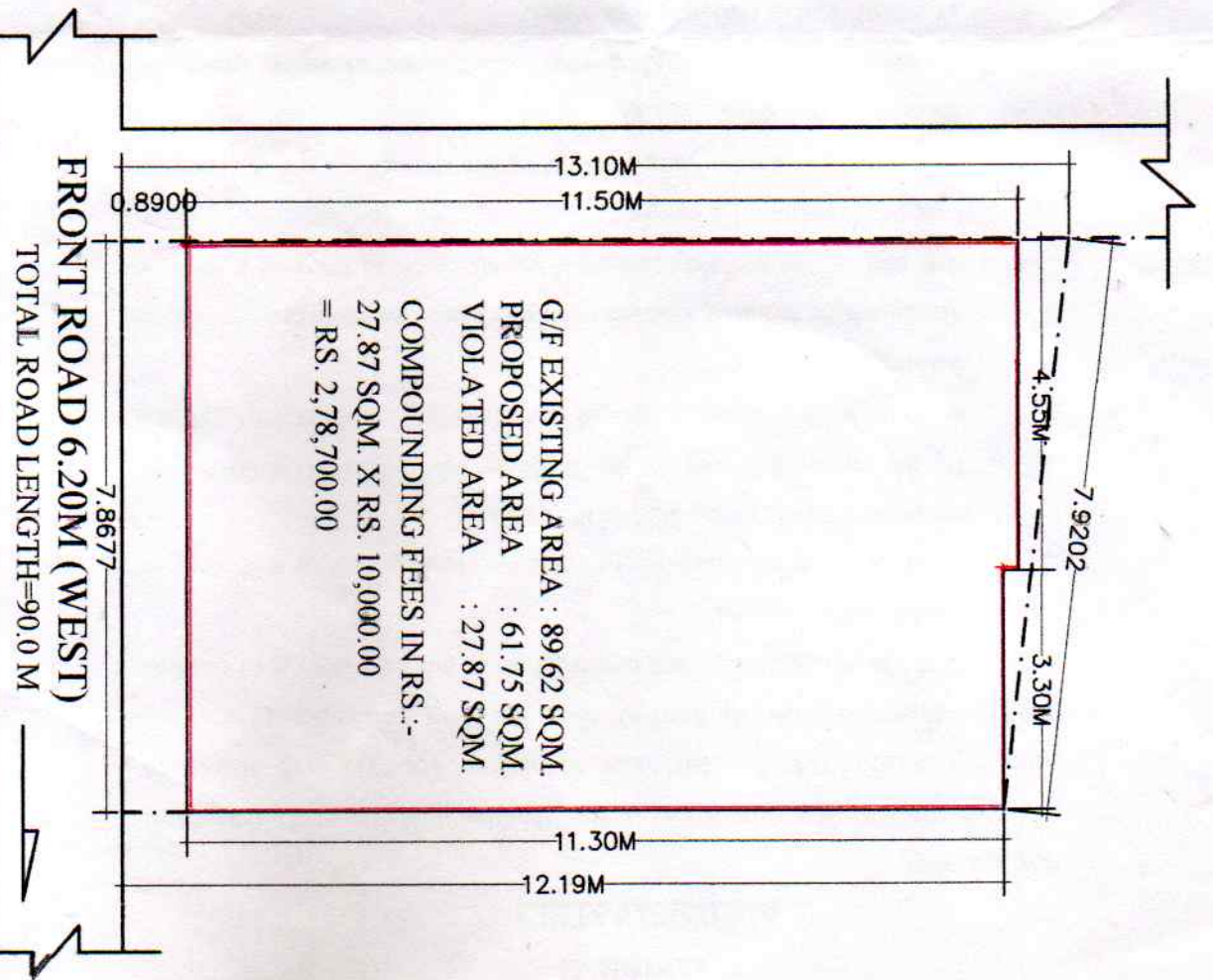

FRONT ROAD 6.20M (WEST)
TOTAL ROAD LENGTH=90.0 M

G/F EXISTING AREA : 89.62 SQM.
 PROPOSED AREA : 61.75 SQM.
 VIOLATED AREA : 27.87 SQM.
 COMPOUNDING FEES IN RS.:-
 27.87 SQM. X RS. 10,000.00
 = RS. 2,78,700.00

G/FLOOR EXISTING AREA

SCALE 1:100