

JAMSHEDPUR NOTIFIED AREA  
 WARD No- 9 SHEET No. 4  
 REV-THANA - GHATSHILA  
 DISTRICT:- SINGHBHUM  
 SCALE:- 1C.M.= 20M./1:2000  
 YEAR - 1970-71 A.D.

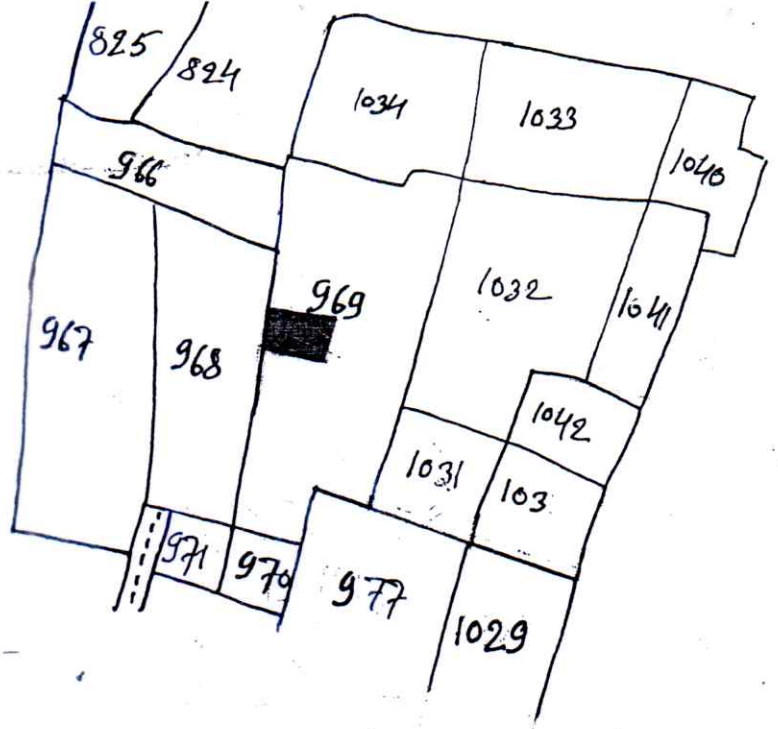

Propose Road-

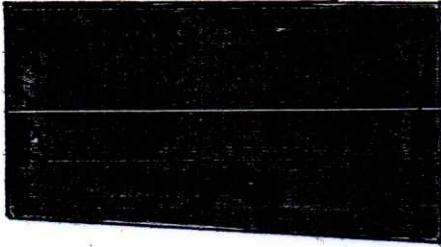

Khatg No	Plot No	Area more or less in Sq.ft	Decimal	Dimension	According to Seller Present Boundary:
327	969 (P)	1731	3.97	As sketch Reference deed No 5951 23/11/2002	North - A.P. Pandey / 15' Wide Propose Road South - Shiv Lal Yadav East - Rajmani Devi West - Umesh Thakur

Traced by  
 A. N. Roy (Amm)  
 JFR 26/06/2022  
**LAND SURVEYOR**  
 Reg No-748/2002-03  
 Res-W/10 Jsr, Jharkhand



अनुसूचित "नजरी नमदा"  
 ५ मीरती  
 ५/८/२०२२