

JAMSHEDPUR NOTIFIED AREA  
 WARD No-10 SHEET No. 3  
 REV-THANA - GHATSHILA  
 DISTRICT:- SINGHBHUM  
 SCALE:- I.C.M. = 20M./1:2000  
 YEAR - 1970-71 A.D.

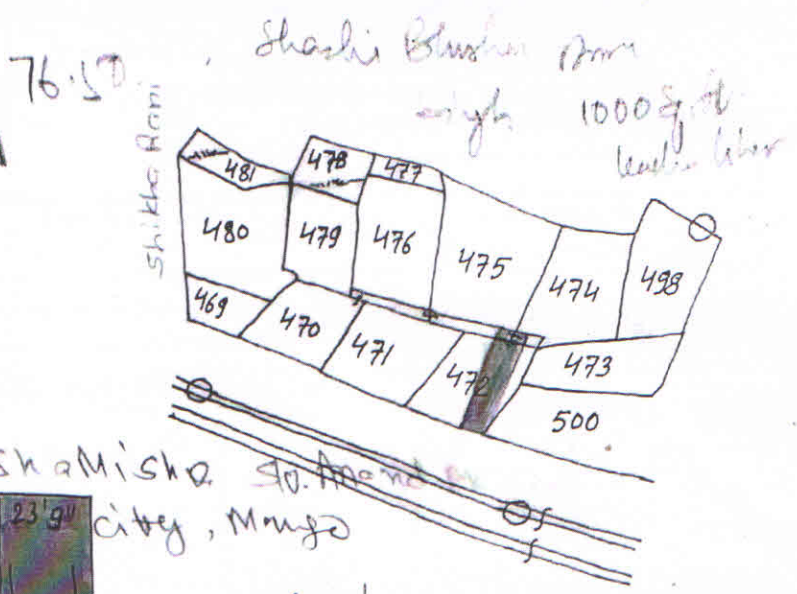

WITNESSES:  
 1. Abhay Krishna Mishra, 50, Anand Nagar, G.O. LD/1173, Sector 23, City, Muzo  
 2. Baban Singh

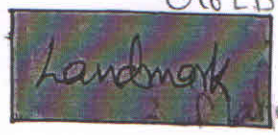

Drafted & Printed by: A. [Signature]

PURCHASE

— N. H. 33 —

Khata NO	Plot NO	Area more/less in sq ft	Deciml	Division as sketch	Boundary
424	470 (P)	119	0.27	[Fingerprints]	North - Plot No 475, 474
424	472 (P)	2030	4.66		South - N.H. 33
Total		2149	4.93		East - Plot No 472 (Part)
					West - Plot No 472 (Part) / Jai Manjaysingh

Traced by  
 H. N. Roy (Amm)  
 JPR 02/10/2022

Certificate:  
 It is certified that the fingerprints of each person's photographs are affixed in this document, have been obtained by before



Shikha Rani  
 Encl

[Signature]