

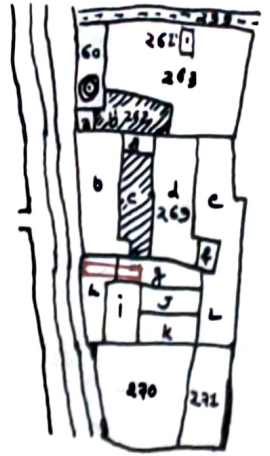

M. N. A. C = J. S. R  
 WARD No = 9  
 SHEET No = 3  
 YEAR OF = 1970-71  
 SCALE OF = 1. cm = 20 m



LAND MARK BY RED COLOUR □

KHATA No:-  
609

PLOT No:-  
269 (Portion)

AREA:-  
 $720 \text{ }^2\text{ft} = 1.00 \text{ (K)}$   
 $= 1.65 \text{ (Dec)}$   
 $60' \times 12' = 720 \text{ }^2\text{ft}$

BOUNDED BY:-

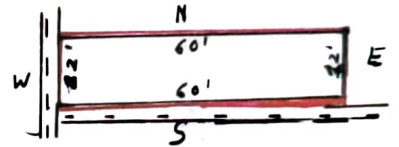

NORTH:- PORTION OF PLOT 269 (H, 8)

SOUTH:- 12' ROAD " "

EAST:- PORTION OF PLOT 269 (8)

WEST:- MANGO ROAD PURulia (Highway)

DEED No = 4396

DATE = 31.7.2012

AMIN

PARDIYA