

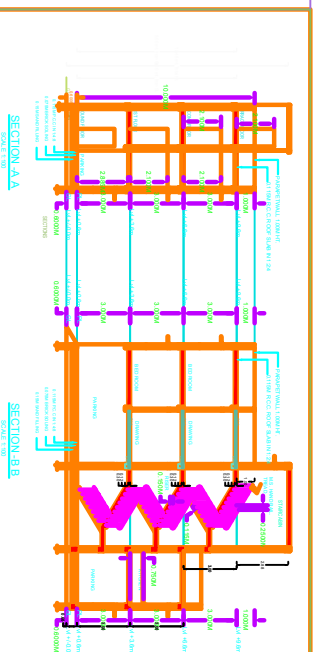

FRONT ELEVATION  
SCALE: 1/20



SECTION A-A  
SCALE: 1/20

SECTION B-B  
SCALE: 1/20

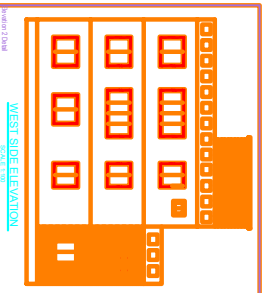

WEST SIDE ELEVATION  
SCALE: 1/20

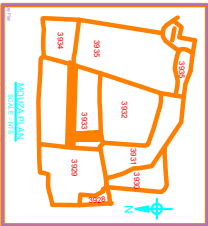

ARCHITECTURAL SITE PLAN  
SCALE: 1/20

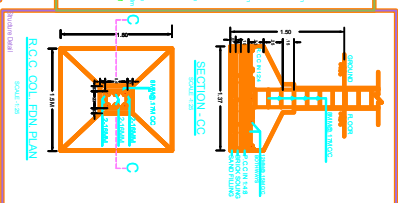

R.C.C. COL. & B.M. PLAN  
SCALE: 1/20

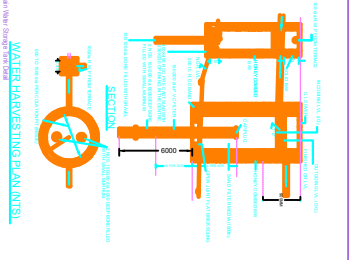

WATER HARVESTING PLAN (N/S)  
SCALE: 1/20

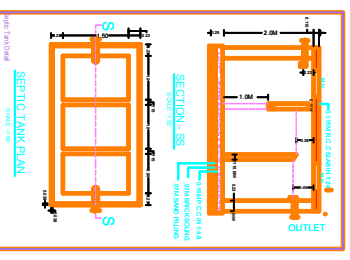

SEPTIC TANK PLAN  
SCALE: 1/20

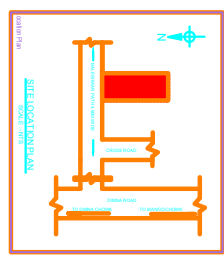

SITE LOCATION PLAN  
SCALE: 1/20

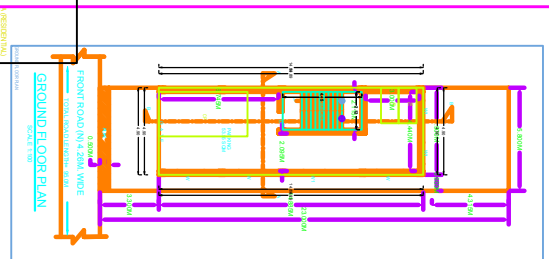

GROUND FLOOR PLAN  
SCALE: 1/20

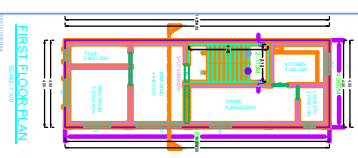

FIRST FLOOR PLAN  
SCALE: 1/20

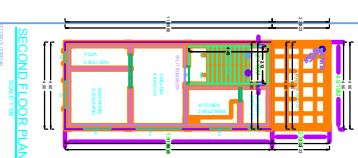

SECOND FLOOR PLAN  
SCALE: 1/20

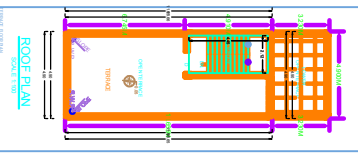

ROOF PLAN  
SCALE: 1/20

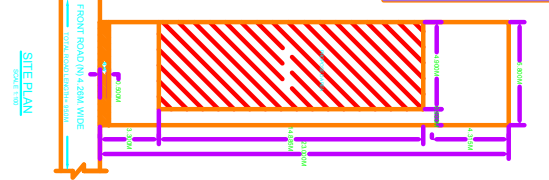

SITE PLAN  
SCALE: 1/20

**SCHEDULE OF MATERIALS**

Sl. No.	Particulars	Quantity	Unit	Remarks
1	Concrete (M20)	100.00	m <sup>3</sup>	
2	Concrete (M15)	50.00	m <sup>3</sup>	
3	Bricks (1000x200x200)	10000.00	nos	
4	Steel (Fe 415)	10.00	ton	
5	Plaster (1:3)	200.00	m <sup>2</sup>	
6	Plaster (1:4)	100.00	m <sup>2</sup>	
7	Paint (Emulsion)	10.00	liters	
8	Paint (Acrylic)	5.00	liters	
9	Waterproofing	100.00	m <sup>2</sup>	
10	Sanitary Ware	1.00	nos	
11	Electrical Fittings	1.00	nos	
12	Waterproofing	100.00	m <sup>2</sup>	
13	Waterproofing	100.00	m <sup>2</sup>	
14	Waterproofing	100.00	m <sup>2</sup>	
15	Waterproofing	100.00	m <sup>2</sup>	
16	Waterproofing	100.00	m <sup>2</sup>	
17	Waterproofing	100.00	m <sup>2</sup>	
18	Waterproofing	100.00	m <sup>2</sup>	
19	Waterproofing	100.00	m <sup>2</sup>	
20	Waterproofing	100.00	m <sup>2</sup>	



**SCHEDULE OF OPENINGS**

Sl. No.	Particulars	Quantity	Unit	Remarks
1	Door (1000x2000)	1.00	nos	
2	Window (1500x1000)	1.00	nos	
3	Window (1000x1000)	1.00	nos	
4	Window (1500x1500)	1.00	nos	
5	Window (1000x1500)	1.00	nos	
6	Window (1500x2000)	1.00	nos	
7	Window (1000x2000)	1.00	nos	
8	Window (1500x2500)	1.00	nos	
9	Window (1000x2500)	1.00	nos	
10	Window (1500x3000)	1.00	nos	
11	Window (1000x3000)	1.00	nos	
12	Window (1500x3500)	1.00	nos	
13	Window (1000x3500)	1.00	nos	
14	Window (1500x4000)	1.00	nos	
15	Window (1000x4000)	1.00	nos	

**GENERAL SPECIFICATION**

1. ALL WORKS SHALL BE DONE AS PER THE DRAWINGS AND SPECIFICATIONS.

2. THE CONTRACTOR SHALL BE RESPONSIBLE FOR OBTAINING ALL NECESSARY PERMITS AND APPROVALS FROM THE LOCAL AUTHORITIES.

3. THE CONTRACTOR SHALL MAINTAIN ACCESS TO ALL ADJACENT PROPERTIES AT ALL TIMES.

4. THE CONTRACTOR SHALL BE RESPONSIBLE FOR THE PROTECTION OF ALL EXISTING UTILITIES AND STRUCTURES.

5. THE CONTRACTOR SHALL MAINTAIN A NEAT AND ORDERLY WORK SITE AT ALL TIMES.

6. THE CONTRACTOR SHALL BE RESPONSIBLE FOR THE DISPOSAL OF ALL WASTE MATERIALS.

7. THE CONTRACTOR SHALL BE RESPONSIBLE FOR THE PROTECTION OF THE ENVIRONMENT.

8. THE CONTRACTOR SHALL BE RESPONSIBLE FOR THE SAFETY OF ALL WORKERS AND THE PUBLIC.

9. THE CONTRACTOR SHALL BE RESPONSIBLE FOR THE PROTECTION OF ALL ADJACENT PROPERTIES.

10. THE CONTRACTOR SHALL BE RESPONSIBLE FOR THE PROTECTION OF ALL EXISTING UTILITIES AND STRUCTURES.

**PROPOSED RESIDENTIAL BUILDING**

1.MR. DILIP KUMAR PRASAD  
S/O SRI RAMKISHUN SAW  
2.MRS. ARTI PRASAD  
W/O MR. DILIP KUMAR PRASAD  
AT: BALESHWAR PATH, DIMMA ROAD, MANNO  
JAMSHEDPUR, JHARKHAND

DATE OF PLAN : 15/04/2024  
SCALE : 1/20  
DRAWN BY : SRI RAMKISHUN SAW  
CHECKED BY : SRI RAMKISHUN SAW  
APPROVED BY : SRI RAMKISHUN SAW

CONTRACT NO. : 15/04/2024  
PROJECT NO. : 15/04/2024  
DRAWING NO. : 15/04/2024  
SCALE : 1/20  
DATE : 15/04/2024

DESIGNED AND DRAWN BY : SRI RAMKISHUN SAW  
TOTAL AREA : 1500 SQ.M  
REGULATED AREA : 1500 SQ.M  
REQUIRED FOR VENTILATION : 1500 SQ.M  
REQUIRED FOR LIGHTING : 1500 SQ.M  
PROPOSED FINISHED AREA : 1500 SQ.M

SIGNATURE OF ARCHITECTURAL ENGINEER  
SRI RAMKISHUN SAW

SIGNATURE OF OWNER  
SRI RAMKISHUN SAW

APPROVED BY ARCHITECT  
SRI RAMKISHUN SAW

Sl. No.	Particulars	Quantity	Unit	Remarks
1	Concrete (M20)	100.00	m <sup>3</sup>	
2	Concrete (M15)	50.00	m <sup>3</sup>	
3	Bricks (1000x200x200)	10000.00	nos	
4	Steel (Fe 415)	10.00	ton	
5	Plaster (1:3)	200.00	m <sup>2</sup>	
6	Plaster (1:4)	100.00	m <sup>2</sup>	
7	Paint (Emulsion)	10.00	liters	
8	Paint (Acrylic)	5.00	liters	
9	Waterproofing	100.00	m <sup>2</sup>	
10	Sanitary Ware	1.00	nos	
11	Electrical Fittings	1.00	nos	
12	Waterproofing	100.00	m <sup>2</sup>	
13	Waterproofing	100.00	m <sup>2</sup>	
14	Waterproofing	100.00	m <sup>2</sup>	
15	Waterproofing	100.00	m <sup>2</sup>	
16	Waterproofing	100.00	m <sup>2</sup>	
17	Waterproofing	100.00	m <sup>2</sup>	
18	Waterproofing	100.00	m <sup>2</sup>	
19	Waterproofing	100.00	m <sup>2</sup>	
20	Waterproofing	100.00	m <sup>2</sup>	

Sl. No.	Particulars	Quantity	Unit	Remarks
1	Door (1000x2000)	1.00	nos	
2	Window (1500x1000)	1.00	nos	
3	Window (1000x1000)	1.00	nos	
4	Window (1500x1500)	1.00	nos	
5	Window (1000x1500)	1.00	nos	
6	Window (1500x2000)	1.00	nos	
7	Window (1000x2000)	1.00	nos	
8	Window (1500x2500)	1.00	nos	
9	Window (1000x2500)	1.00	nos	
10	Window (1500x3000)	1.00	nos	
11	Window (1000x3000)	1.00	nos	
12	Window (1500x3500)	1.00	nos	
13	Window (1000x3500)	1.00	nos	
14	Window (1500x4000)	1.00	nos	
15	Window (1000x4000)	1.00	nos	