

Project Title : PROPOSED RESIDENTIAL BUILDING (G)

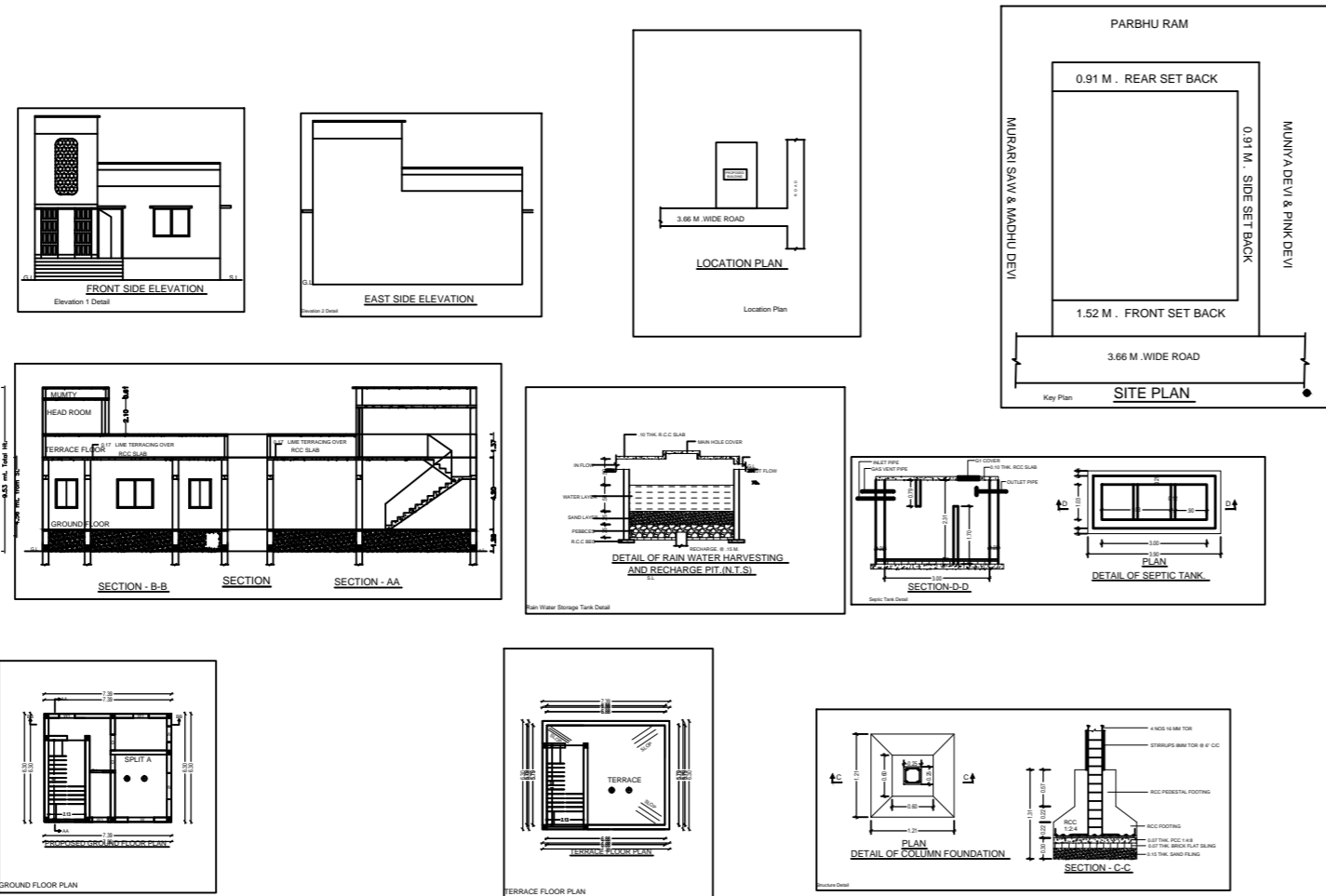

SCHEDULE OF FINISHES	
NO.	DESCRIPTION
01	CEILING
02	WALLS
03	FLOORING
04	PAINTING
05	GLASS
06	IRONWORK
07	WOODWORK
08	MECHANICAL
09	ELECTRICAL
10	PLUMBING

SPECIFICATION	
1.	FOUNDATION R.C.C COLUMN FOUNDATION IN 1:2:4 @ 80 PER CENT
2.	STRUCTURE 80% CLASS BRICK WORK IN CM 1:6 IN PART OF 1:8 & 2:STRUCTURE
3.	R.C.C. LINTEL BAND ROOF SLAB IN 1:2:4
4.	PLASTERING 1:3:6 FOR WALL IN 1:8 & 1:4 TH CEMENT PLASTER ON CEILING 1:4
5.	FLOORING 1:3:6 THIN FLOOR ON MARBLE FLOORCOVER 2:1 TH DRY MASHED SAND OVER SANDCAST POLAR
6.	1:1 TH AVULINE CONCRETE 5:11 R.C.C. SLAB
7.	FLOORING AND DADO Mosaic ON TILES
8.	TOILETS PVC PIPE FITTING WITH PERRY WARE SANITARY FITTING
9.	PAINTING LIME WASH DISTEMPER ON INTERNAL SURFACE AND OVER EXTERNAL SYNTHETIC ENAMEL PAINT OVER WOOD AND STEEL WORK

TOTAL PLOT AREA	= 101.09 sqm
TOTAL OPEN LAND AREA	= 31.97 sqm
PROPOSED GROUND FLOOR	= 69.12 sqm
TOTAL	= 69.12 sqm
F.A.R.	0.68
% OF COVERED AREA	68%
BUILDING HEIGHT	3.96

PROPOSED RESIDENTIAL BUILDING OF
 NO. 101, CHATRA NAGAR PARISHAD
 CHATRA, DIST. CHATRA (MADHAR)

SIGNATURE OF APPLICANT
Law Chaturvedi
 ER. LAW CHATURVEDI
 REG. NO. CHATRA/101/18
 CHATRA NAGAR PARISHAD
 CHATRA (MADHAR)

SIGNATURE OF ENGINEER

MAP APPROVED BY

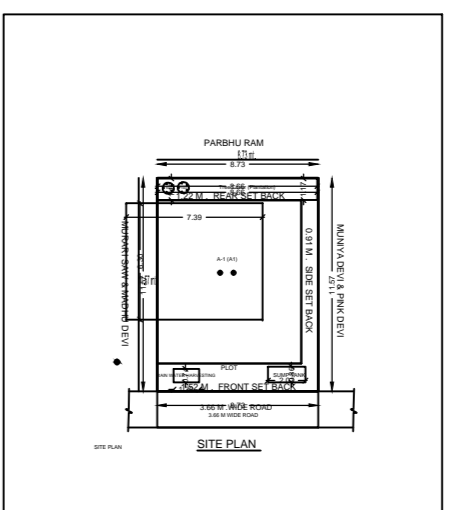

CODE INDEX	
01	CEILING
02	WALLS
03	FLOORING
04	PAINTING
05	GLASS
06	IRONWORK
07	WOODWORK
08	MECHANICAL
09	ELECTRICAL
10	PLUMBING

Building & S.I.	
NO.	DESCRIPTION
1	...
2	...
3	...
4	...
5	...
6	...
7	...
8	...
9	...
10	...