

Gumla Nagar Parishad

SITE VISIT REPORT

Proposal Details

| | |
|-----------------------------------|--|
| Owner Name : BIRENDRA PRASAD SAHU | Site Visit Date : 07 October, 2017 |
| Applicant Name : DEEN DAYAL GUPTA | File No. : GUNPC/BP/0011/W17/2017 |
| Ward No. : W17 | Case Type : New |
| Thana No. : 59 | Plot No. : 853 |
| Road No. / Name : Gokul nagar | Registration No. : GUNPC/ENG/0002/2017 |

Site Visit Checklist

| # | Description | As On Site | Objection | Remark |
|-----|--|-------------------------------------|-----------|--------|
| 1. | Whether Existing at Site | Yes | | n |
| 2. | Whether connected with an existing public road | Yes | | |
| 3. | Status of road | Public | | |
| 4. | Nature of Road | Kutchha | | |
| 5. | Width of approach road | 4.88m | | |
| 6. | Whether road side drain exists | No | | |
| 7. | if Whether road side drain exists is No - Distance from nearest drain | about 50 M | | |
| 8. | if Whether road side drain exists is No - easibility to connect | Yes | | |
| 9. | if Whether road side drain exists is No - Scope of widening of road | yes | | |
| 10. | Whether the site is at road junction | No | | |
| 11. | Level of site in relation to approach road | equal to road level | | |
| 12. | Whether the area is subject to | Low lying land | | |
| 13. | Whether the locality is | Developed | | |
| 14. | Distance of the plot from the nearest temple/ monument / Airport/ Other important building | about 150 m east of star DPS school | | |
| 15. | The vertical and horizontal distance from 33 KV/11 KV electric line | na | | |
| 16. | Whether the Site is vacant | Yes | | |
| 17. | Plot size (As per measurement)(In Sqmt) | 157.32 | | |
| 18. | Whether the applicant encroached the Govt. land/road land/any other land/drainage channel | No | | |
| 19. | Sketch site plan showing the location of the site, important land marks and connectivity with the main road is enclosed. (For site not located on main road) at page | attached | | |
| 20. | Any other information. | na | | |
| 21. | Verified the Amins report with/without site inspection and found correct | Yes | | |
| 22. | If No, Reason | na | | |
| 23. | Land Use | Residential | | |
| 24. | Road | Yes | | |
| 25. | Sewerage | No | | |
| 26. | Drainage | No | | |
| 27. | Water facility | Yes | | |
| 28. | Availability of drain | No | | |
| 29. | Telephone | Yes | | |
| 30. | Electricity | Yes | | |

| | | | | |
|-----|--|---------------------------------------|--|--|
| 31. | Dealing with inflammable/chemical | No | | |
| 32. | Occupancy | Yes | | |
| 33. | EAST | east | | |
| 34. | WEST | west | | |
| 35. | NORTH | road | | |
| 36. | SOUTH | south | | |
| 37. | Length of the Road(In Mtr.) | Exceeding 50 meter and upto 100 meter | | |
| 38. | Existing Width of the Road(In Mtr.) | 4.88 | | |
| 39. | Proposed Width of the Road as per Master Plan(In Mtr.) | 3.66 | | |
| 40. | Width of the RoadWidening(In Mtr.) | 0.001 | | |

Site Visit Photographs :

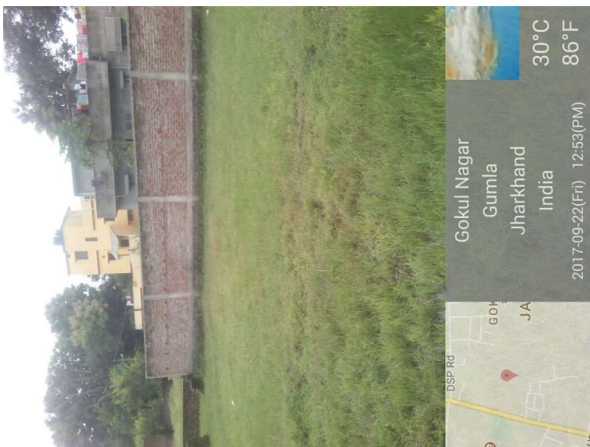
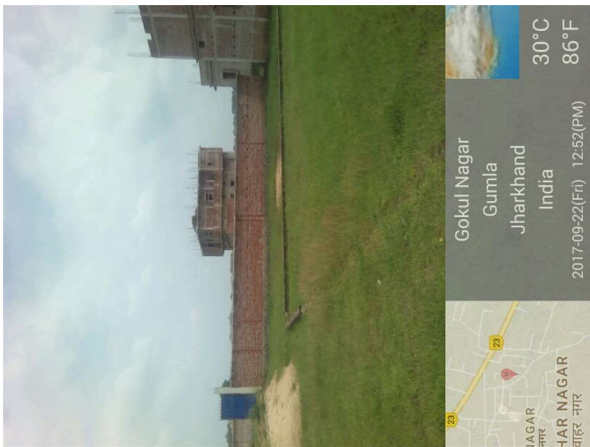

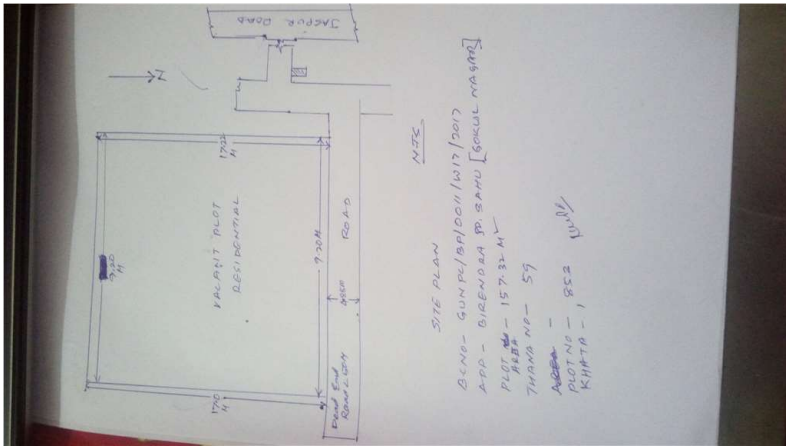

Recommendation : Verified & found Ok

Remark : ok

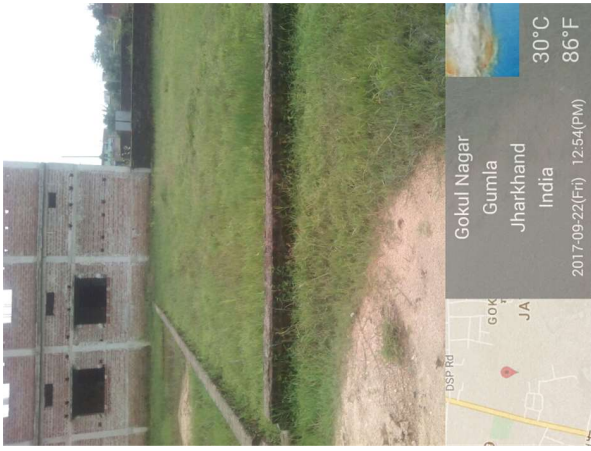
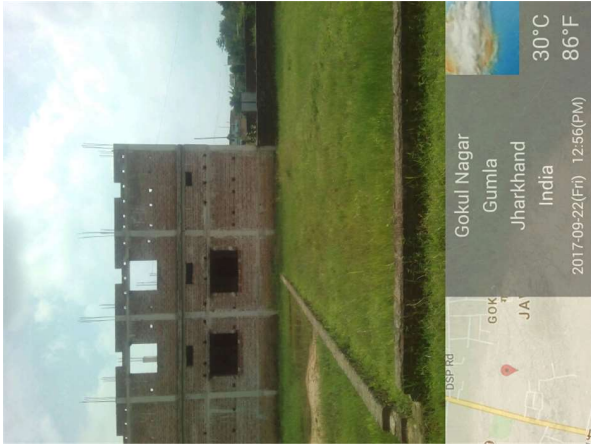

Nawal Kishore Prashad
Junior Engg