

Proposal Basic Information

|                   |                                    |
|-------------------|------------------------------------|
| Proposal File No. | GUNPC/BP/0040/W06/2023             |
| Owner Name        | MD. EDRIS KHAN                     |
| Khata No          | 63                                 |
| Plot No           | 82                                 |
| Village Name      | Thana Road                         |
| Use               | Residential                        |
| SubUse            | Bungalow/ Dwelling / Non Apartment |

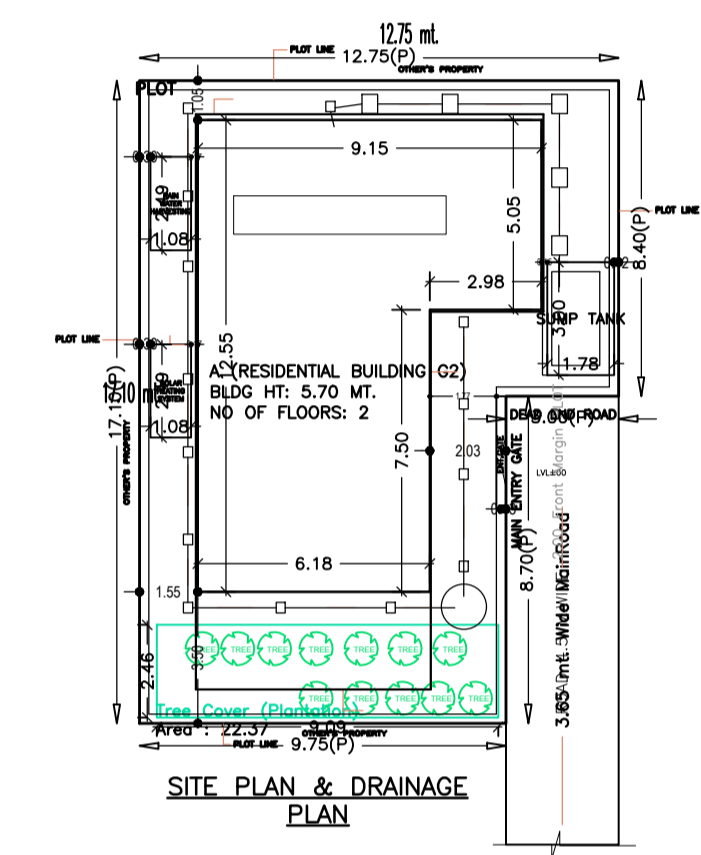
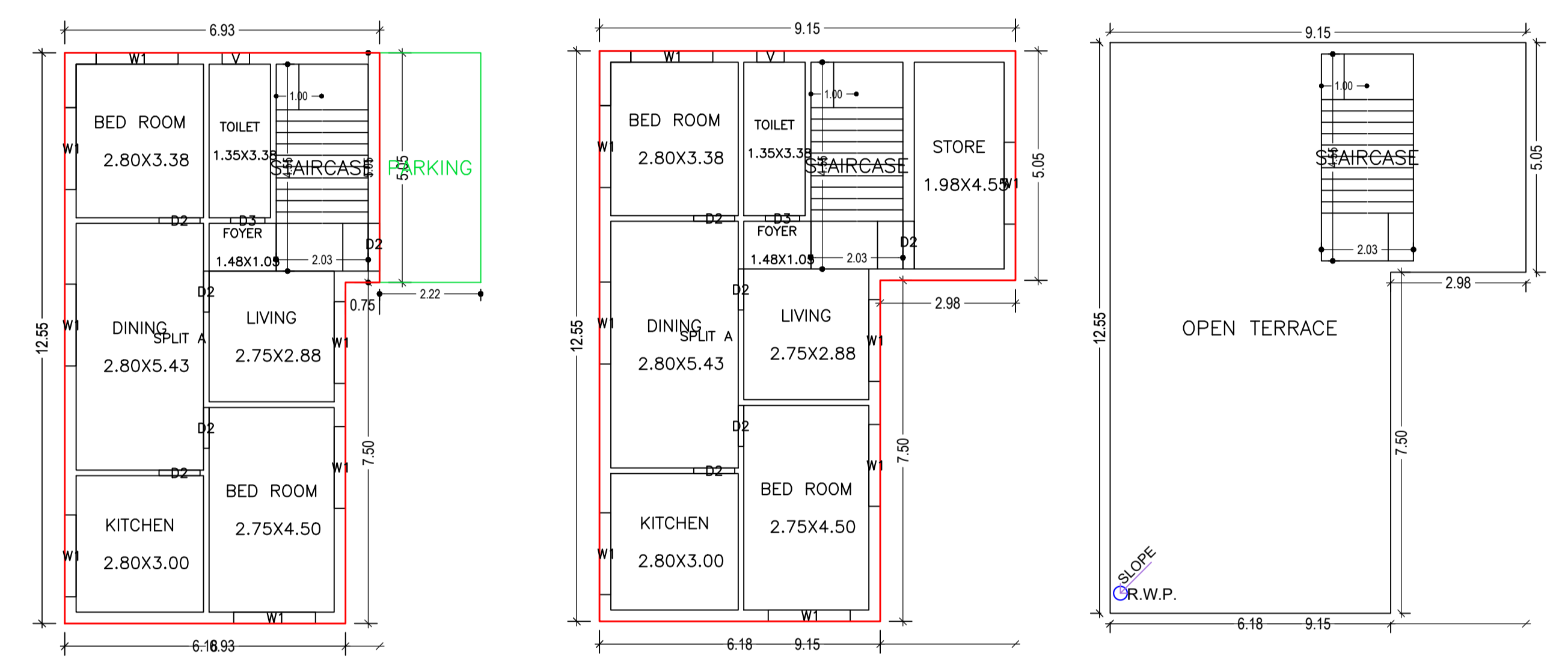
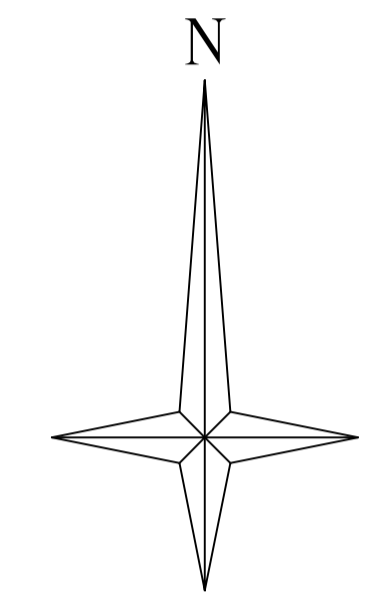

Building :A (RESIDENTIAL BUILDING G2)

| Floor Name                     | Total Built Up Area (Sq.mt.) | Deductions (Area in Sq.mt.) |        | Proposed FAR Area (Sq.mt.) | Total FAR Area (Sq.mt.) | Total Consumed Additional FAR Area (Sq.mt.) | Trmt (No.) |
|--------------------------------|------------------------------|-----------------------------|--------|----------------------------|-------------------------|---|------------|
|                                |                              | Parking                     | Resi.  |                            |                         |   |            |
| Ground Floor                   | 92.52                        | 11.24                       | 81.28  | 81.28                      | 81.28                   | 81.28                                       | 01         |
| First Floor                    | 92.52                        | 0.00                        | 92.52  | 92.52                      | 92.52                   | 92.52                                       | 00         |
| Terrace Floor                  | 0.00                         | 0.00                        | 0.00   | 0.00                       | 0.00                    | 0.00  | 00         |
| Total :                        | 185.04                       | 11.24                       | 173.80 | 173.80                     | 173.80                  | 173.80                                      | 01         |
| Total Number of Same Buildings | 1                            |                             |        |                            |                         |   |            |
| Total :                        | 185.04                       | 11.24                       | 173.80 | 173.80                     | 173.80                  | 173.80                                      | 01         |

SCHEDULE OF DOOR:

| BUILDING NAME               | NAME | LENGTH | HEIGHT | NOS |
|-----------------------------|------|--------|--------|-----|
| A (RESIDENTIAL BUILDING G2) | D3   | 0.75   | 2.10   | 02  |
| A (RESIDENTIAL BUILDING G2) | D2   | 0.90   | 2.10   | 08  |
| A (RESIDENTIAL BUILDING G2) | D2   | 1.05   | 2.10   | 01  |

SCHEDULE OF WINDOW/VENTILATION:

| BUILDING NAME               | NAME | LENGTH | HEIGHT | NOS |
|-----------------------------|------|--------|--------|-----|
| A (RESIDENTIAL BUILDING G2) | V    | 0.60   | 1.20   | 02  |
| A (RESIDENTIAL BUILDING G2) | W1   | 1.80   | 1.20   | 15  |

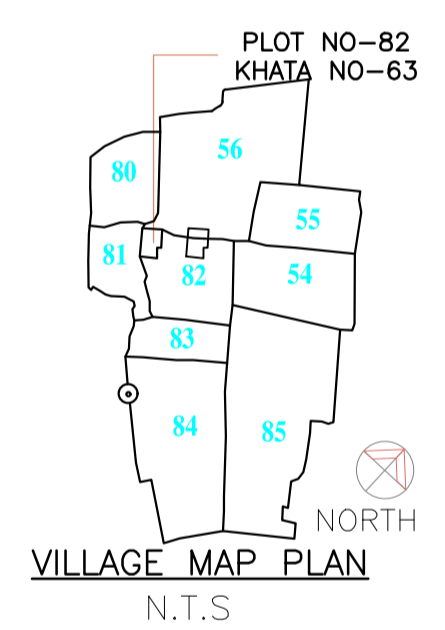

| AREA STATEMENT GUMLA NAGAR PARISHAD                                |   | VERSION NO. : 1.0.66 | VERSION DATE: 16/10/2020 |
|--|---|----------------------|--------------------------|
| <b>PROJECT DETAIL:</b>   |   |                      |                          |
| Region - JHARKHAND URBAN LOCAL BODIES                              | Plot Use: Residential                           |                      |                          |
| District - GUMLA   | Plot SubUse: Bungalow/ Dwelling / Non Apartment |                      |                          |
| Authority: GUMLA NAGAR PARISHAD                                    | PlotNearby/ReligiousStructure: NA               |                      |                          |
| Inward_No: GUNPC/BP/0040/W06/2023                                  | Plot/SubPlot No: 82                             |                      |                          |
| Application Type: General Proposal                                 | North: -  |                      |                          |
| Project Type: Building Permission                                  | South: -  |                      |                          |
| Nature of Development: New   | East: -   |                      |                          |
| Location of Development Area: Old Area                             | West: -   |                      |                          |
| <b>AREA DETAILS:</b>   |   |                      | SQ.MT.                   |
| AREA OF PLOT (Minimum)   | (A)   |                      | 191.93                   |
| NET AREA OF PLOT(Gross Plot Area - Deduction from Gross Plot area) | (A-Deductions)                                  |                      | 191.93                   |
| Deduction for Balance Plot Area(from Gross Plot Area)              |   |                      |                          |
| Common Plot  |   |                      | 22.37                    |
| Total  |   |                      | 22.37                    |
| BALANCE AREA OF PLOT(Net Plot Area - Recreational/Amenity space)   | (A-Deductions)                                  |                      | 169.55                   |
| PLOT AREA FOR COVERAGE(Net Plot Area)                              | (A-Deductions)                                  |                      | 191.93                   |
| Plot Area for FAR (Net Plot Area + RoadWidening Area)              | (A-Deductions)                                  |                      | 191.93                   |
| <b>COVERAGE CHECK</b>  |   |                      |                          |
| Permissible Coverage area ( 70.00 % )                              |   |                      | 134.35                   |
| Proposed Coverage Area ( 48.21 % )                                 |   |                      | 92.52                    |
| Total Prop. Coverage Area ( 48.21 % )                              |   |                      | 92.52                    |
| Balance coverage area ( 21.79 % )                                  |   |                      | 41.83                    |
| <b>FAR CHECK</b>   |   |                      |                          |
| Perm. FAR Area ( 1.500 )   |   |                      | 287.89                   |
| Total Perm. FAR area   |   |                      | 287.89                   |
| Residential FAR  |   |                      | 173.80                   |
| Proposed FAR Area  |   |                      | 173.80                   |
| Total Proposed FAR Area  |   |                      | 173.80                   |
| Consumed FAR (Factor)  |   |                      | 0.91                     |
| Balance FAR Area   |   |                      | 114.09                   |
| <b>BUILT UP AREA CHECK</b>   |   |                      |                          |
| Total Proposed BuiltUp Area  |   |                      | 185.04                   |
| ARCHITECT (Regd)   |   | SANTOSH KUMAR NAG    |                          |
| ENGINEER (Regd)  |   |                      |                          |
| SUPERVISOR (Regd)  |   |                      |                          |
| OWNER (Regd)   |   | MD. EDRIS KHAN       |                          |
| DEVELOPMENT AUTHORITY  |   |                      | LOCAL BODY               |

FAR & Tenement Details (Table 4c-1)

| Building                    | No. of Same Bldg | Total Built Up Area (Sq.mt.) | Deductions (Area in Sq.mt.) |        | Proposed FAR Area (Sq.mt.) | Total FAR Area (Sq.mt.) | Total Consumed Additional FAR Area (Sq.mt.) | Trmt (No.) |
|-----------------------------|------------------|------------------------------|-----------------------------|--------|----------------------------|-------------------------|---|------------|
|                             |                  |                              | Parking                     | Resi.  |                            |                         |   |            |
| A (RESIDENTIAL BUILDING G2) | 1                | 185.04                       | 11.24                       | 173.80 | 173.80                     | 173.80                  | 173.80                                      | 01         |
| Grand Total                 | 1                | 185.04                       | 11.24                       | 173.80 | 173.80                     | 173.80                  | 173.80                                      | 01         |

UnitBUA Table for Building :A (RESIDENTIAL BUILDING G2)

| FLOOR             | Name    | UnitBUA Type | UnitBUA Area | Carpet Area | No. of Rooms | No. of Tenement |
|-------------------|---------|--------------|--------------|-------------|--------------|-----------------|
| GROUND FLOOR PLAN | SPLIT A | FLAT         | 173.80       | 172.98      | 7            | 1               |
| FIRST FLOOR PLAN  | SPLIT A | FLAT         | 0.00         | 0.00        | 8            | 0               |
| Total:            | -       | -            | 173.80       | 172.98      | 15           | 1               |

Buildingwise Floor FAR Details

| Floor Name    | Building Name                   |                            | Total                                 |                         |
|---------------|---------------------------------|----------------------------|---------------------------------------|-------------------------|
|               | Proposed Built Up Area (Sq.mt.) | Proposed FAR Area (Sq.mt.) | Total Proposed Built Up Area (Sq.mt.) | Total FAR Area (Sq.mt.) |
| Ground Floor  | 92.52                           | 81.28                      | 92.52                                 | 81.28                   |
| First Floor   | 92.52                           | 92.52                      | 92.52                                 | 92.52                   |
| Terrace Floor | 0.00                            | 0.00                       | 0.00                                  | 0.00                    |
| Total :       | 185.04                          | 173.80                     | 185.04                                | 173.80                  |

Building USE/SUBUSE Details

| Building Name               | Building Use | Building SubUse                    | Building Structure |
|-----------------------------|--------------|------------------------------------|--------------------|
| A (RESIDENTIAL BUILDING G2) | Residential  | Bungalow/ Dwelling / Non Apartment | Non-Highrise       |

COLOR INDEX

|                             |               |
|-----------------------------|---------------|
| PLOT BOUNDARY               | [Red Line]    |
| ABUTTING ROAD               | [Green Line]  |
| PROPOSED CONSTRUCTION       | [Blue Line]   |
| COMMON PLOT                 | [Yellow Line] |
| ROAD WIDENING AREA          | [Orange Line] |
| EXISTING (To be retained)   | [Purple Line] |
| EXISTING (To be demolished) | [Brown Line]  |

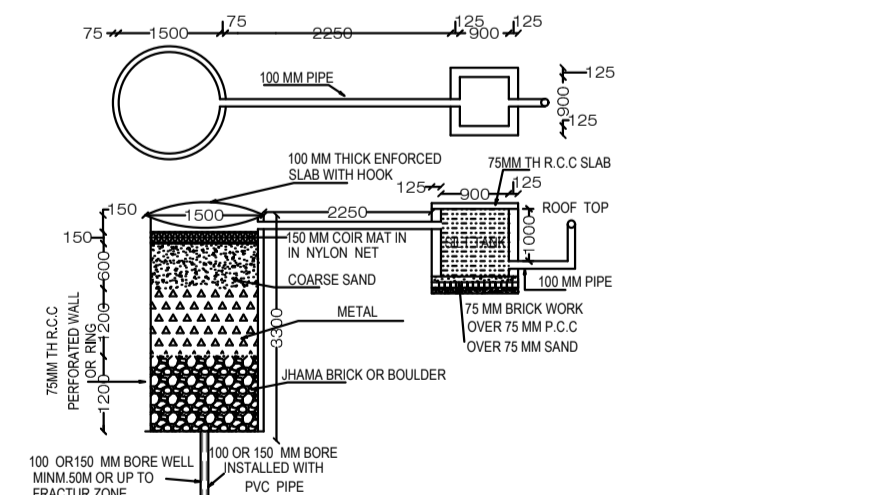

| LTP NAME AND SIGNATURE                   | STRUCTURAL ENG'S NAME AND SIGNATURE | BUILDER NAME AND SIGNATURE | DIGITAL SIGNATURE |
|--|-------------------------------------|----------------------------|-------------------|
| SANTOSH KUMAR NAG<br>GUNPC/ARC/0005/2018 |                                     |                            |                   |