

PLAN PREPARED FOR REGISTRATION.

NAME AND ADDRESS OF VENDER :-

SRI. SANAT KUMAR DAWN,
S/O. LATE AKSHAYA KUMAR DAWN,
AT. P.O. & DIST. - KODERMA

NAME AND ADDRESS OF VENDEE :-

SMT. INDRAWATI DEVI,
W/O. SUDERSHAN PRASAD YADAV,
VILLAGE & P.O. - GUJHUNDI,
DIST. - KODERMA.

DETAILS OF THE SOLD LAND :-

IN VILLAGE - TELAIYA, THANA NO. 244,
THANA - TELAIYA, JHUMRITELAIYA MUNICIPALITY,
WARD NO. 12, DIST. - KODERMA, JHARKHAND STATE.
KHATA NO. 1185,

PLOT NO. 7678 (PART),

AREA - 4356 SQ. FT. = 10 DECIMALS.
SHOWN IN RED COLOUR.

BOUNDARY OF THE SOLD LAND :-

NORTH - RAIL WAY STATION - KODERMA.
EAST - PLOT NO. 7678 (P), LAND OF SRI. PRADEEP KEDIA & OTHERS.
SOUTH - PLOT NO. 7678 (P), 15 FT. WIDE ROAD PROVIDED BY VENDER.
WEST - PLOT NO. 7678 (P), LAND OF VENDER.

SCALE - 1 INCH = 40 FT.

W E

DIMENSION OF THE SOLD

LAND - A to B - 34'8"
B to C - 121'0"
C to D - 34'3"
D to A - 138'0"

VILLAGE PLAN SHOWING

THE LAND SOLD TO
SMT. INDRAWATI DEVI.
IN VILLAGE - TELAIYA.
PLOT NO. 7678 (PART).
AREA - 10 DECIMALS.
SHOWN IN RED COLOUR.
SCALE - 1/6 INCH = 1 MILE.
NOTE - 15 FT. WIDE ROAD
PROVIDED BY VENDER
SHOWN IN GREEN COLOUR.

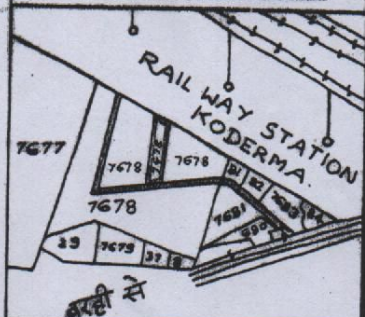
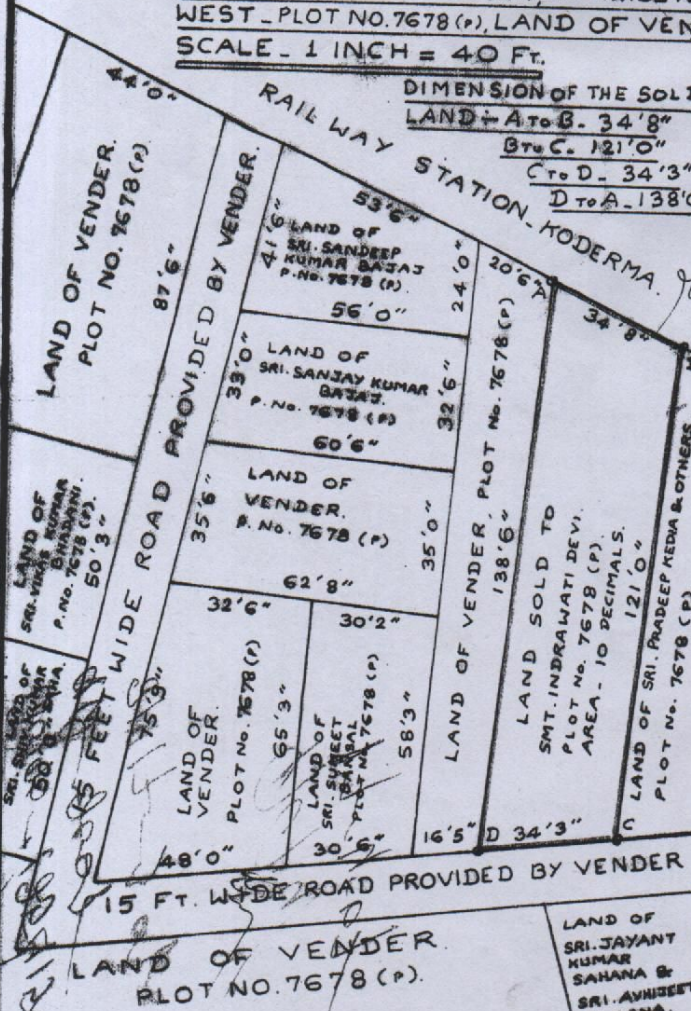

SIGNATURE OF VENDER:

Sanat Kr Dawn
 13-4-07

SIGNATURE OF WITNESS:

PLAN PREPARED BY:
 V. K. UNNERSI KUTTY,
 SURVEYOR.
 CERTIFIED TO BE THE TRUE
 COPY OF THE ORIGINAL.

Handwritten notes in the left margin, including '149/1' and other illegible scribbles.

N

PLAN PREPARED FOR REGISTRATION.

NAME AND ADDRESS OF VENDER:-

SRI. SANAT KUMAR DAWN,
S/O. LATE AKSHAYA KUMAR DAWN,
AT. P.O. & DIST. KODERMA.

NAME AND ADDRESS OF VENDEE:-

SRI. SUDERSHAN PRASAD YADAV,
S/O. SRI. RAMESHWAR PRASAD YADAV,
VILLAGE & P.O. GUJHUNDI,
DIST. KODERMA.

DETAILS OF THE SOLD LAND:-

IN VILLAGE TELAIYA, THANA NO. 244,
THANA TELAIYA, JHUMRITELAIYA MUNICIPALITY,
WARD NO. 12, DIST. KODERMA, JHARKHAND STATE
KHATA NO. 1185.

PLOT NO. 7678 (PART).

AREA - 2612 SQ. FT. = 6 DECIMALS.

SHOWN IN RED COLOUR.

BOUNDARY OF THE SOLD LAND:-

NORTH - RAILWAY STATION, KODERMA.

EAST - PLOT NO. 7678 (P), LAND OF SMT. INDRAWATI DEVI.

SOUTH - PLOT NO. 7678 (P), 15 FT. WIDE ROAD PROVIDED BY VENDER.

WEST - PLOT NO. 7678 (P), LAND OF SRI. SUMEET BANSAL, SRI. SANJAY K. BATAJ,

SCALE - 1 INCH = 40 FT. SRI. SANDEEP KUMAR BATAJ & VENDER.

W E

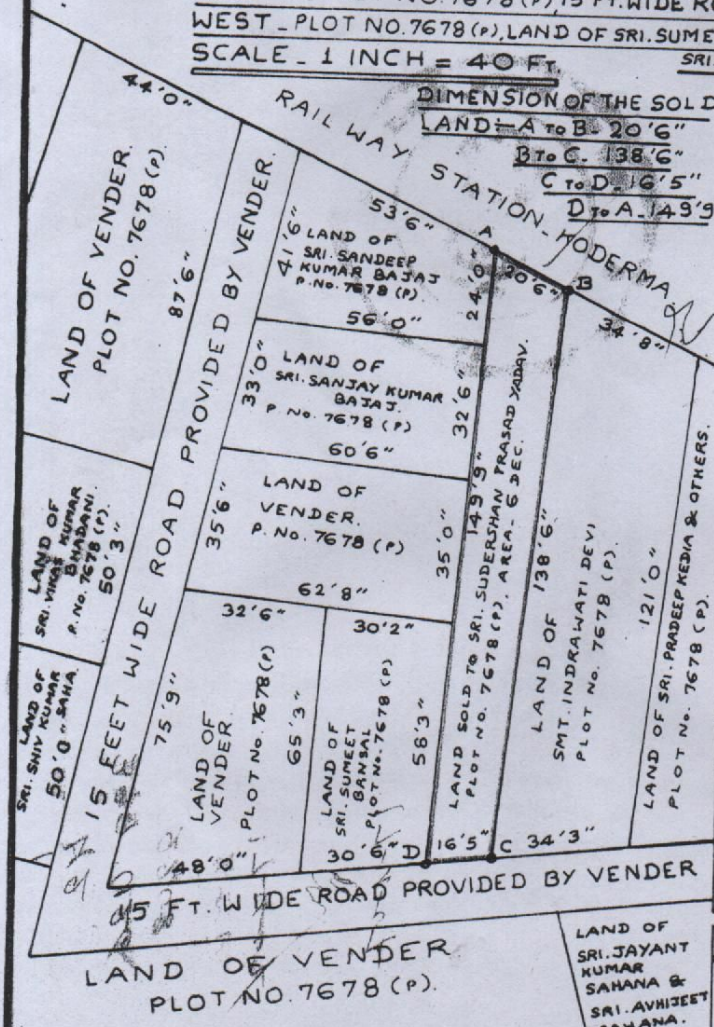

DIMENSION OF THE SOLD LAND:-
A to B - 20'6"
B to C - 138'6"
C to D - 16'5"
D to A - 149'9"

VILLAGE PLAN SHOWING
THE LAND SOLD TO
SRI. SUDERSHAN PRASAD YADAV
IN VILLAGE TELAIYA.
PLOT NO. 7678 (PART).
AREA - 6 DECIMALS.
SHOWN IN RED COLOUR.
SCALE - 1/16 INCH = 1 MILE.
NOTE - 15 FT. WIDE ROAD
PROVIDED BY VENDER
SHOWN IN GREEN COLOUR

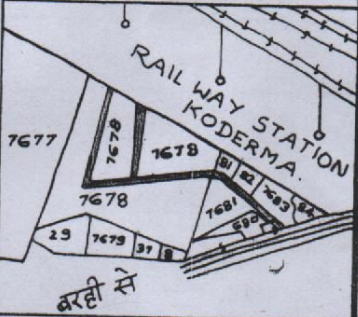

SIGNATURE OF VENDER.

SIGNATURE OF WITNESS.

LAND OF SRI. JAYANT KUMAR SAHANA & SRI. AVHIJEET SAHANA. PLOT NO. 7678 (P)