

LAND OF LATE VIDYA DEVI, W/O. LATE CHUNNI LAL SALUJA,

POWER OF ATTORNEY TO SOLD THIS LAND BY-

1. SRI. RAM PRASAD SALUJA, S/O. LATE VIDYA DEVI &

LATE CHUNNI LAL SALUJA, AT MINOCHA COLONY,  
TASIL & DIST. - BILASPUR, CHATISGARH STATE.

2. SRI. SARDAR RANJIT SINGH SALUJA, S/O. LATE VIDYA

DEVI & LATE CHUNNI LAL SALUJA, AT. LORMI, TASIL -  
LORMI, DIST. - MUNGELI, CHATISGARH STATE &

3. SRI. SURJEET SINGH SALUJA, S/O. LATE VIDYA DEVI &

LATE CHUNNI LAL SALUJA, AT. TELEPARA, BILASPUR,  
TASIL & DIST. - BILASPUR, CHATISGARH STATE,

NAME AND ADDRESS OF POWER OF ATTORNEY HOLDER:-

SRI. SATISH KUMAR CHHABRA, S/O. LATE KRISHNALAL CHHABRA,

GURUDWARA ROAD, WARD NO. 13, THANA - TELAIYA,

P.O. - JHUMRITELAIYA, DIST. - KODERMA.

NAME AND ADDRESS OF VENDEE:-

SMT. URMILA DEVI,

W/O. SRI. SANTOSH KUMAR AGARWAL,

MICA GALI, WARD NO.

P.O. - JHUMRITELAIYA, DIST. - KODERMA.

DETAILS OF THE SOLD LAND:-

IN VILLAGE - TELAIYA, THANA NO. 244, THANA - TELAIYA,

WARD NO. 12, JHUMRITELAIYA NAGAR PARISHAD,

DIST. - KODERMA, JHARKHAND STATE,

KHATA NO. 284.

PLOT NO. 7320 (PART), AREA - 2.28 DECIMALS, SHOWN IN RED COLOUR.

BOUNDARY OF THE SOLD LAND:-

NORTH - PLOT NO. 7320 (P), LAND OF SMT. SATNAM KAUR.

EAST - 16 FT. WIDE PCC ROAD.

SOUTH - LAND OF SRI. NUNMAN MODI.

WEST - PLOT NO. 7320 (P), LAND OF SRI. GURUCHARAN SINGH.

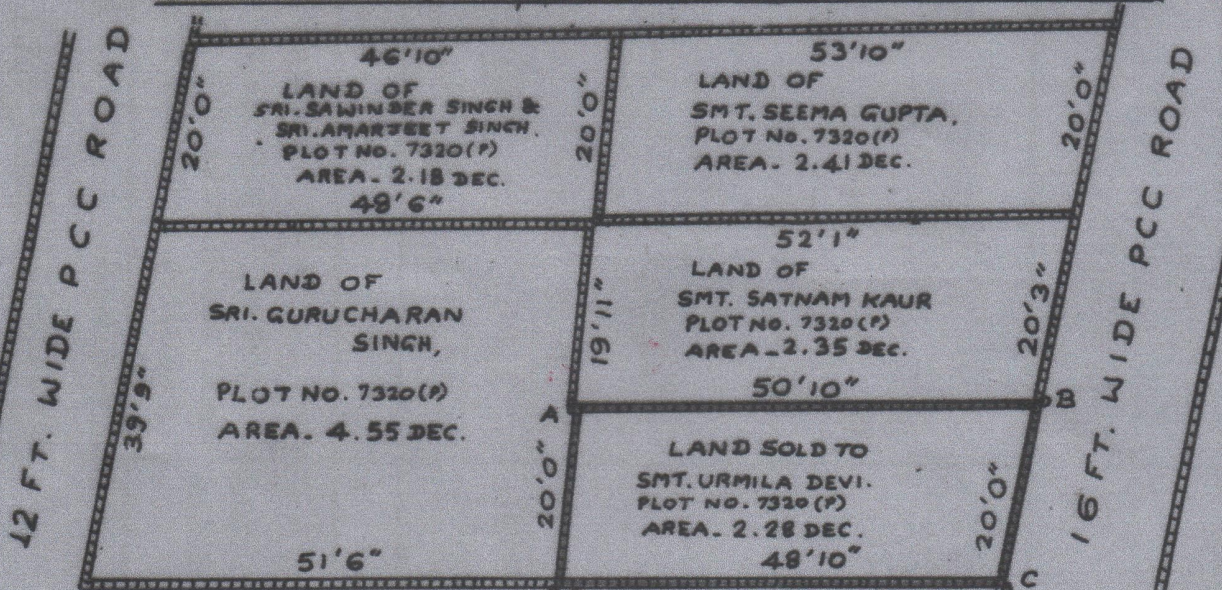

BUILDING OF SRI. SACHIN KUMAR GUPTA & VIKRAM KUMAR GUPTA

LAND OF NUNMAN MODI.

DIMENSION OF THE SOLD LAND:-

SCALE - 1 INCH = 20 FT.

A TO B - 50'10"

B TO C - 20'0"

C TO D - 48'10"

D TO A - 20'0"

SIGNATURE OF POWER OF ATTORNEY HOLDER

*(Signature)*  
21/12/2016

PLAN PREPARED BY - V.K. UNNEERI KUTTY SURVEYOR.

*31/12/16*  
*Self attested*