

NAME AND ADDRESS OF VENDOR

(1) SRI SUNIL KUMAR CHAWLA ALIAS SUNIL KUMAR SINGH

S/O LATE GIRDHAI SINGH

(2) SMT USHA CHAWLA ALIAS USHAKOUR

W/O SRI SUNIL KUMAR CHAWLA

AT + P.O - JHUMRI TELAIYA, WARD NO- , P.S.- TELAIYA,

DIST-KODERMA JHARKHAND

NAME AND ADDRESS OF VENDEE

SRI SHUBHAM KUMAR S/O LATE ANIL KUMAR

AT+P.O JHUMRI TELAIYA, ,OLD BUS STAND

P.S.- TELAIYA, DIST-KODERMA JHARKHAND

DETAILS OF THE LAND

IN VILLAGE TELAIYA, THANA. No- 244, WARD NO - 15

P.S.- TELAIYA. DIST- KODERMA, JHARKHAND

KHATA No - 382 LOT No 5541 SOLD AREA -2.29 DECIMALS

SHOWN IN RED COLOUR SCALE 1" = 15'ft

BOUNDARY OF THE LAND

NORTH-RENU SHARMA

SOUTH- SUNITA DEVI & LAVLY CHAWLA

EAST- 2'6" FEET WIDE LANE

WEST - 10'6" WIDE ROAD & ANITA DEVI

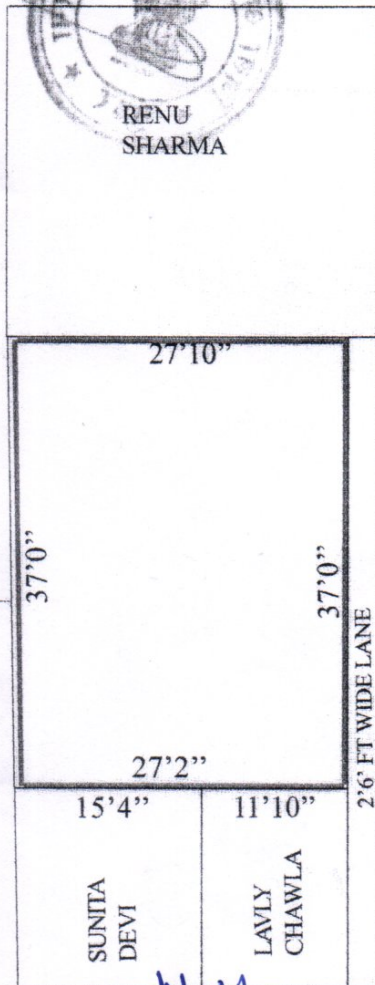

SIGN OF VENDOR
<i>[Handwritten signature]</i> 19.5.2023 382-5541
19.5.2023 DRAWN BY
<i>[Handwritten signature]</i>

[Handwritten signature]
Kumar