

NAME AND ADDRESS OF VENDERS :-

SRI SURESHCHAND JAIN S/o - LATE MOTI CHAND JAIN
AT - JHUMRI TELAIYA, P. O. - JHUMRI TELAIYA, WARD No -06,
P. S. - TELAIYA, DISTRICT - KODERMA

NAME AND ADDRESS OF VENDEE :-

1. SRI GOVIND YADAV S/o - SRI DHALO YADAV
 2. SRI PRAYAG PRASAD YADAV S/o - LATE CHOLO YADAV
VILLAGE - CHIGLABAR, P. O. - BEKOBAR, P. S. + DISTRICT - KODERMA.

DETAILS OF THE SOLD LAND :-

IN VILLAGE - MORIYAWA, P. S. No -02, PARGANA -GUMO
P. S. - TELAIYA, JHUMRI TEALAIYA MUNICIPALITY, WARD NO - 09,
DISTRICT - KODERMA, JHARKHAND STATE, SCALE - 1 INCH = 32FT.
KHATA NO - 04, PLOT NO - 119(PART).

SOLD AREA - 1558 SQ. FT. = 3.58 DECIMALS SHOWN IN RED COLOUR

BOUNDARY OF THE SOLD LAND :-

NORTH - SURVEY ROAD (TELAIYA - HIRODIH ROAD)
EAST - TODAY SOLD TO RAMCHANDRA YADAV & OTHERS (PLOT No - 119(P))
SOUTH - PLOT No - 120
WEST - LAND OF VENDOR(PART OF PLOT No - 119)

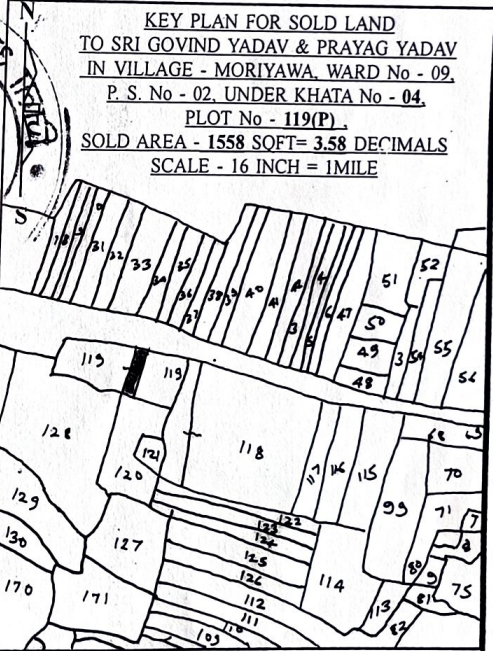
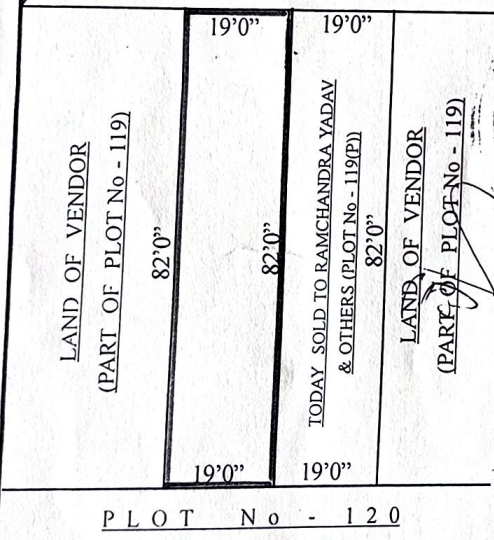
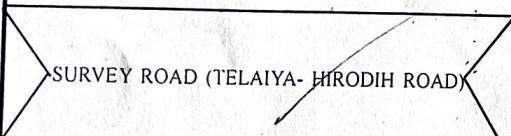

KEY PLAN FOR SOLD LAND
TO SRI GOVIND YADAV & PRAYAG YADAV
IN VILLAGE - MORIYAWA, WARD No - 09,
P. S. No - 02, UNDER KHATA No - 04,
PLOT No - 119(P).
SOLD AREA - 1558 SQFT= 3.58 DECIMALS
SCALE - 16 INCH = 1MILE

SIGN. VENDERS	
SIGN.	AMIN