

# Project Title: DEOSAGER BHAGET

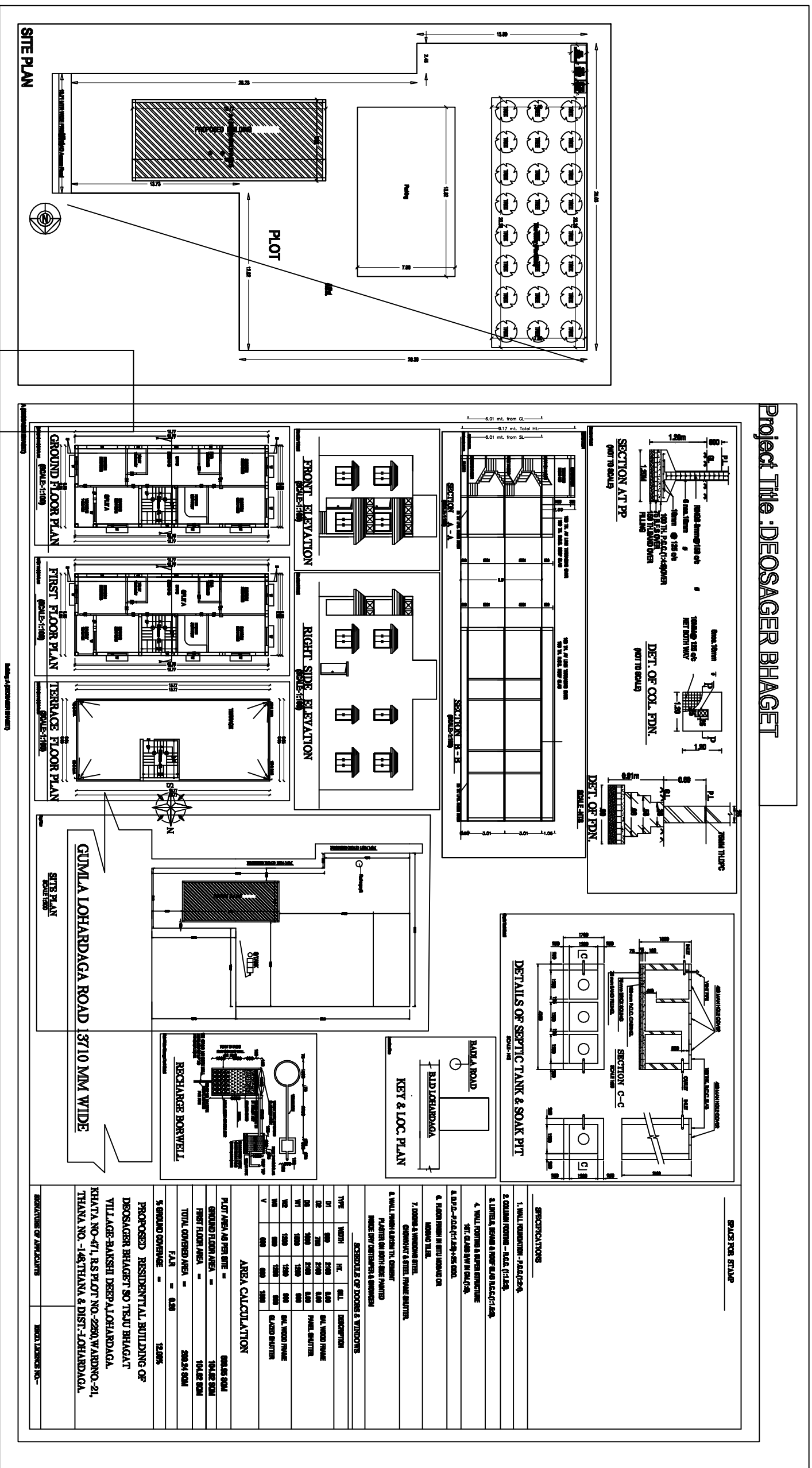

**Area of Construction Details**

Sl. No.	Particulars	Area (sq.m)	Volume (cu.m)
1	Ground Floor	100.00	100.00
2	First Floor	100.00	100.00
3	Terrace Floor	100.00	100.00
4	Walls	100.00	100.00
5	Roof	100.00	100.00
6	Columns	100.00	100.00
7	Beams	100.00	100.00
8	Stairs	100.00	100.00
9	Other	100.00	100.00
10	Total	1000.00	1000.00

**SPACES FOR STAMP**

**REGULATIONS**

1. WALL RATIO - 24/100
2. COLUMN ROOM - 1/2 (1/2)
3. LIMBA, BEAM & ROOF SLAB RATIO - 1/2
4. WALL RATIO & BEAM RATIO - 1/2
5. R/C - 1/2 (1/2)
6. FLOOR FINISH IN R/C ROOM ON ROOF TILE
7. ROOF & WINDOW STEEL CONCRETE & STEEL FRAME WALLS PLASTER ON BOTH SIDE FINISH ROOF FINISH & FINISH

**SCHEDULE OF DOORS & WINDOWS**

TYPE	WIDTH	HT.	QTY.	DESCRIPTION
D1	2100	2100	1.00	DOOR WOOD FRAME
D2	2100	2100	1.00	DOOR WOOD FRAME
D3	1500	2100	1.00	DOOR WOOD FRAME
D4	1500	2100	1.00	DOOR WOOD FRAME
D5	1500	2100	1.00	DOOR WOOD FRAME
D6	1500	2100	1.00	DOOR WOOD FRAME
D7	1500	2100	1.00	DOOR WOOD FRAME
D8	1500	2100	1.00	DOOR WOOD FRAME
D9	1500	2100	1.00	DOOR WOOD FRAME
D10	1500	2100	1.00	DOOR WOOD FRAME
D11	1500	2100	1.00	DOOR WOOD FRAME
D12	1500	2100	1.00	DOOR WOOD FRAME
D13	1500	2100	1.00	DOOR WOOD FRAME
D14	1500	2100	1.00	DOOR WOOD FRAME
D15	1500	2100	1.00	DOOR WOOD FRAME
D16	1500	2100	1.00	DOOR WOOD FRAME
D17	1500	2100	1.00	DOOR WOOD FRAME
D18	1500	2100	1.00	DOOR WOOD FRAME
D19	1500	2100	1.00	DOOR WOOD FRAME
D20	1500	2100	1.00	DOOR WOOD FRAME
D21	1500	2100	1.00	DOOR WOOD FRAME
D22	1500	2100	1.00	DOOR WOOD FRAME
D23	1500	2100	1.00	DOOR WOOD FRAME
D24	1500	2100	1.00	DOOR WOOD FRAME
D25	1500	2100	1.00	DOOR WOOD FRAME
D26	1500	2100	1.00	DOOR WOOD FRAME
D27	1500	2100	1.00	DOOR WOOD FRAME
D28	1500	2100	1.00	DOOR WOOD FRAME
D29	1500	2100	1.00	DOOR WOOD FRAME
D30	1500	2100	1.00	DOOR WOOD FRAME
D31	1500	2100	1.00	DOOR WOOD FRAME
D32	1500	2100	1.00	DOOR WOOD FRAME
D33	1500	2100	1.00	DOOR WOOD FRAME
D34	1500	2100	1.00	DOOR WOOD FRAME
D35	1500	2100	1.00	DOOR WOOD FRAME
D36	1500	2100	1.00	DOOR WOOD FRAME
D37	1500	2100	1.00	DOOR WOOD FRAME
D38	1500	2100	1.00	DOOR WOOD FRAME
D39	1500	2100	1.00	DOOR WOOD FRAME
D40	1500	2100	1.00	DOOR WOOD FRAME
D41	1500	2100	1.00	DOOR WOOD FRAME
D42	1500	2100	1.00	DOOR WOOD FRAME
D43	1500	2100	1.00	DOOR WOOD FRAME
D44	1500	2100	1.00	DOOR WOOD FRAME
D45	1500	2100	1.00	DOOR WOOD FRAME
D46	1500	2100	1.00	DOOR WOOD FRAME
D47	1500	2100	1.00	DOOR WOOD FRAME
D48	1500	2100	1.00	DOOR WOOD FRAME
D49	1500	2100	1.00	DOOR WOOD FRAME
D50	1500	2100	1.00	DOOR WOOD FRAME
D51	1500	2100	1.00	DOOR WOOD FRAME
D52	1500	2100	1.00	DOOR WOOD FRAME
D53	1500	2100	1.00	DOOR WOOD FRAME
D54	1500	2100	1.00	DOOR WOOD FRAME
D55	1500	2100	1.00	DOOR WOOD FRAME
D56	1500	2100	1.00	DOOR WOOD FRAME
D57	1500	2100	1.00	DOOR WOOD FRAME
D58	1500	2100	1.00	DOOR WOOD FRAME
D59	1500	2100	1.00	DOOR WOOD FRAME
D60	1500	2100	1.00	DOOR WOOD FRAME
D61	1500	2100	1.00	DOOR WOOD FRAME
D62	1500	2100	1.00	DOOR WOOD FRAME
D63	1500	2100	1.00	DOOR WOOD FRAME
D64	1500	2100	1.00	DOOR WOOD FRAME
D65	1500	2100	1.00	DOOR WOOD FRAME
D66	1500	2100	1.00	DOOR WOOD FRAME
D67	1500	2100	1.00	DOOR WOOD FRAME
D68	1500	2100	1.00	DOOR WOOD FRAME
D69	1500	2100	1.00	DOOR WOOD FRAME
D70	1500	2100	1.00	DOOR WOOD FRAME
D71	1500	2100	1.00	DOOR WOOD FRAME
D72	1500	2100	1.00	DOOR WOOD FRAME
D73	1500	2100	1.00	DOOR WOOD FRAME
D74	1500	2100	1.00	DOOR WOOD FRAME
D75	1500	2100	1.00	DOOR WOOD FRAME
D76	1500	2100	1.00	DOOR WOOD FRAME
D77	1500	2100	1.00	DOOR WOOD FRAME
D78	1500	2100	1.00	DOOR WOOD FRAME
D79	1500	2100	1.00	DOOR WOOD FRAME
D80	1500	2100	1.00	DOOR WOOD FRAME
D81	1500	2100	1.00	DOOR WOOD FRAME
D82	1500	2100	1.00	DOOR WOOD FRAME
D83	1500	2100	1.00	DOOR WOOD FRAME
D84	1500	2100	1.00	DOOR WOOD FRAME
D85	1500	2100	1.00	DOOR WOOD FRAME
D86	1500	2100	1.00	DOOR WOOD FRAME
D87	1500	2100	1.00	DOOR WOOD FRAME
D88	1500	2100	1.00	DOOR WOOD FRAME
D89	1500	2100	1.00	DOOR WOOD FRAME
D90	1500	2100	1.00	DOOR WOOD FRAME
D91	1500	2100	1.00	DOOR WOOD FRAME
D92	1500	2100	1.00	DOOR WOOD FRAME
D93	1500	2100	1.00	DOOR WOOD FRAME
D94	1500	2100	1.00	DOOR WOOD FRAME
D95	1500	2100	1.00	DOOR WOOD FRAME
D96	1500	2100	1.00	DOOR WOOD FRAME
D97	1500	2100	1.00	DOOR WOOD FRAME
D98	1500	2100	1.00	DOOR WOOD FRAME
D99	1500	2100	1.00	DOOR WOOD FRAME
D100	1500	2100	1.00	DOOR WOOD FRAME

**AREA CALCULATION**

Plot Area as per site	604.80 SQM
Ground Floor Area	104.80 SQM
First Floor Area	104.80 SQM
Terrace Floor Area	104.80 SQM
Total Covered Area	314.40 SQM
% Ground Coverage	52.00%

**PROPOSED RESIDENTIAL BUILDING OF DEOSAGER BHAGET SO TEJU BHAGAT VILLAGE-BAKSHI DEEPALOHARDAGA, KHATA NO-471, R/S PLOT NO-2250, WARDNO-21, THANA NO.-148 THANA & DIST-LOHARDAGA.**

**REGULATIONS OF APPLICABLE**

**COLON INDEX**

Sl. No.	Particulars	Area (sq.m)	Volume (cu.m)
1	Ground Floor	100.00	100.00
2	First Floor	100.00	100.00
3	Terrace Floor	100.00	100.00
4	Walls	100.00	100.00
5	Roof	100.00	100.00
6	Columns	100.00	100.00
7	Beams	100.00	100.00
8	Stairs	100.00	100.00
9	Other	100.00	100.00
10	Total	1000.00	1000.00