

Project Title : NIKHAT KHATOON

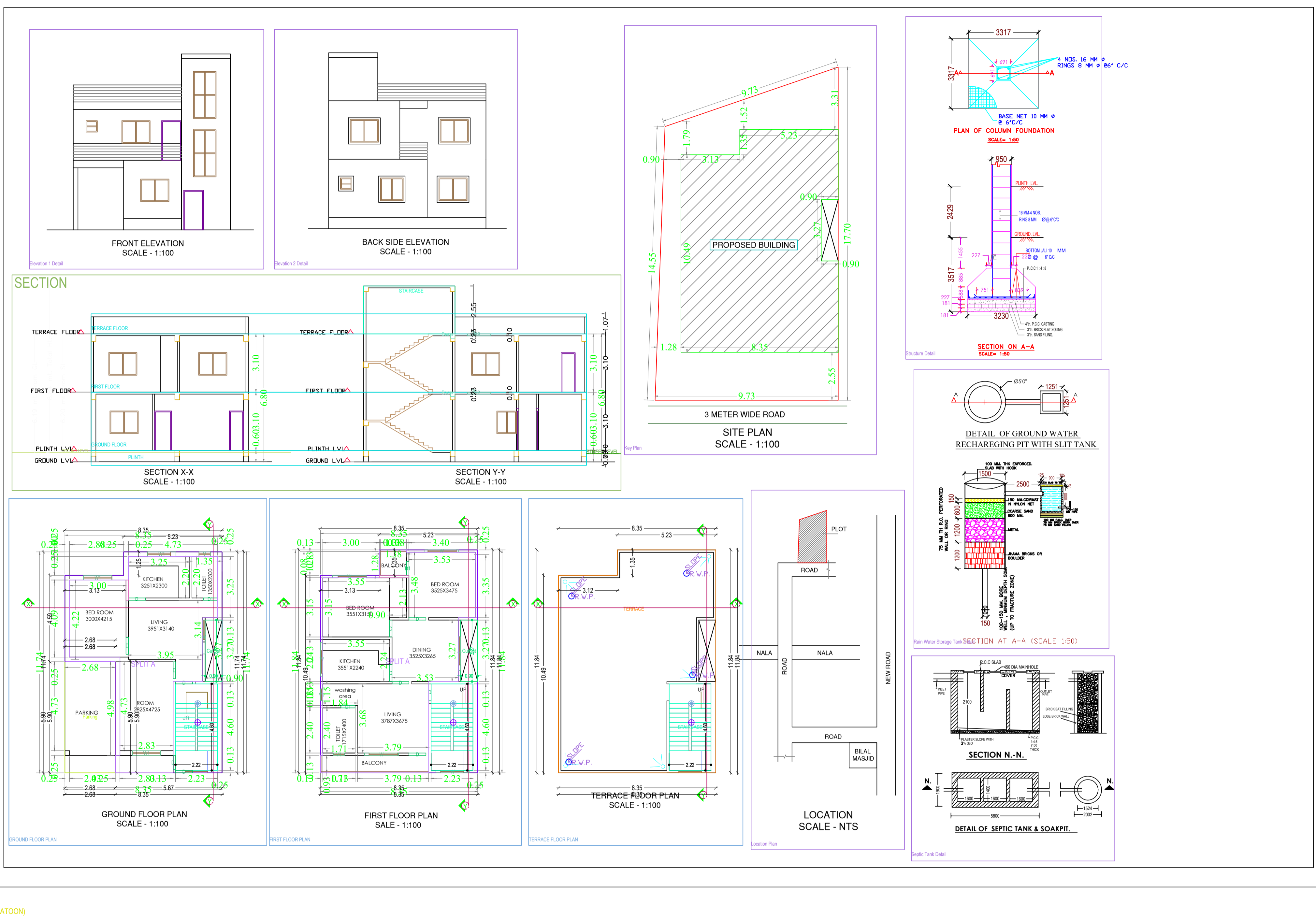

| AREA STATEMENT: LOHARDAGA NAGAR PARISHAD | | VERSION NO: 1.0.28 |
|--|---|--------------------------|
| PROJECT DETAIL: | | VERSION DATE: 16/10/2020 |
| Project No.: | Plot Use: Residential | |
| Region: LOHARDAGA | Plot Sub Use: Bungalow/ Dwelling/ Non Apartment | |
| Distric: LOHARDAGA | Land Use Zone: NA | |
| Application Type: General Proposal | Abutting Road Width: - | |
| Project Type: Building Permission | Plot No.: | |
| Nature of Development: New | Revenue Survey No/Survey No.: | |
| Location: OG Area | Thana No.: | |
| Sub Location: NA | Holding No.: | |
| Village/Mauza Name: - | Khata No.: | |
| Ward No.: | North.: | |
| Road/Street: - | South.: | |
| | East.: | |
| | West.: | |

| AREA DETAILS: | | SQ. MT. |
|--|----------------|---------|
| AREA OF PLOT (Minimum) | (A) | 152.10 |
| Net Plot Area (Gross Plot Area - Deduction from Gross Plot Area) | (A-Deductions) | 152.10 |
| Deductions for Balance Plot Area (from Gross Plot Area) | | |
| COP Area | | 21.43 |
| Total | | 21.43 |
| Balance Plot Area (Net Plot Area - Recreational/amenity space) | (A-Deductions) | 130.67 |
| Plot Area for Coverage (Net Plot Area) | (A-Deductions) | 152.10 |
| Plot Area for FSI (Net Plot Area + Road/Widening Area) | (A-Deductions) | 152.10 |
| Accessory Use Area | | 0.91 |
| COVERARGE CHECK | | |
| Proposed Coverage Area (59.96 %) | | 91.20 |
| Total Coverage Area (59.96 %) | | 91.20 |
| FAR CHECK | | |
| Proposed Area of FAR | | 167.13 |
| Total Area of FAR | | 167.13 |
| BUILT UP AREA CHECK | | |
| Total Proposed BuiltUp Area | | 152.92 |
| ARCH/ENGG/ SUPERVISOR (Regd) | OWNER | |
| DEVELOPMENT AUTHORITY | LOCAL BODY | |

| COLOR INDEX | |
|-------------------------------|--------|
| Plot Boundary | Black |
| Abutting Road | Red |
| Proposed Work (Coverage Area) | Green |
| Existing (To be retained) | Blue |
| Existing (To be demolished) | Yellow |

| PARKING CALCULATION: | | |
|----------------------|----------|-----------|
| Parking Type | Prop No. | Prop Area |
| Other Parking | 1 | 15.79 |
| Total Area | 1 | 15.79 |

| MARGIN DETAIL: | | | | | | |
|----------------------|-------------------------------|--------------|-------------|--------------|--------------|--|
| Building / Wing Name | Road Name | Front Margin | Rear Margin | Side1 Margin | Side2 Margin | |
| A-1 (NIKHAT KHATOON) | 3.0 MTR WIDE ROAD Access Road | 2.55 | 1.53 | 0.90 | 0.00 | |

| FAR & Tenement Details (Table 4c-1) | | | | | | | | |
|-------------------------------------|------------------|------------------------------|---|------------------------------|-----------------------------|----------------------------|-------------------------|--------------|
| Building | No. of Same Bldg | Gross Built Up Area (Sq.mt.) | Deductions From Gross BUA/Area in Sq.mt.) | Total Built Up Area (Sq.mt.) | Deductions (Area in Sq.mt.) | Proposed FAR Area (Sq.mt.) | Total FAR Area (Sq.mt.) | Tenent (No.) |
| A (NIKHAT KHATOON) | 1 | 188.80 | 5.88 | 182.92 | 15.79 | 167.13 | 167.13 | 01 |
| Grand Total: | 1 | 188.80 | 5.88 | 182.92 | 15.79 | 167.13 | 167.13 | 01 |

| Building A (NIKHAT KHATOON) | | | | | | | |
|--------------------------------|--------------------|---|------------------------------|-----------------------------|----------------------------|-------------------------|--------------|
| Floor Name | Gross Builtup Area | Deductions From Gross BUA/Area in Sq.mt.) | Total Built Up Area (Sq.mt.) | Deductions (Area in Sq.mt.) | Proposed FAR Area (Sq.mt.) | Total FAR Area (Sq.mt.) | Tenent (No.) |
| Ground Floor | 94.14 | 2.94 | 91.20 | 15.79 | 75.41 | 75.41 | 01 |
| First Floor | 94.66 | 2.94 | 91.72 | 0.00 | 91.72 | 91.72 | 00 |
| Terrace Floor | 0.00 | 0.00 | 0.00 | 0.00 | 0.00 | 0.00 | 00 |
| Total | 188.80 | 5.88 | 182.92 | 15.79 | 167.13 | 167.13 | 01 |
| Total Number of Same Buildings | 1 | | | | | | |
| Total | 188.80 | 5.88 | 182.92 | 15.79 | 167.13 | 167.13 | 01 |

| SCHEDULE OF JOINERY: | | | | |
|----------------------|------|--------|--------|-----------|
| BUILDING NAME | NAME | LENGTH | HEIGHT | NOS |
| A (NIKHAT KHATOON) | D1 | 0.75 | 2.13 | 04 |
| A (NIKHAT KHATOON) | D | 0.90 | 2.13 | 11 |
| Total | - | - | - | 15 |

| SCHEDULE OF JOINERY: | | | | |
|----------------------|------|--------|--------|-----------|
| BUILDING NAME | NAME | LENGTH | HEIGHT | NOS |
| A (NIKHAT KHATOON) | V | 0.60 | 1.00 | 01 |
| A (NIKHAT KHATOON) | V1 | 0.60 | 1.00 | 02 |
| A (NIKHAT KHATOON) | W1 | 1.50 | 2.70 | 03 |
| A (NIKHAT KHATOON) | W | 1.80 | 2.70 | 07 |
| Total | - | - | - | 13 |

| UnitBUA Table for Building A (NIKHAT KHATOON) | | | | | | |
|---|---------|--------------|---------------|---------------|--------------|-----------------|
| FLOOR | Name | UnitBUA Type | UnitBUA Area | Carpet Area | No. of Rooms | No. of Tenement |
| GROUND FLOOR PLAN | SPLIT A | FLAT | 132.16 | 131.83 | 6 | 1 |
| Total | - | - | 132.16 | 131.83 | 14 | 1 |