

Project Title :SRI RAMSWARATH SAHU

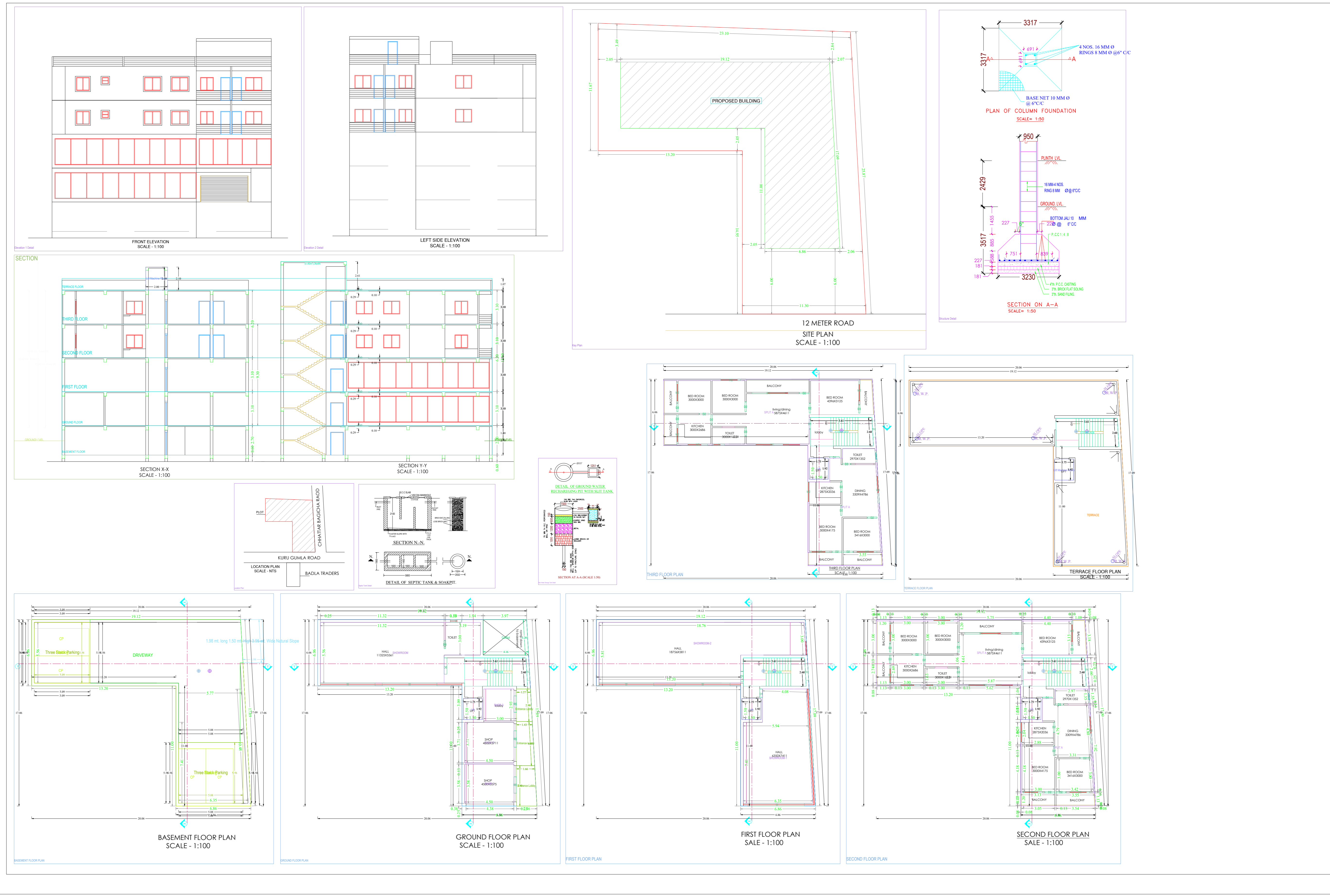

SITE PLAN

Building A (SRI RAMSWARATH SAHU)

| Area | Code | Area (Sq.m) | Volume (Cu.m) | Weight (Kgs) | Value (Rs) | Rate (Rs/Sq.m) |
|-------|------|-------------|---------------|--------------|------------|----------------|
| Total | | 13.21 | 28.07 | 88.38 | 47.75 | 3.57 |

SCHEDULE OF JOINTS:

| Joint Name | Code | Area (Sq.m) | Volume (Cu.m) | Weight (Kgs) | Value (Rs) | Rate (Rs/Sq.m) |
|------------|------|-------------|---------------|--------------|------------|----------------|
| Vertical | V1 | 1.2 | 2.7 | 8.4 | 4.5 | 3.75 |
| Horizontal | H1 | 0.8 | 1.8 | 5.6 | 3.0 | 3.75 |

UPPER Table for Building A (SRI RAMSWARATH SAHU)

| Item | Code | Area (Sq.m) | Volume (Cu.m) | Weight (Kgs) | Value (Rs) | Rate (Rs/Sq.m) |
|-------|------|-------------|---------------|--------------|------------|----------------|
| UPPER | U1 | 1.2 | 2.7 | 8.4 | 4.5 | 3.75 |

GENERAL NOTES

1. The drawings are prepared in accordance with the provisions of Indian Standards.
2. The scale of the drawings shall be 1:100 for the site plan and 1:50 for the floor plans and sections.
3. The contractor shall be responsible for the execution of the works in accordance with the drawings and specifications.
4. The contractor shall provide all the necessary materials and labor for the execution of the works.
5. The contractor shall be responsible for the safety of the workers and the public during the execution of the works.

COLOR INDEX

| Color | Material |
|-------|----------|
| Red | Concrete |
| Blue | Steel |
| Green | Paint |
| Black | Text |

PARKING CALCULATION

| Category | No. of Vehicles | Area (Sq.m) |
|----------|-----------------|-------------|
| Total | 15 | 150 |

MARGIN DETAIL

| Margin | Width (m) |
|--------|-----------|
| Front | 3.00 |
| Side | 2.25 |
| Back | 2.25 |

BASEMENT MARGIN DETAIL

| Margin | Width (m) |
|--------|-----------|
| Front | 3.00 |
| Side | 2.25 |
| Back | 2.25 |

PAV & Trenching Details (Table A-1)

| Item | Code | Area (Sq.m) | Volume (Cu.m) | Weight (Kgs) | Value (Rs) | Rate (Rs/Sq.m) |
|------|------|-------------|---------------|--------------|------------|----------------|
| PAV | P1 | 1.2 | 2.7 | 8.4 | 4.5 | 3.75 |