

- SPECIFICATIONS**
1. FOUNDATION- 150MM THICK P.C.C OVER BRICK SOLING OVER THICK SAND FILLING
 2. BRICK WORK- BRICK WORK IN CEMENT MORTAR WITH FIRST BRICK
 3. INTEL- 150MM THICK R.C.C INTEL
 4. ROOFING- 50MM THICK LIME TERRACING OVER 100MM THICK ROOF SLAB
 5. FLOORING- 25MM THICK MARBLE FLOOR OVER 100MM THICK RAMMED KHOA
 6. PLASTER- 12MM THICK CEMENT PLASTER ON INTERNAL WALL 15MM THICK ON EXTERNAL WALLS OF BUILDING. EXTERIOR PAINT ON EXTERIOR FINISH AND WASHABLE ACRYLIC PAINT OVER PUTTY ON INTERIOR FINISH.

AREA CALCULATION

TOTAL SITE AREA	423.26 Sq.m / 4555 Sq.ft.)
BUILT UP AREA	168.78 Sq.m (1816 Sq.ft.) - GROUND FLOOR
	168.78 Sq.m (1816 Sq.ft.) - TOTAL BUILT-UP AREA
GROUND COVERAGE	168.78 X 100 = 39%
	423.23
F.A.R. =	141.81 = 0.39
	404.68

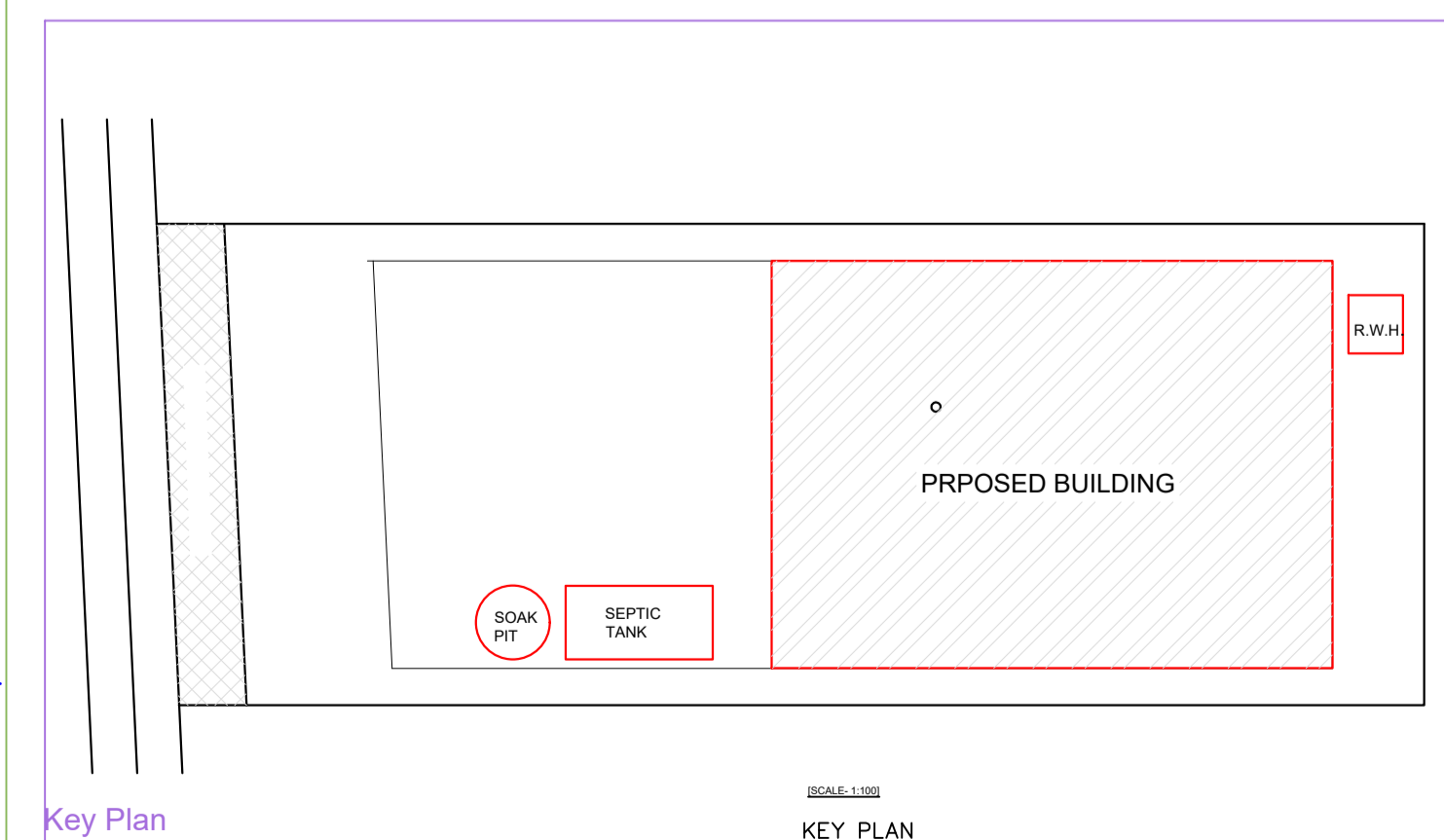
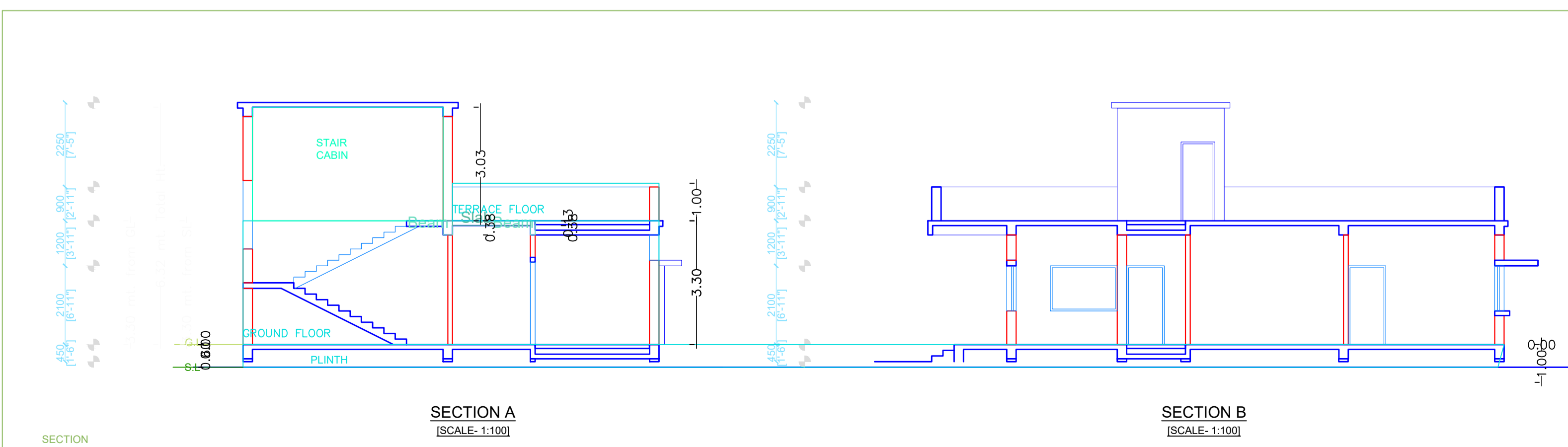

PROPOSED G+0 RESIDENTIAL BLOCK AT MADHUBAN LOHARDAGA JHARKHAND

FOR :
MRS. SILMANTI EKKA
W/D MR. RABINDRA EKKA
PLOT NO. - 958/2544
KHATA NO.- 67, 306
THANA NO. -194

DRAWING NAME :
SUBMISSION DRAWING

SHEET NO.	SHEET SIZE	ARCHITECT:
1	A1	

ALL DIMENSIONS IN MM SCALE - AS MENTIONED