

Project Title :SMT REKHA DEVI

FRONT ELEVATION
Scale-1:100

RIGHT SIDE ELEVATION
Scale-1:100

SECTION
SECTION-1:1
Scale-1:100

SECTION-2:2
Scale-1:100

SITE PLAN
Scale-1:100

4.5 METER WIDE ROAD

TERRACE FLOOR PLAN
Scale-1:100

GROUND FLOOR PLAN
Scale-1:100

FRONT SECTION PLAN
Scale-1:100

SITE PLAN

Building A (SMT REKHA DEVI)

SCHEDULE OF JOINTS

| NO. | TYPE | LOCATION | DETAIL |
|-----|------------|--------------------------|----------|
| 1 | Vertical | Column to Slab | Detail A |
| 2 | Horizontal | Slab to Slab | Detail B |
| 3 | Vertical | Column to Column | Detail C |
| 4 | Horizontal | Beam to Beam | Detail D |
| 5 | Vertical | Column to Foundation | Detail E |
| 6 | Horizontal | Foundation to Foundation | Detail F |
| 7 | Vertical | Column to Wall | Detail G |
| 8 | Horizontal | Wall to Wall | Detail H |
| 9 | Vertical | Column to Terrace | Detail I |
| 10 | Horizontal | Terrace to Terrace | Detail J |

SCHEDULE OF JOINTS

| NO. | TYPE | LOCATION | DETAIL |
|-----|------------|--------------------------|----------|
| 1 | Vertical | Column to Slab | Detail A |
| 2 | Horizontal | Slab to Slab | Detail B |
| 3 | Vertical | Column to Column | Detail C |
| 4 | Horizontal | Beam to Beam | Detail D |
| 5 | Vertical | Column to Foundation | Detail E |
| 6 | Horizontal | Foundation to Foundation | Detail F |
| 7 | Vertical | Column to Wall | Detail G |
| 8 | Horizontal | Wall to Wall | Detail H |
| 9 | Vertical | Column to Terrace | Detail I |
| 10 | Horizontal | Terrace to Terrace | Detail J |

REFERENCES AND STANDARDS

| | |
|---------------|---|
| IS 456:2000 | Code of Practice for Plain Concrete and Reinforced Concrete |
| IS 800:2008 | Code of Practice for Steel Structures |
| IS 10262:2009 | Concrete Mix Proportions for Normal Strength Concrete |
| IS 17733:2017 | Code of Practice for Reinforced Concrete Structures |
| IS 1893:2015 | Code of Practice for Earthquake Resistant Design and Construction |
| IS 2040:2017 | Code of Practice for Reinforced Concrete Structures |
| IS 2041:2017 | Code of Practice for Reinforced Concrete Structures |
| IS 2042:2017 | Code of Practice for Reinforced Concrete Structures |
| IS 2043:2017 | Code of Practice for Reinforced Concrete Structures |
| IS 2044:2017 | Code of Practice for Reinforced Concrete Structures |
| IS 2045:2017 | Code of Practice for Reinforced Concrete Structures |
| IS 2046:2017 | Code of Practice for Reinforced Concrete Structures |
| IS 2047:2017 | Code of Practice for Reinforced Concrete Structures |
| IS 2048:2017 | Code of Practice for Reinforced Concrete Structures |
| IS 2049:2017 | Code of Practice for Reinforced Concrete Structures |
| IS 2050:2017 | Code of Practice for Reinforced Concrete Structures |
| IS 2051:2017 | Code of Practice for Reinforced Concrete Structures |
| IS 2052:2017 | Code of Practice for Reinforced Concrete Structures |
| IS 2053:2017 | Code of Practice for Reinforced Concrete Structures |
| IS 2054:2017 | Code of Practice for Reinforced Concrete Structures |
| IS 2055:2017 | Code of Practice for Reinforced Concrete Structures |
| IS 2056:2017 | Code of Practice for Reinforced Concrete Structures |
| IS 2057:2017 | Code of Practice for Reinforced Concrete Structures |
| IS 2058:2017 | Code of Practice for Reinforced Concrete Structures |
| IS 2059:2017 | Code of Practice for Reinforced Concrete Structures |
| IS 2060:2017 | Code of Practice for Reinforced Concrete Structures |
| IS 2061:2017 | Code of Practice for Reinforced Concrete Structures |
| IS 2062:2017 | Code of Practice for Reinforced Concrete Structures |
| IS 2063:2017 | Code of Practice for Reinforced Concrete Structures |
| IS 2064:2017 | Code of Practice for Reinforced Concrete Structures |
| IS 2065:2017 | Code of Practice for Reinforced Concrete Structures |
| IS 2066:2017 | Code of Practice for Reinforced Concrete Structures |
| IS 2067:2017 | Code of Practice for Reinforced Concrete Structures |
| IS 2068:2017 | Code of Practice for Reinforced Concrete Structures |
| IS 2069:2017 | Code of Practice for Reinforced Concrete Structures |
| IS 2070:2017 | Code of Practice for Reinforced Concrete Structures |
| IS 2071:2017 | Code of Practice for Reinforced Concrete Structures |
| IS 2072:2017 | Code of Practice for Reinforced Concrete Structures |
| IS 2073:2017 | Code of Practice for Reinforced Concrete Structures |
| IS 2074:2017 | Code of Practice for Reinforced Concrete Structures |
| IS 2075:2017 | Code of Practice for Reinforced Concrete Structures |
| IS 2076:2017 | Code of Practice for Reinforced Concrete Structures |
| IS 2077:2017 | Code of Practice for Reinforced Concrete Structures |
| IS 2078:2017 | Code of Practice for Reinforced Concrete Structures |
| IS 2079:2017 | Code of Practice for Reinforced Concrete Structures |
| IS 2080:2017 | Code of Practice for Reinforced Concrete Structures |
| IS 2081:2017 | Code of Practice for Reinforced Concrete Structures |
| IS 2082:2017 | Code of Practice for Reinforced Concrete Structures |
| IS 2083:2017 | Code of Practice for Reinforced Concrete Structures |
| IS 2084:2017 | Code of Practice for Reinforced Concrete Structures |
| IS 2085:2017 | Code of Practice for Reinforced Concrete Structures |
| IS 2086:2017 | Code of Practice for Reinforced Concrete Structures |
| IS 2087:2017 | Code of Practice for Reinforced Concrete Structures |
| IS 2088:2017 | Code of Practice for Reinforced Concrete Structures |
| IS 2089:2017 | Code of Practice for Reinforced Concrete Structures |
| IS 2090:2017 | Code of Practice for Reinforced Concrete Structures |
| IS 2091:2017 | Code of Practice for Reinforced Concrete Structures |
| IS 2092:2017 | Code of Practice for Reinforced Concrete Structures |
| IS 2093:2017 | Code of Practice for Reinforced Concrete Structures |
| IS 2094:2017 | Code of Practice for Reinforced Concrete Structures |
| IS 2095:2017 | Code of Practice for Reinforced Concrete Structures |
| IS 2096:2017 | Code of Practice for Reinforced Concrete Structures |
| IS 2097:2017 | Code of Practice for Reinforced Concrete Structures |
| IS 2098:2017 | Code of Practice for Reinforced Concrete Structures |
| IS 2099:2017 | Code of Practice for Reinforced Concrete Structures |
| IS 2100:2017 | Code of Practice for Reinforced Concrete Structures |

COLOR INDEX

| | |
|--------|------------------|
| Red | Structural Steel |
| Blue | Reinforcement |
| Green | Formwork |
| Yellow | Other |

MARKING CALCULATION

| | | | |
|---------|---------|---------|---------|
| MARKING | MARKING | MARKING | MARKING |
| MARKING | MARKING | MARKING | MARKING |
| MARKING | MARKING | MARKING | MARKING |
| MARKING | MARKING | MARKING | MARKING |

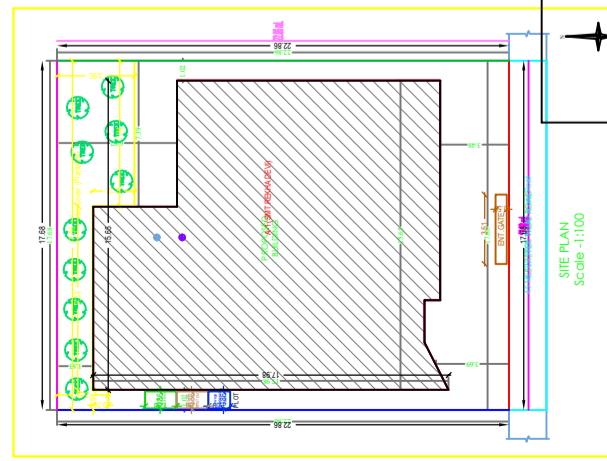

SITE PLAN