

STRUCTURAL SAFETY CERTIFICATE:-

THIS IS TO CERTIFY THAT THE STRUCTURAL DESIGN OF APPT. SHALL CONSIDER ALL DESIGN STANDARD & STRUCTURAL SAFETY REQUIREMENTS, AS PER THE PROVISION OF N.B.C. & I.S. CODE (I.S. 1903:1984 & I.S. 4320:1993) TO MAKE THE SAME EARTH QUAKE RESISTANT

GENERAL SPECIFICATION :-

- 1.FOUNDATION:- R.C.C. Footing in M 20 Mix & H.Y.S.D. Rein. as per design.
- 2.STRUCTURE:- Column, Beams, Lintel, Slabs, Stairs etc. shall be in M-30 Concrete & H.Y.S.D. Reinforcement as per Design.
- 3.SUPER STR.- 1st. Class Bricks in 1:4 C/M for single B.W. & 1:6 C/M For Double Brick work.
- 4.PLASTER:- 20mm th. Exterior plaster in 1:6 C/M, 12mm th. Interior plaster in 1:6 C/M & 6mm th. Paper in 1:4 C/M over R.C.C.
- 5.FLOORING:- I.P.S. Flooring in Parking Area, Marble Flooring in Kitchen & Hall & Mosaic Tile Flooring in all Rooms & Lobby.
- 6.PAINTING:- Two coats of Cement based Water Proofing Paint over Exterior surfaces, Two coats of O.S.B.I. over interior wall. Enamel Paint over priming coat on Doors, Windows & Grills etc.
- 7.WATER PROOFING:- Approved quality of Water Proofing Treatment over Terrace Floor & Down Sill.

AMENITIES CALCULATION:-

SEPTIC TANK:-

Total No. of Occupants in Apartment = 6X5 = 30 Nos.
 Assuming waste accumulation of 5.10 cum (cumulated) 1000 cum/year
 Therefore Capacity of Septic Tank Required = 30 x 0.10 = 3.0 cum.

Assuming Clearing Period of 4 Year, therefore
 Max. Capacity of Septic Tank Required = 6 x 3.0 = 18.0 cum.
 Capacity of Septic Tank Provided = 5.34 x 0.64 x 2.40 = 21.01 cum.
 Considering Free Board of 0.30 m, therefore
 Hence Dimensions of Septic Tank = L= 5.80 m, B= 2.10m, H= 2.80m

OVER HEAD WATER TANK:-

Total No. of Occupants in Apartment = 6X5 = 30 Nos.
 Assuming Water Consumption of 135 lit/cap/day, therefore
 Total Capacity of Water Tank Required = 30 x 135 = 4050 Lit or 4.05 cum.
 Total Capacity of Water Tank Provided (inner dia = 3.13 x 2.41 x 1.1 = 13.57 cum
 Considering Free Board of 0.30 m, therefore
 Outer Dimension of Water Tank Provided (L=3.61m, B=2.89m, H=2.1m)
 The O.H. Tank shall be Provided over staircase Mump & Free Storage Capacity to fulfill the Water Requirement for 3.35 Days.

PARKING AREA CALCULATION:-

Assuming concrete total Area of Dwelling Units.
 The Carpet Area of All Units are More than 50sqm
 Therefore total no. of Car Parking Required = 6 x 1 = 6 Nos.
 Total Parking Area Required (incl. driveway) = 6 x 20 = 120sqm
 Total Parking Area Provided on Gr. Floor = 377.06sqm
 Total no. of Car Parking Provided = 19 Nos.

STATEMENT OF AREA :-

FLOOR	AREA	PROJ. AREA	PARKING	LIFT, STAIR, CUT	AREA FOR F.A.R.
BASEMENT	448.536	---	428.245	---	=20.291 Sqm
GR. FLOOR	448.536	---	---	31.544	=416.992 Sqm
1st. FLOOR	448.536	---	---	31.544	=416.992 Sqm
2nd. FLOOR	448.536	---	---	31.544	=416.992 Sqm
3rd. FLOOR	448.536	---	---	31.544	=416.992 Sqm
TOTAL	=2242.68	---	428.245	126.176	=1688.259 Sqm

1. PARKING AREA ON BASEMENT FLOOR=428.245 Sqm
 2. BUILT UP AREA ON GR. FLOOR=416.992 Sqm
 3. TOTAL BUILT UP AREA FOR B+G+3=1688.259 Sqm
 4. TOTAL PLOT AREA = 685.835sqm
 6. GR. COV. = (60.80% of Plot Area)
 7. F. A. R. ACHIEVED = 2.486

SCHEDULE OF OPENING :-

S.NO.	TYPE	SIZE (in mm)	DESCRIPTION
DOORS:-			
1.	D-1	1050 X 2100	M.S. COLD PRESSED FRAMES & FLUSH DOORS
2.	D-2	800 X 2100	
3.	D-3	750 X 2100	
WINDOWS:-			
1.	W-1	1800 X 1800	M.S. Z SECTION FRAMED PANNELL & GLAZED WINDOWS
2.	W-2	1350 X 1200	
3.	W-3	800 X 1200	
VENTILATORS:-			
5.	V-1	750 X 750	M.S. ANGLE FRAMED & GLASS LOUVERED VENTILATORS

SCALES
 Plans, Etc. & Sec. > 1:100
 Site & Drain Plan > 1:200
 Foundation & I.C. > 1:25
 Septic Tank, soak pit & Rech Well - 1:50

NOTES
 ALL DIMENSIONS ARE IN METER UNLESS MENTIONED OTHERWISE

PROPOSED COMMERCIAL BUILDING OF SMT. MANJU JAISWAL W/O SATISH KUMAR JAISWAL VILLAGE -MISSION CHOWK, WARD NO-22, THANA NO- 194, KHATA NO -139 &305, PLOT NO -1249&1264, THANA -LOHARDAGA, DIST-LOHARDAGA, (JHARKHAND)

SHEET NO.-1

Sig. of Landowner/AttorneyHolder Sig. of Licenced Engg.

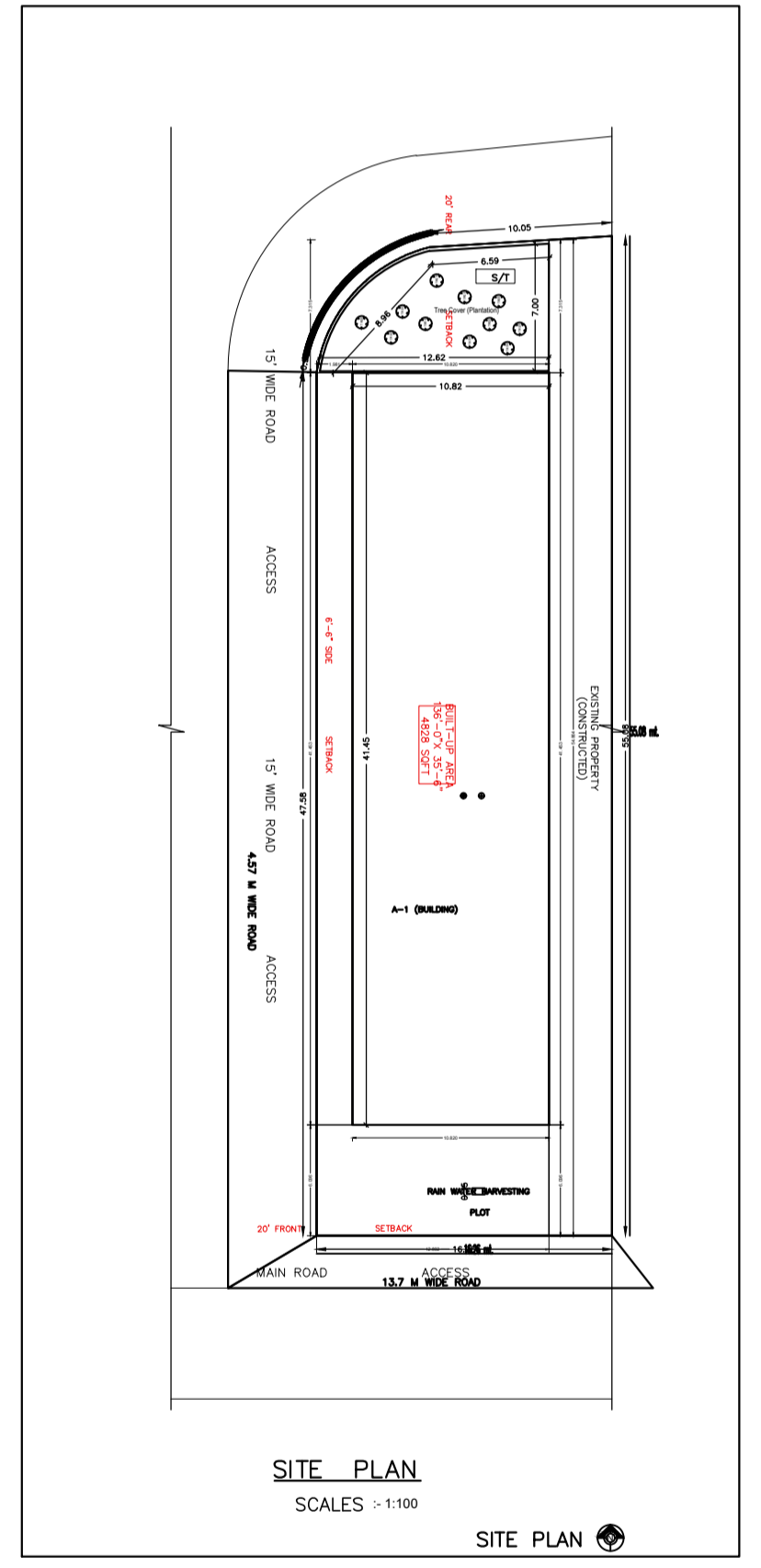

NO.	REVISION	DATE	BY	CHKD.

NO.	REVISION	DATE	BY	CHKD.