

VILLAGE - KUTMU , THANA NO - 141 , SHEET NO - 02, CIRCLE - LOHARDAGA, DISTRICT - LOHARDAGA ,
 SESSON - 1931 - 32 ACQUIRED AREA SHOW IN RED WASH



SESSION 1931-32
 SCALE - 16" = 1 MILE

S. NO	KHATA NO	PLQT NO	TOTAL AREA in plot	ACQUIRED AREA in plot
	OLD	OLD		
1	53	834 acre	5.6 DISMIL.



BOUNDARY :-
 NORTH - part of plot - 834
 SOUTH - plot no - 818/1261
 EAST - part of plot no - 834
 WEST - plot no - 818/1260

① Sanjiv Kishore Verma

Traced by
 Vibram Kany
 14/04/2023

② Rajeev Kishore Verma

VILLAGE - KUTMU , THANA NO - 141 , SHEET NO - 02, CIRCLE - LOHARDAGA, DISTRICT - LOHRDAGA ,
 SESSON -1931 - 32 ACQUIRED AREA SHOW IN RED
 WASH



SESSION 1931-32
 SCALE -16" = 1MILE

S. NO	KHATA NO	PLOT NO	TOTAL AREA in plot	ACQUIRED AREA in plot
	OLD	OLD		
1	53	834 acre	5.6 DISMIL

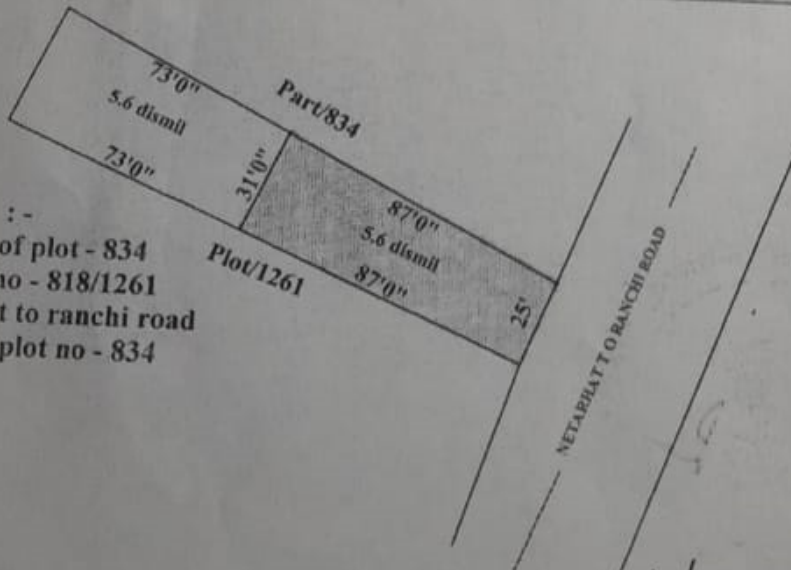

BOUNDARY :-
 NORTH - part of plot - 834
 SOUTH - plot no - 818/1261
 EAST - netarhat to ranchi road
 WEST - part of plot no - 834

Inspected by
 Vikram K. Singh
 14/06/2033

Sanjiv Kishore Verma

Rajendra Singh Verma