

Plot  
176  
P

AREA  
0.04



PART SKETCH MAP OF  
VILLAGE - BARIA THANA -  
MEDININAGAR THANA - 197  
DISTRICT - PALAMAU

NOTE: (1) :- Purchase deed shown  
in Red color

VENDOR: Sri Bharat Sahu s/o Late  
Ram Rai Sahu Residence  
Muhalla - Hamidganj P.S + P.O.  
Medininagar District - Palamau  
(2) Smt Chinta Devi w/o Sri Bharat  
Sahu Residence - Muhalla -  
Hamidganj P.S + P.O. Medininagar  
District - Palamau.

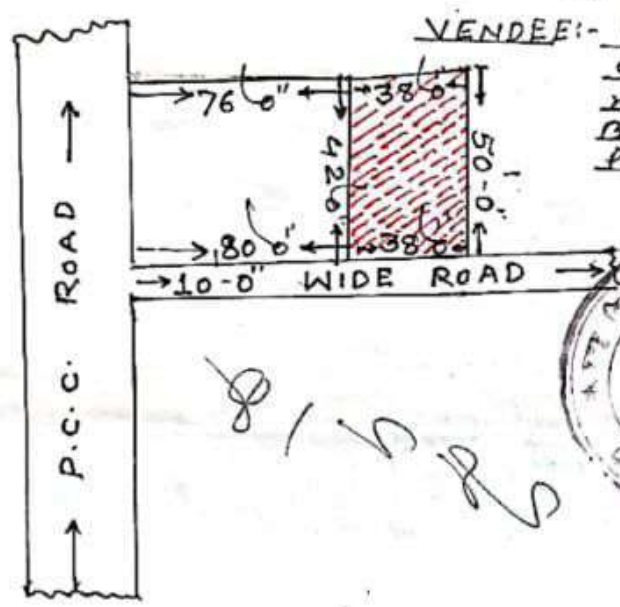

VENDEE: - Kumari Vidaya Singh w/o  
Sri Manish Kumar Singh Reside  
nce Village - Bahadur P.O.  
Bahadur P.S. - Pipra District  
Palamau.

Boundries

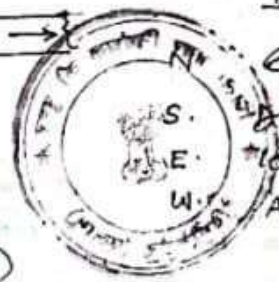

Gudia Gupta  
Bharmandra K. Singh  
10-0" wide road  
W/o AJAY SINGH.

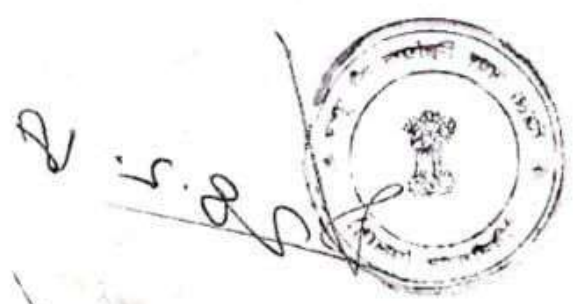

R. S. Ravey  
25/02/18  
Amin.