

PART NORTH MAP OF VILLAGE BASHATI THANA DIST GORWA
 THANA NO. 102 OF DIST GORWA
 NAME OF VENDOR - DASHRATH RAM
 ADDRESS - W/O LATE DASHRATH RAM
 P.O. - JALHARA DIST GORWA

NAME OF PURCHASER - SRI RAT PATI
 ADDRESS - W/O SRI NARAYAN RAM
 VILL. CHHAPARJAGGA P.O. BHIKHANI
 THANA - GORWA DIST - GORWA

BOUNDARY -
 N - LAND OF BASHATI-DEVI
 S - LAND OF SAHAR
 E - LAND OF KANAL
 W - 16' WIDE PRIVATE ROAD
 PURCHASED LAND IS SHOWN IN RED LINE

LAND OF HOUSING COLONY

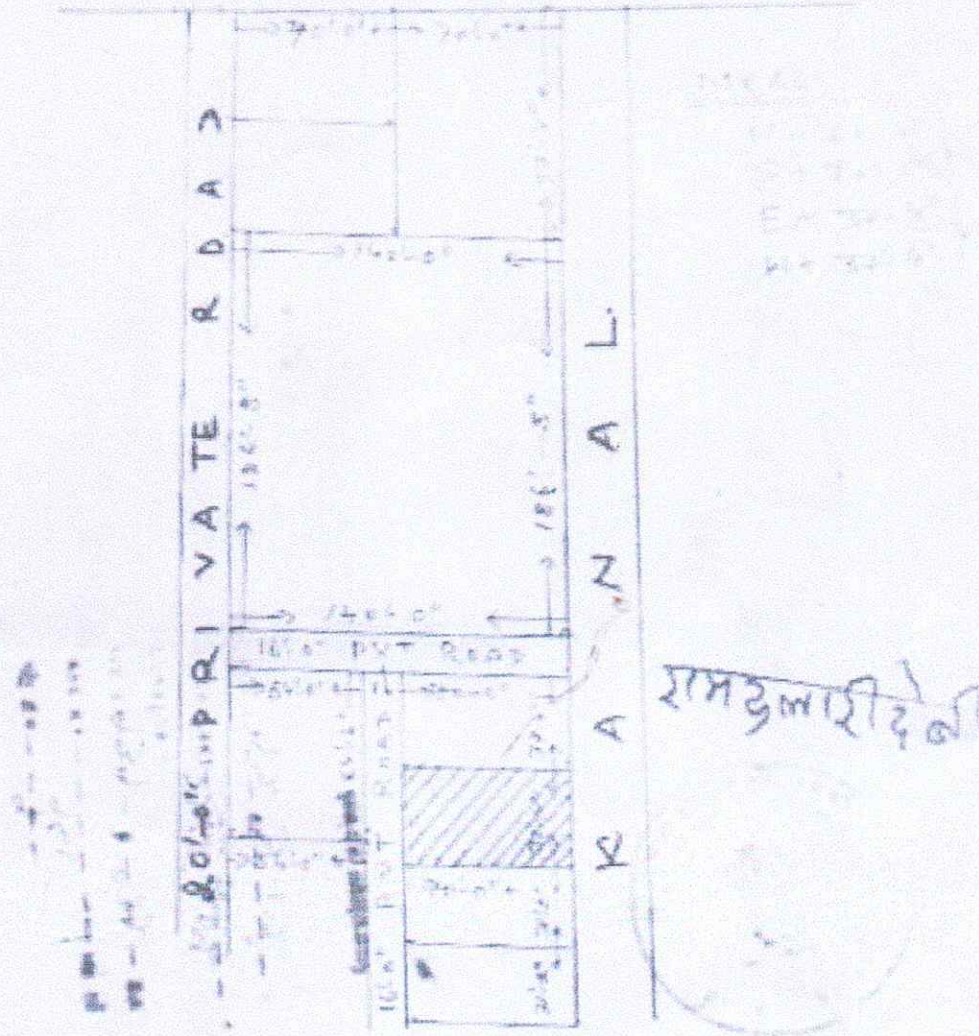

certified that both maps
 are exact and exact
 copy of each other.

Handwritten signature or stamp at the bottom right corner.