

AREA OF LAND UNDER MOUZA - SAPAHA NO. 265, WITHIN
MADHUPUR MUNICIPAL WARD NO. 1, UNDER THOKA NO.
6611, AREA - 2845 Sqft. SHOWN IN RED COLOUR
BELONGS TO RAJIA SULTANA & OTHER'S
AND NOW SOLD TO SMT. SAPNA KUMARI PANDEY
W/O - SRI LAL MUNI PANDEY OF HARLATANR P.S.
MADHUPUR DIST - DEOGHAR

S

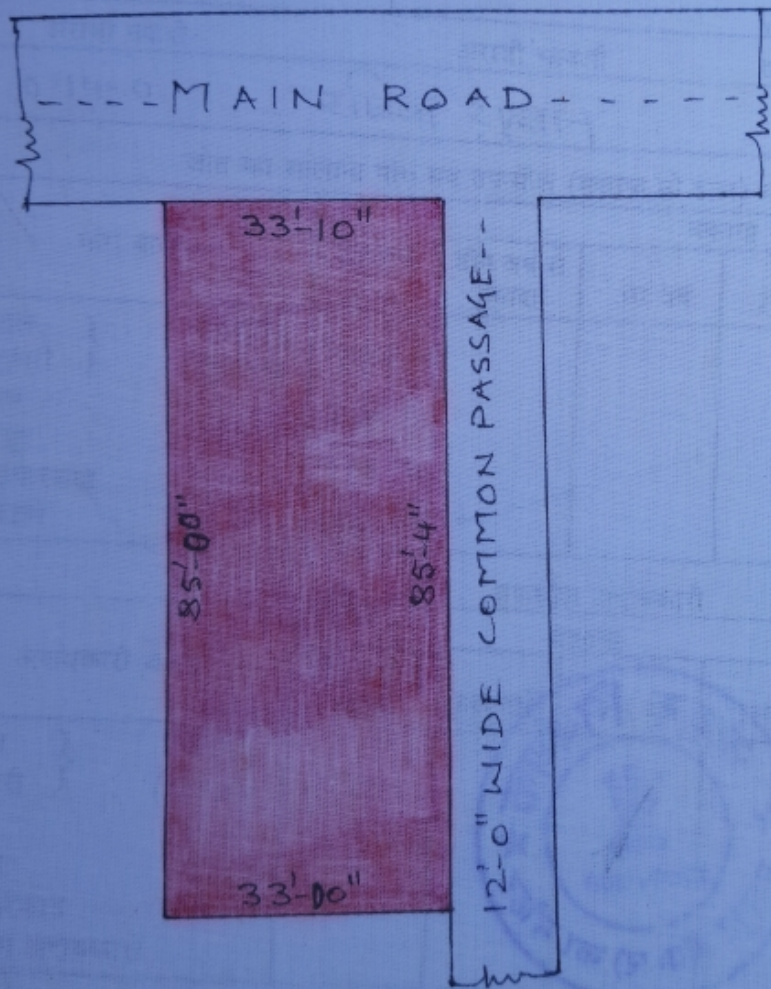

Handwritten signature or name in blue ink.

Tr...
P.K...
Handwritten notes in the bottom left corner.