

PRODUCED BY AN AUTODESK EDUCATIONAL PRODUCT

Project Title - PROPOSED R+G STORED R.C.C. COMMERCIAL BUILDING FOR KUMAR VIKRAM AND VIJAY KUMAR

SECTION SCALE 1/50
SEPTIC TANK DETAILS

PLAN FOR SEPTIC TANK

PLAN

SECTION

DETAIL OF GROUND WATER RECHARGING PIT WITH SILT TANK
SCALE - N.T.S.

L.I.S. ELEVATION

FRONT ELEVATION

CROSS - SECTION ON A-A

CROSS - SECTION ON B-B

LOWER BASEMENT

GROUND FLOOR PLAN

TERRACE FLOOR PLAN

LOCATION MAP

This is certify that the structure design is in accordance with the latest I-S code (IS 8750-2000-2002).

BRIEF SPECIFICATION

- BRICK WORK IN FOUNDATION & SUPERSTRUCTURE.
- FIRST CLASS BRICK WORK IN CEMENT MORTAR (1:4)
- D.P.C. - 7" D.P.C. IN CEMENT CONCRETE (1:2:4).
- FLOOR - (a) 1" I.P.S. (b) MOSAIC FLOORING.
- ROOF - 5" THK. R.C.C. ROOF (1:1.5:3)
- LINTEL BAND AT 3' LVL. - 6" THK. R.C.C. LINTEL (1:1.5:3)
- STAIRS - RISE - 6", TREAD - 10"
- DOORS - D-3'3"X7'0", D1-3'0"X7'0", D2-2'0"X7'0"
- WINDOWS - W-3'0"X4'0", W1-4'0"X4'0", W2-2'0"X4'0"
- VENTS - 2'0"X2'0"
- SAL WOOD FRAME & PANGAL WOOD SHUTTERS SHALL BE USED FOR DOOR.
- ALUMINIUM GLAZED WINDOW AND VENTILATORS WITH GUARD BARS SHALL BE USED.
- I.P.S. FLOOR SHALL BE USED OVER R.C.C. SLAB/P.C.C.
- ALL MASONRY SURFACES SHALL BE PLASTERED WITH CEMENT MORTAR (1:3 R.C.C. WITH CEMENT MORTAR 1:4 IN ROOF)
- ALL STEEL AND WOOD WORK SHALL BE PAINTED WITH SYNTHETIC PAINT
- ALL SANITARY AND ELECTRICAL FITTINGS SHALL BE OF STANDARD AND COMMERCIAL QUALITY.

SCHEDULE OF DOORS AND WINDOWS

S.No	Type	Width	Height	Lintel	Description
1	D1	1050	2100	2100	double shutter panel door
2	D1	975	2100	2100	double shutter panel door
3	D2	900	2100	2100	single shutter panel door
4	D3	750	2100	2100	single shutter panel door
5	D4	1800	2100	2100	Fully glazed door
6	D5	1200	2100	2100	double shutter panel door
7	W1	1200	1200	2100	4 leaf glazed shutter
8	V	600	600	2100	ventilation

CLIENT

PROPOSED COMMERCIAL BUILDING FOR KUMAR VIKRAM & VIJAY KUMAR, S/O NAGESHWAR BHAIYA AND LATE DHIRENDRA PD RAY, LAND UNDER MOUZA - SAPAHA, NO - 265, WARD NO - 3 J.B. NO. - 55/28, PART OF PLOT NO. - 819, WITHIN MADHUPUR NAGAR PARISAD, DISTRICT - DEOGHAR, JHARKHAND.

DESIGNED BY: **LUJAWAL KUMAR** sheet
CHECKED BY: **NASSIR AHMAD** 01
DRAWN BY: **NASSIR AHMAD**
ISSUE ONLY FOR SUBMISSION

ARCHITECT **CLIENT**

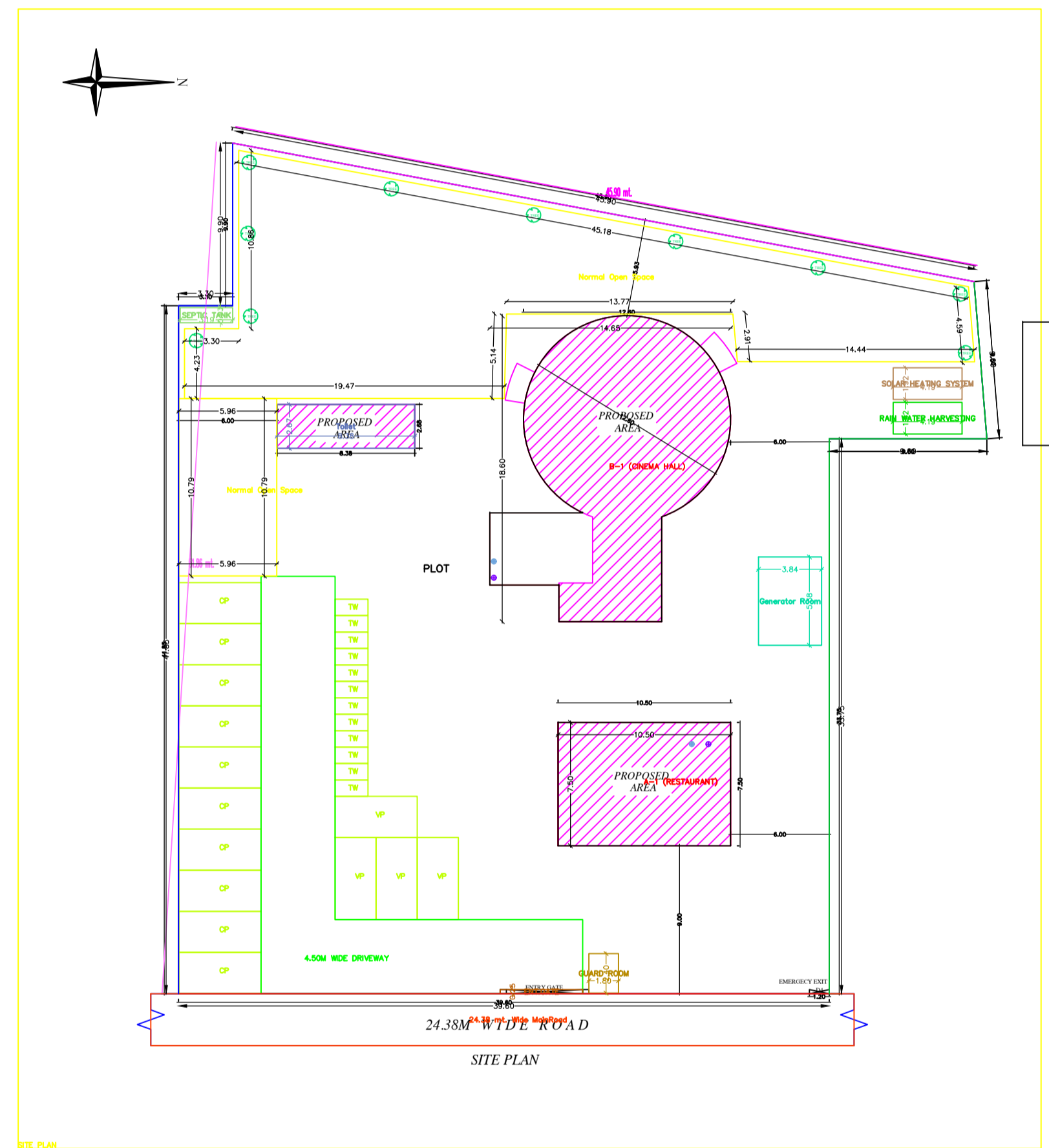

Building (A) (RESTAURANT)

Particulars	Rate	Qty	Amount
Excavation	100.00	100.00	10000.00
Foundation	200.00	100.00	20000.00
Structure	300.00	100.00	30000.00
Roofing	150.00	100.00	15000.00
Finishing	100.00	100.00	10000.00
Contingency	50.00	100.00	5000.00
Total			100000.00

SCHEDULE OF JOINTS

Joint No.	Location	Material	Qty	Rate	Amount
1	Foundation	Concrete	100.00	100.00	10000.00
2	Structure	Concrete	100.00	100.00	10000.00
3	Roofing	Concrete	100.00	100.00	10000.00
4	Finishing	Concrete	100.00	100.00	10000.00
Total					40000.00

URUBILA Table for Building (A) (RESTAURANT)

Particulars	Rate	Qty	Amount
Excavation	100.00	100.00	10000.00
Foundation	200.00	100.00	20000.00
Structure	300.00	100.00	30000.00
Roofing	150.00	100.00	15000.00
Finishing	100.00	100.00	10000.00
Contingency	50.00	100.00	5000.00
Total			100000.00

Project Title - PROPOSED COMMERCIAL BUILDING FOR KUMAR VIKRAM AND VIJAY KUMAR

SECTION SCALE 1/50
SEPTIC TANK DETAILS

PLAN FOR SEPTIC TANK

PLAN

SECTION

DETAIL OF GROUND WATER RECHARGING PIT WITH SILT TANK
SCALE - N.T.S.

SIDE ELEVATION

FRONT ELEVATION

CROSS - SECTION ON A-A

GROUND FLOOR PLAN

TERRACE FLOOR PLAN

LOCATION MAP

This is certify that the structure design is in accordance with the latest I-S code (IS 8750-2000-2002).

BRIEF SPECIFICATION

- BRICK WORK IN FOUNDATION & SUPERSTRUCTURE.
- FIRST CLASS BRICK WORK IN CEMENT MORTAR (1:4)
- D.P.C. - 7" D.P.C. IN CEMENT CONCRETE (1:2:4).
- FLOOR - (a) 1" I.P.S. (b) MOSAIC FLOORING.
- ROOF - 5" THK. R.C.C. ROOF (1:1.5:3)
- LINTEL BAND AT 3' LVL. - 6" THK. R.C.C. LINTEL (1:1.5:3)
- STAIRS - RISE - 6", TREAD - 10"
- DOORS - D-3'3"X7'0", D1-3'0"X7'0", D2-2'0"X7'0"
- WINDOWS - W-3'0"X4'0", W1-4'0"X4'0", W2-2'0"X4'0"
- VENTS - 2'0"X2'0"
- SAL WOOD FRAME & PANGAL WOOD SHUTTERS SHALL BE USED FOR DOOR.
- ALUMINIUM GLAZED WINDOW AND VENTILATORS WITH GUARD BARS SHALL BE USED.
- I.P.S. FLOOR SHALL BE USED OVER R.C.C. SLAB/P.C.C.
- ALL MASONRY SURFACES SHALL BE PLASTERED WITH CEMENT MORTAR (1:3 R.C.C. WITH CEMENT MORTAR 1:4 IN ROOF)
- ALL STEEL AND WOOD WORK SHALL BE PAINTED WITH SYNTHETIC PAINT
- ALL SANITARY AND ELECTRICAL FITTINGS SHALL BE OF STANDARD AND COMMERCIAL QUALITY.

SCHEDULE OF DOORS AND WINDOWS

S.No	Type	Width	Height	Lintel	Description
1	D1	1050	2100	2100	double shutter panel door
2	D1	975	2100	2100	double shutter panel door
3	D2	900	2100	2100	single shutter panel door
4	D3	750	2100	2100	single shutter panel door
5	D4	1800	2100	2100	Fully glazed door
6	D5	1200	2100	2100	double shutter panel door
7	W1	1200	1200	2100	4 leaf glazed shutter
8	V	600	600	2100	ventilation

CLIENT

PROPOSED COMMERCIAL BUILDING FOR KUMAR VIKRAM & VIJAY KUMAR, S/O NAGESHWAR BHAIYA AND LATE DHIRENDRA PD RAY, LAND UNDER MOUZA - SAPAHA, NO - 265, WARD NO - 3 J.B. NO. - 55/28, PART OF PLOT NO. - 819, WITHIN MADHUPUR NAGAR PARISAD, DISTRICT - DEOGHAR, JHARKHAND.

DESIGNED BY: **LUJAWAL KUMAR** sheet
CHECKED BY: **NASSIR AHMAD** 01
DRAWN BY: **NASSIR AHMAD**
ISSUE ONLY FOR SUBMISSION

ARCHITECT **CLIENT**

Building (B) (CINEMA HALL)

Particulars	Rate	Qty	Amount
Excavation	100.00	100.00	10000.00
Foundation	200.00	100.00	20000.00
Structure	300.00	100.00	30000.00
Roofing	150.00	100.00	15000.00
Finishing	100.00	100.00	10000.00
Contingency	50.00	100.00	5000.00
Total			100000.00

SCHEDULE OF JOINTS

Joint No.	Location	Material	Qty	Rate	Amount
1	Foundation	Concrete	100.00	100.00	10000.00
2	Structure	Concrete	100.00	100.00	10000.00
3	Roofing	Concrete	100.00	100.00	10000.00
4	Finishing	Concrete	100.00	100.00	10000.00
Total					40000.00

URUBILA Table for Building (B) (CINEMA HALL)

Particulars	Rate	Qty	Amount
Excavation	100.00	100.00	10000.00
Foundation	200.00	100.00	20000.00
Structure	300.00	100.00	30000.00
Roofing	150.00	100.00	15000.00
Finishing	100.00	100.00	10000.00
Contingency	50.00	100.00	5000.00
Total			100000.00