

NUSRAT JAHAN

MNP/BP/0044/W03/2021

Plot no - 152/319, Khata no - 19/7 AND 73/A
MOUZA - SAPHA, Thana no - 264

Total Plot as per Deed = 312.45 SQ. MTR

Physical Area ~~is~~ measured at site
= 312.26 SQ. MTR

N - Land of Ishrat Jahan

S - 3.6 MTR Road

E - 3.0 MTR Road

W - VENDOR'S LAND

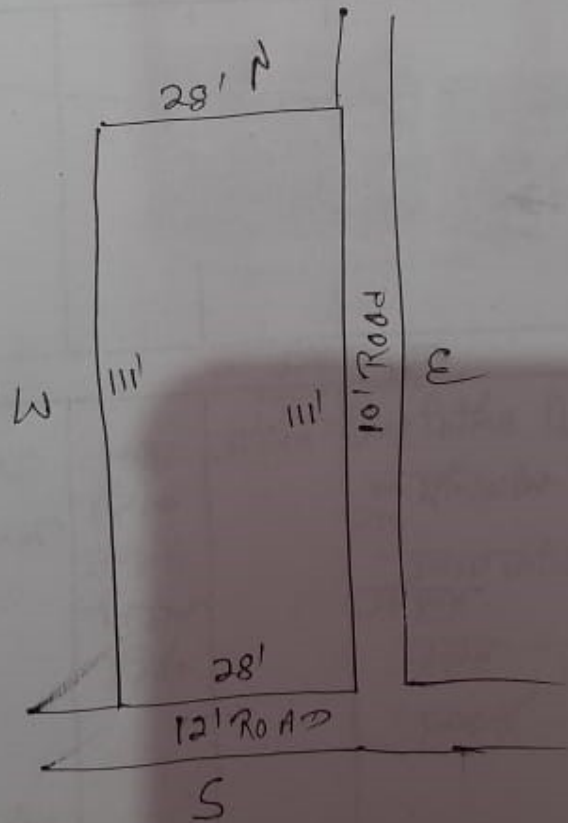

Samsung 64 MP Camera
Shot with my Galaxy M31 64 MP