

LAND & BUILDING OF SRI D.N. KUNDU, K.B. No. 15, WITHIN MOUZA
BARA-SEKHPURA No. 272, P.S. MADHUPUR, S.P. HOLDING No. 161, WARD No. XV
AREA OF LAND - 12K-10DH. SCALE 20' = 1" INCH.
SOLD TO SRI SAHDEO ROYA OF MADHUPUR, P.S. VILL-DHAB.

Ry. "B" CLASS LAND.

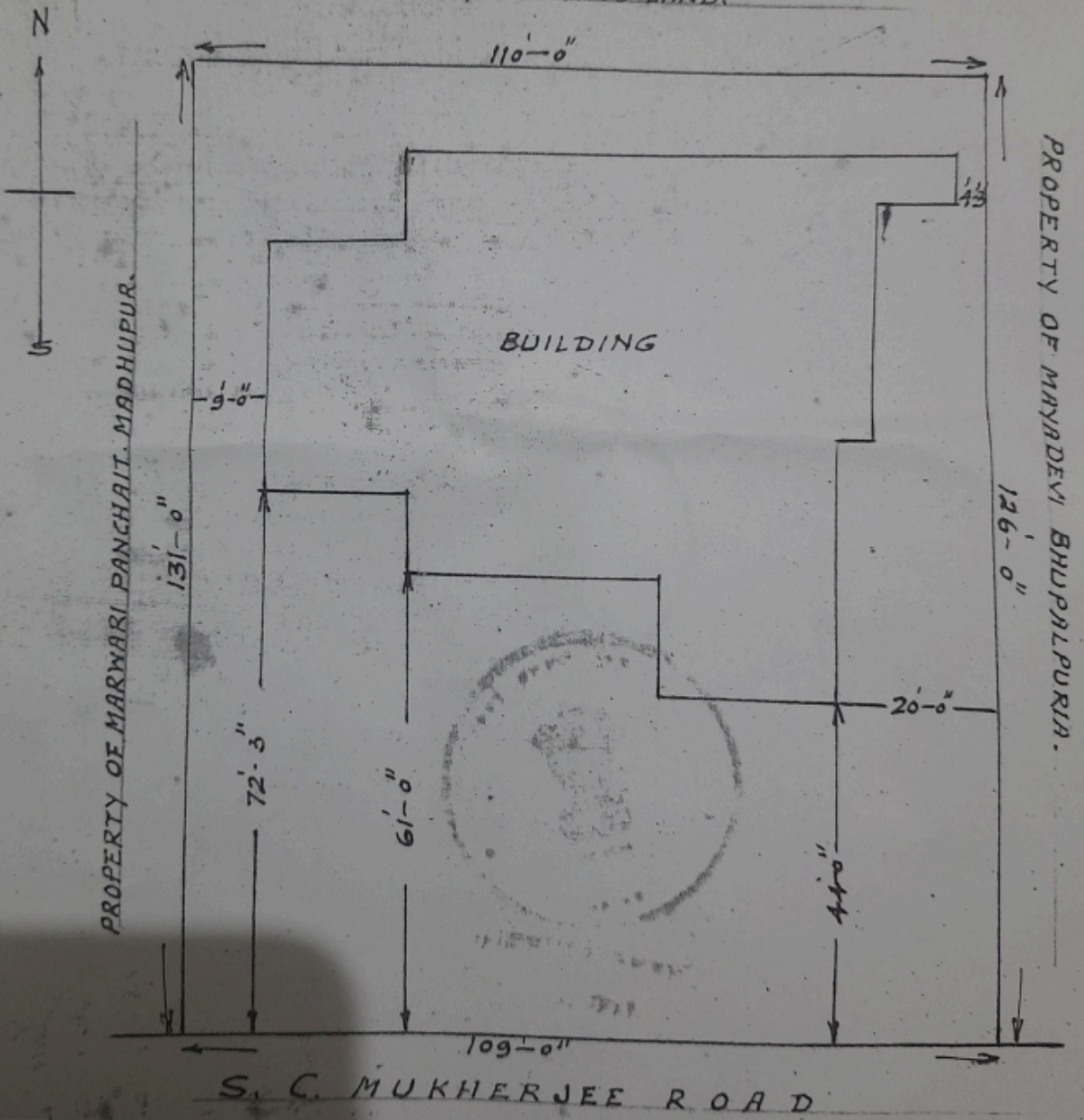

S. C. MUKHERJEE ROAD

DRAWN BY

Srinarayan...

VENDOR

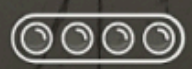

Samsung 64 MP Camera
 Shot with my Galaxy M31 64 MP