

BALRAM RAY

MNP/BP/0030/W06/2022

Khat no - 97/3, Plot no - NA

Mouza - Pathar chapti, Thana no - 27/

ROAD - 4.5 MTR

Total Area as per deed = 594.33 SQ. MTR

Physical Area as per site = 592.36 SQ. MTR

N - VENDORS LAND

S - VENDORS LAND

E - VENDORS LAND

W - ROAD 4.5 MTR

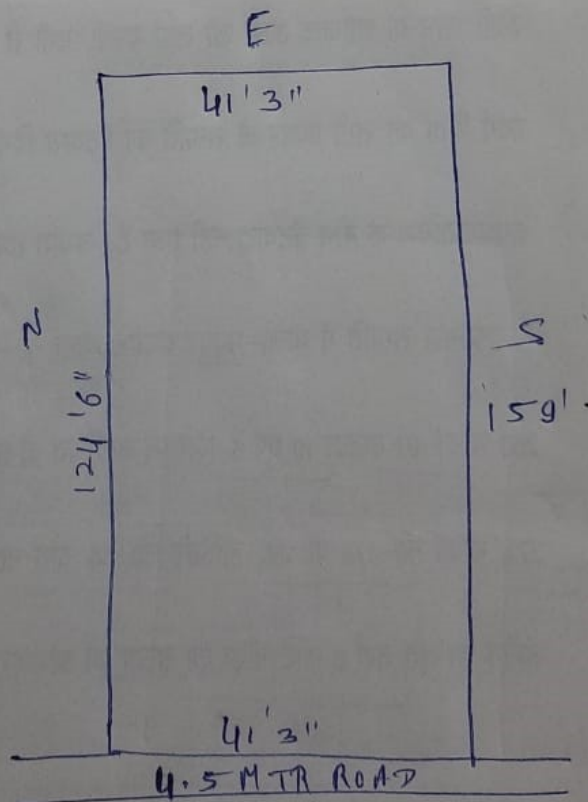

Samsung 64 MP Camera W  
Shot with my Galaxy M31 64 MP