

PRAMILA DEVI

MNP/BP/0037/W08/2022

Khata no - 169/1 - Plot no - NA

MOUZA - MADHUPUR BAZAR, Thano no - 269

ROAD - 4.5 MTR

Area as per Deed = 81.31 SQ. MTR

Physical Area as per site = 80.32 SQ. MTR

N - LAND OF RAM LAKHANSAH

S - Private Passage

E - ROAD - 4.5 MTR

W - VENDORS LAND

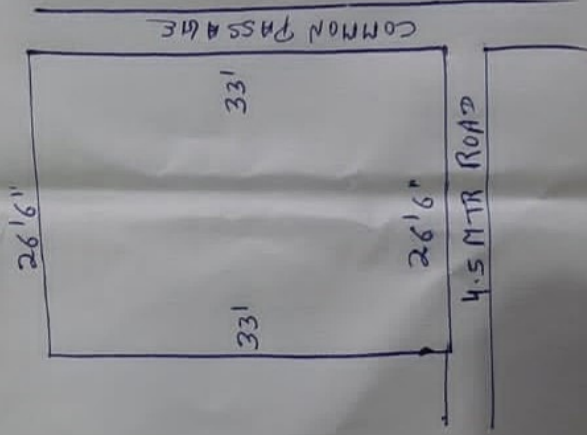

Samsung Quad Camera
Shot with my Galaxy M31 64 MP