

PLAN OF LAND UNDER MAUZA KUSMAHA-371
 WITHIN MADHUPUR MUNICIPAL W. NO. 14
 JB. NO-3571 PLOT NO-13,14 AREA 2 KATHA
 (MORE OR LESS) SHOWN IN RED COLOUR BELONGS
 TO SRI BHOLA MAHTO NOW SOLD TO SRI
 SHANKAR PRASAD BERNWAL OF MADHUPUR
 LAND OF KISTO MAHTO

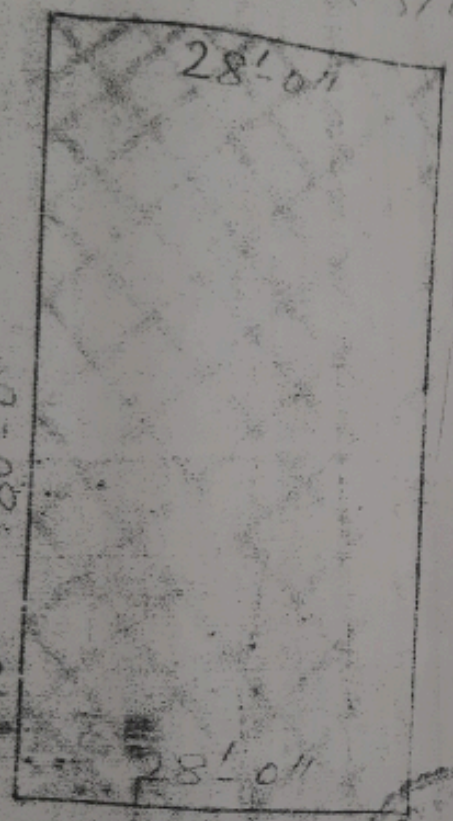

VENDOR LAND

VENDOR LAND

12'-6" WIDE ROAD

Bhola Mahato
 31-8-1987

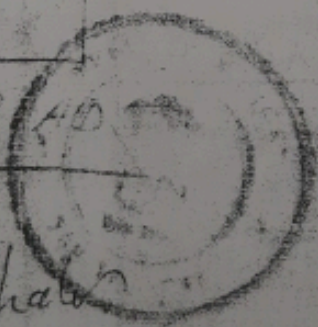

Treed by
 [Signature]
 Adv.
 31.8