

N
 MOUZA - MADHUPUR NO-268 P.S+P.O MADHUPUR DIST-DEOGHAR BASAURI LAND
 UNDER THOKA NO 67/A UNSURVEYED "K A" PLOT AREA TWO PLOT MORE OR LESS
 1. 665 SFT 2. 126.8 SFT SHOWN HERE RED COLOUR & BLUE COLOUR SHARE OF
 (1) NIADIPRA (2) CHANDRA SHEKHAR PRASAD
 (3) PRADIP PRASAD & JITENDRA PRASAD S/O LATE BHAGIRATHI PRASAD R/O
 KHALASI MOHALLA. P.O+P.S - MADHUPUR - DIST - DEOGHAR ST. JHARKHAND, WARD NO 4
 PIN - CODE - 815353

NOW IN SOLD IN BABITA KUMARI w/o MUKESH KUMAR - VILL
 - NAWADA SHANKARPUR. P.O SHANKARPUR, MUNGER, MUNGER, BIHAR, 811201
 TOTAL AREA - 665 + 126.8 = 791.8 SFT = 1.81 decimal

← BOUNDARY ⇒

- NORTH ⇒ LAND SHARE OF PRADIP PRASAD SOLD BY ALL SHARE
- SOUTH ⇒ LAND SHARE OF JITENDRA PRASAD SOLD BY 126.5 SFT SHARE
- EAST ⇒ LAND OF KISHOR TANTI
- WEST ⇒ MUNICIPAL ROAD

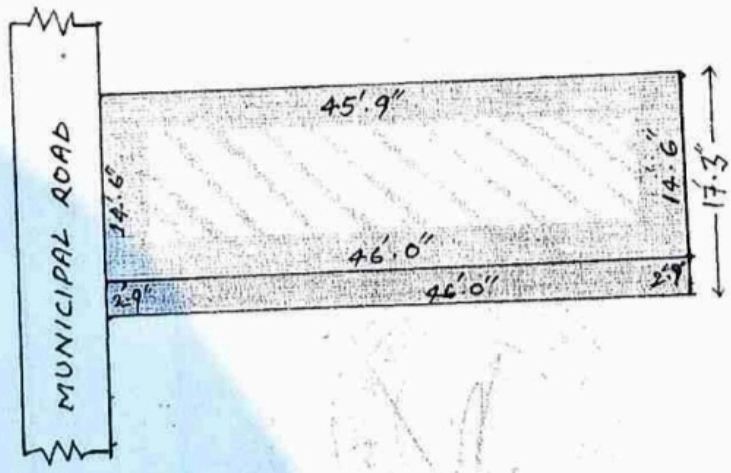

SIGNATURE OF 4 SHARE 1
 2
 3
 4

Handwritten signatures of the four shares, including names like 'MUKESH KUMAR' and 'BABITA KUMARI'.

MD TAJ HASAN ANSARI
 AMWI MADHUPUR
 8000000
 Md Taj Hasan Ansari