

N
S

PLAN OF BASOURI LAND OF MOUZA PATHAR CHAPTI
-NO-271, PART OF THOUKA NO-147 & 148, AREA=4050'0"SFT
UNDER MADHU PUR MUNICIPAL WARD NO-IV
P.S. SUBDIVISION - MADHU PUR, DIST- DEOGHAR,
BELONGS TO SRI NAWAL KISHOR SAH S/O LATE DURGA -
PRASAD SAH OF MADHU PUR AND NOW SOLD TO MARTIN KHAN -
S/O LATE SAYUB KHAN OF VILLAGE-RAJDAHA, P.S. MADHU PUR
DIST- DEOGHAR. SHOWN IN RED COLOUR.

Scale:- 1" INCH = 25' 0" FT.

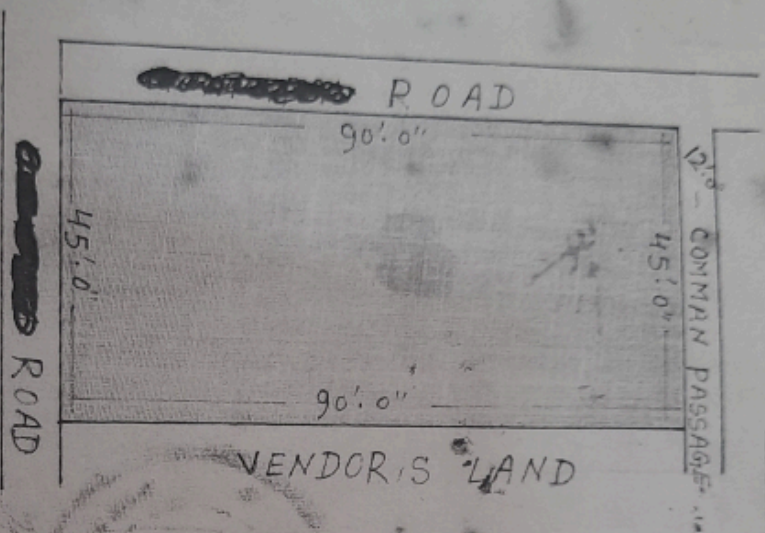

NO:- 19' 0" COMMON PASSAGE
S:- ~~ROAD~~ ROAD
E:- VENDOR'S LAND
W:- ~~ROAD~~ ROAD

میدان برکتیہ

Md.A.A. Ansari
Amin.