

PLAN OF PURCHASING LAND. INDEX MAP

MOUZA:- PAKUR. NO:-128

Scale 32" = 1 Mile

PLOT NO:- 1794 (PART)

PURCHASE AREA:- 01 KATHA 04.25 Db

P.S & DT - PAKUR.

SITE PLAN  
Scale - 1cm = 5'-0"

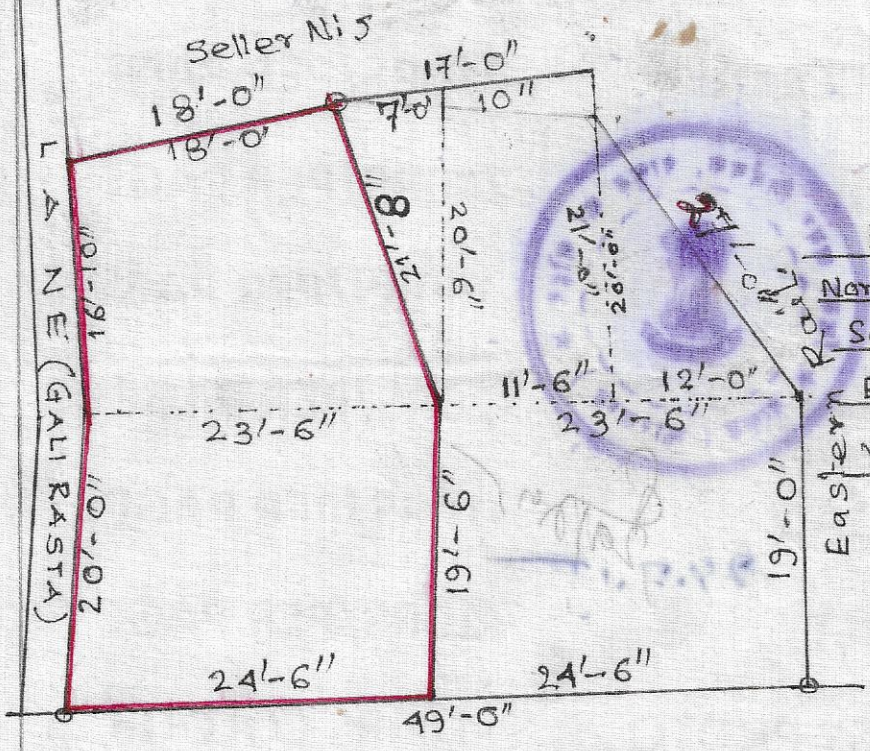
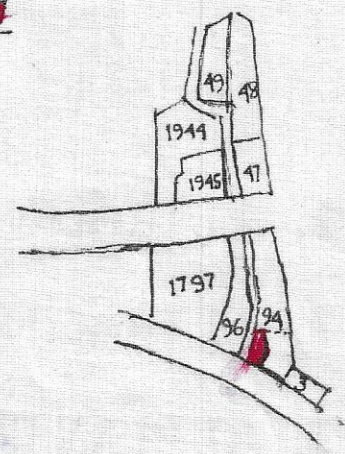

BOUNDARY

- North:- Seller Ni 5
- South:- Dhuliyah Road
- East Manoj + DHURUB  
Kan Bhagat
- West:- Lane (Gali Rasta)

R...O...A...D

Name of Purchaser:-  
NARAYAN PRASAD BHAGAT.  
OMPRAKASH BHAGAT.  
S/o Late Shew Prasad Bhagat.

Name of Seller:-  
Parash Nath Sharma.  
S/o Late Ram dhan Sharma.

Sign of Purchaser  
Narayan Prasad Bhagat  
Om Prakash Bhagat

Sign of Seller.  
पारश नथ शर्मा  
पारश नथ शर्मा  
29/07/2015

10-2-2015  
Land Surveyor  
Reg.No:-10742 Of 87/88  
VIII:Ghersha, P.O: Rajgram,  
Dist -Birbhum

12

PLAN OF PURCHASING LAND INDEX MAP  
MOUNTAIN PAKUR. NO. 128  
PLOT NO. 1794 (PART)

PURCHASE AREA - OIKATHA 04.2500  
P.S. CD - PAKUR.



- 1. A1 TRACING COLOUR 300 RS/PER PAGE
- 2. A1 TRACING B/W 250 RS/PER PAGE
- 3. A1 PLAN COLOUR 300 RS/PER PAGE
- 4. A1 PLAN B/W 250 RS/PER PAGE
- 5. A1 TRACING B/W 250 RS/PER PAGE
- 6. A1 TRACING COLOUR 300 RS/PER PAGE
- 7. A4 NORMAL 100 RS/PER PAGE
- 8. SCAN ONLY 100 RS/PER PAGE
- 9. A4 GLOSSY PHOTO 100 RS COLOUR



*[Handwritten signature]*

Name of Purchaser:	Name of Seller:
KARAYAN PRASAD BHASAT	Prasad Mohan Bhasat
OMPRAKASH BHASAT	2/2 Late Ram Mohan Bhasat
2/2 Late Shyam Prasad Bhasat	
2/2 Late Prasad Bhasat	
2/2 Late Prasad Bhasat	
2/2 Late Prasad Bhasat	

Reg. No. 10745 OF 2788  
VII. District P. O. Rajshahi  
Dist. Birbhum

LA ME (GALIBATI)  
NO. 10-102