

2346 sale 127000/- 800/- 623920/- 5100/- 2291000Rs.



F.M.
07/10/05

कानून 21 के अधीन भारतीय राज्य अधिनियम 1099
के अधिनियम (शुद्ध) को धरती के अधिनियम धारा 46
द्वारा 1 के अधिनियम 23 के अधिनियम के अधिनियम
के अधिनियम के अधिनियम के अधिनियम के अधिनियम
के अधिनियम के अधिनियम के अधिनियम के अधिनियम

[Signature]
D.D. Mahato
Advocate
Ghatsila



ATTSTED
D.D. Mahato
Advocate
Ghatsila Court

[Signature]
50/10/05
7/10/05



[Handwritten note]
The no. 11:30 AM - Ghatsila
certify that the sign's fingerprint
of the left hand of the person
have been obtained by me.
C.D. Mahato
Advocate
7/10/05

[Signature]
मुसय्याक

SALE DEED

VENDOR : SRI SACHINANDAN DUTTA, Son of Late Rashik Lal Dutta, by Caste- Gandhabanik, by Occupation - Cultivation, by Nationality- Indian, resident of village- Chakulia, P.O. & P.S. Chakulia, Dist. East Singhbhum, Jharkhand, Constitute Nominate and appoint my youngest Son SRI TAPAN KUMAR DUTTA, Son of Sri Sachinandan Dutta, by Caste - Gandhabanik, by Nationality- Indian, by Occupation- Cultivation, resident of village - Chakulia, P.S. Chakulia, District East Singhbhum, Jharkhand, Vide General Power of Attorney being no. 21, Book-IV, dated : 07.07.2004, Registered at Ghatsila Sub-Registry office.

[Handwritten note]
fee chargeable

Att. 1978
250
294

[Signature]
370

1000Rs.



Tapas Kumar Bera
27/10/03

- 2 -

PURCHASERS : 1. SRI NAND KISHORE NAYAK, 2. SRI NAB KISHORE NAYAK, both Son of Sri Saryu Kumar Nayak, both are by Caste- Bhuinya, by Nationality- Indian, by Occupation- Service, resident of village- Birdaha, P.S. Chakulia, District East Singhbhum, Jharkhand.

NATURE OF TRANSFER : S A L E D E E D.

CONSIDERATION MONEY : Rs. 1,27,000/- (Rupees One Lakh Twenty Seven thousand) only.

S C H E D U L E

(Description of the property hereby sold)

In the District East Singhbhum, Pargana- Dhalbhum, Dist. Sub-Registry office at Jamshedpur, Sub-Registry office at Ghatsila In Mouza- Khakrisole, P.S. Chakulia, Survey thana no. 345, In Halka no. IV, Ward No. 8 , Recorded under Khata no. 71, Plot no. 276, Area - 2.15 Decimals (Two point one five Decimals) of Purani Parti Kabil Abad, which is bounded by North : Tapas Kumar Bera to-day purchased, South : Soma, East : 10' ft. Wide Common Rasta, West : Plot no. 277.

Contd.....3.

1000Rs.



Tapas Kumar Bera
2/10/09

- 3 -

AND Plot no. 277, Area- 1.74 Decimals (One point Seven four Decimals), of Moti Arh, which is bounded by North : Tapas Kumar Bera to-day purchased, South : Soma, East : Plot no. 276, West : Plot no. 278.

AND Plot no. 278, Area - 2.44 Decimals (Two point four four Decimals) of Don-II land, which is bounded by North : Tapas Kumar Bera to-day purchased, South : Soma, East : Plot no. 277, West : Mali,

TOTAL AREA - 6.33 Decimals, (Six point three three Decimals) of land. Measurement of the land on the North Side : 88'ft. on the South Side : 90'ft. on the East Side : 30'ft. and on the West Side : 31'ft. The location of the land has been shown in the sketch map in Red colour, attached herewith which will be form part of this sale deed.

Annual Rent : 0.75 Paise only, payable to the landlord, the State of Jharkhand, through the C.O.Chakulia.

The aforesaid land purchased for Homestead purpose.

KNOW ALL MEN BY THESE PRESENTS That, the vendor is sole, absolute, legal and rightful owner of the above schedule land morefully described in the schedule above. The said Khata no. 71 has been recorded in the present survey settlement operation

Contd....4.

1000Rs.



Tapankulk
7/10/09

- 4 -

of 1964 in the name of vendor, namely Sachinandan Dutta and he is coming in peaceful possession and enjoyment of the same without any interruption from any body.

AND WHEREAS, the vendor is being in urgent need of money for his domestic affairs and other legal expenses, the vendor proposed to sell his raiyati land morefully described in the schedule above and the purchasers having offered the highest market price of Rs. 1,27,000/- (Rupees One Lakhs Twenty Seven thousand) only for the said land, the price fixed. The vendor is hereby selling the above schedule land and executing this sale deed after receipt of the full and final consideration money of Rs. 1,27,000/- (Rupees One Lakhs Twenty Seven thousand) only. The receipt of which is hereby acknowledged. The vendor has delivered the peaceful physical possession of the above schedule land to the purchasers, who will possess and enjoy the same in raiyati right, title, interest and possession in all possible ways and will

Contd.....5.

1000Rs.



Tapan Kumar
7/10/09

- 5 -

have their names mutated and registered in the office of landlord and pay rent for the same in their own names and obtaine rent receipt for the same. The purchasers will also be entitled to erect any house etc. on the said land and will live there with their family.

From to-day all the right, title, interest and possession of the vendor will cease to exist and will vest in the purchasers. The above schedule land is free from all kind of encumbrances. The vendor has not charged or transferred the above schedule land with any body else previously and if for any defect of title or possession of the vendor, the purchasers suffers any loss then the vendor will compensate the same. The terms vendor and purchasers used in this deed will mean and include their heirs and successors etc. unless the same is repugnant to the context.

Contd....6.



झारखण्ड JHARKHAND

A 013699

- 6 -
Tapan Kumar Bera
7/10/09

In Witness whereof the vendor do hereunto set his hand on it to-day at Ghatsila on 7 th day of October, 2009.

Read over and explained the contents of this sale deed to the executant, who admitted the same to be true and correct.

Witnesses:-

1. Tapan Kumar Bera
07/10/09

2. Ranchar Mahato.

Typed by :-

Ranchar Mahato
07/10/2009
(J.N.Mahato)Ghatsila court.

Drafted by :-

Ranchar Mahato
7/10/09
Advocate.
(D.P. Mahato)

Contd....7.

Contd....2.

Tapan Kr. Sutar.
7/10/09

- 7 -

PURCHASERS.



D.D. Mahato
Advocate
Ghatsila Court

Tapan Kr. Sutar
7/10/09



D.D. Mahato
Advocate
Ghatsila Court

Nab Kishore Nayak
7/10/09



Certified that the left hand five finger of the purchasers,
whose photographs are affixed in the document have been
obtained by me.

Rahato
Advocate 7/10/09
D.D. Mahato



निबंधन विभाग, झारखंड
घाटशिला
जांच पर्चा-सह घोषणा प्रपत्र (नियम 114)

Token No: 14

Token Date/Time: 07/10/2009 14:12:51

Document Type	Sale Deed	Presenter	Tapan Kr Dutta	Date of Entry	07/10/2009
Presenter Name & Address	Vill-Chakulia, Ps-Chakulia, E Singhbhum	DOE		Total Pages	20
Stampable Doc. Value	127000	Stamp Value	5100	Book	1
Document Value	127000	Serial No.	0	CNO/PNO	
Special Type					
Remarks / Other Details					

Property Details:

Anchal	Th.No.	Wrd/Hlk	Mauza	Kh. No.	Plot No	Plot Type	H No	Category	Area
CHAKULIA	345	4	KAKDISHOL	71	278			DON2	2.44 Decimal
CHAKULIA	345	4	KAKDISHOL	71	276			TAANRD1	2.15 Decimal
CHAKULIA	345	4	KAKDISHOL	71	277			Motiaar	1.74 Decimal

Other Property Details:

Property Type	Th. No.	Wrd	Mauza	Location	Area	Rate	Amount
---------------	---------	-----	-------	----------	------	------	--------

Party Details:

SN	P Type	Party Name	Father/Husband	Occup.	Caste	PAN/F 60	Address
1	VENDOR	Tapan Kr Dutta	Sachinandan Dutta	Cultivation	Other		vill-chakulia, ps-chakulia, E singhbhum
2	VENDEE	Nand Kishore Nayak	Saryu Kr Nayak	Service	Other		Vill-birdaha, Ps-Chakulia, E Singhbhum
3	VENDEE	Nab Kishore Nayak	Saryu Kr Nayak	Service	Other		Vill-Birdaha, Ps-Chakulia, E Singhbhum
4	Identifier	Tapas Kr Bera	Late Srinath Ch Bera	Cultivation	Other		Vill-Birdaha, Ps-Chakulia, E Singhbhum
5	Witness1	Tapas Kr Bera	Late Srinath Ch Bera	Cultivation	Other		Vill-Birdaha, Ps-Chakulia, E Singhbhum
6	Witness2	Kanchan Mahato	Late Yudhistir Mahato	Cultivation	Other		ghatsila, E singhbhum

Fee Details:

SN	Description	Amount
1	LL	2.50
2	P	0.94
3	A1	1,270.00
4	SP	300.00
Total		1,573.44

Tapan Kr. Dutta.

उपर्युक्त प्रविष्टियाँ दस्तावेज में अंकित तथ्यों के अनुरूप हैं।

निबंधन पूर्व सारांश में इंप्ट फार्म के अनुरूप डाटा इंट्री की गई है।

उपर्युक्त ने इस दस्तावेज के निष्पादन की मेरे सम्मक्ष

स्वीकार किया

जिसकी

पहचान

निवासी

तपन कुमार हुता
 तपस कुमार बेरा
 विवेक

पिता

ले. श्रीमथ चन्द्र बेरा
 पेशा

पेशा

प्रस्तुतकर्ता का हस्ताक्षर

डाटा इंट्री ऑपरेटर का हस्ताक्षर

निबंधन पदाधिकारी का हस्ताक्षर



निबंधन विभाग, झारखंड
घाटशिला

Token No.14 Token Date: 07/10/2009 14:12:51
Serial/Deed No./Year :2346/2296/2009
Deed Type: Sale Deed

SN	Party Details	Photo	Thumb
1	Tapan Kr Dutta Father/Husband Name:Sachinandan Dutta (VENDOR) vill-chakulia, ps-chakulia, E singhbhum		
2	Nand Kishore Nayak Father/Husband Name:Saryu Kr Nayak (VENDEE) Vill-birdaha, Ps-Chakulia, E Singhbhum	<input type="checkbox"/>	<input type="checkbox"/>
3	Nab Kishore Nayak Father/Husband Name:Saryu Kr Nayak (VENDEE) Vill-Birdaha, Ps-Chakulia, E Singhbhum	<input type="checkbox"/>	<input type="checkbox"/>
4	Tapas Kr Bera Father/Husband Name:Late Srinath Ch Bera (Identifier) Vill-Birdaha, Ps-Chakulia, E Singhbhum		
5	Tapas Kr Bera Father/Husband Name:Late Srinath Ch Bera (Witness1) Vill-Birdaha, Ps-Chakulia, E Singhbhum	<input type="checkbox"/>	<input type="checkbox"/>
6	Kanchan Mahato Father/Husband Name:Late Yudhistir Mahato (Witness2) ghatsila, E singhbhum	<input type="checkbox"/>	<input type="checkbox"/>

Book No. I
Volume 64
Page 165 To 184
Deed No 2346/2296
Year 2009
Date 07/10/2009 14:48:44

District Sub Registrar

Signature of Operator

शुद्धी की योजना :-
 नए प्लॉटों का नक्शा
 नए प्लॉटों का नक्शा

सर्वेक्षण
 कार्य
 का नक्शा

प्लॉट नं. 1
 प्लॉट नं. 2 का क्षेत्रफल
 प्लॉट नं. 3 का क्षेत्रफल
 प्लॉट नं. 4 का क्षेत्रफल
 प्लॉट नं. 5 का क्षेत्रफल

Talwar In. Sudder
 प्लॉटों की संख्या :-

90 - प्लॉट	0.06.33.00
80 - प्लॉट	
70 - प्लॉट	
60 - प्लॉट	0.24.4.00
50 - प्लॉट	0.01.34.00
40 - प्लॉट	
30 - प्लॉट	0.02.15.00
20 - प्लॉट	
10 - प्लॉट	
90 - प्लॉट	
80 - प्लॉट	
70 - प्लॉट	
60 - प्लॉट	
50 - प्लॉट	
40 - प्लॉट	
30 - प्लॉट	
20 - प्लॉट	
10 - प्लॉट	

278/p	
277/p	
276/p	
275/p	
274/p	
273/p	
272/p	
271/p	
270/p	
269/p	
268/p	
267/p	
266/p	
265/p	
264/p	
263/p	
262/p	
261/p	
260/p	
259/p	
258/p	
257/p	
256/p	
255/p	
254/p	
253/p	
252/p	
251/p	
250/p	
249/p	
248/p	
247/p	
246/p	
245/p	
244/p	
243/p	
242/p	
241/p	
240/p	
239/p	
238/p	
237/p	
236/p	
235/p	
234/p	
233/p	
232/p	
231/p	
230/p	
229/p	
228/p	
227/p	
226/p	
225/p	
224/p	
223/p	
222/p	
221/p	
220/p	
219/p	
218/p	
217/p	
216/p	
215/p	
214/p	
213/p	
212/p	
211/p	
210/p	
209/p	
208/p	
207/p	
206/p	
205/p	
204/p	
203/p	
202/p	
201/p	
200/p	
199/p	
198/p	
197/p	
196/p	
195/p	
194/p	
193/p	
192/p	
191/p	
190/p	
189/p	
188/p	
187/p	
186/p	
185/p	
184/p	
183/p	
182/p	
181/p	
180/p	
179/p	
178/p	
177/p	
176/p	
175/p	
174/p	
173/p	
172/p	
171/p	
170/p	
169/p	
168/p	
167/p	
166/p	
165/p	
164/p	
163/p	
162/p	
161/p	
160/p	
159/p	
158/p	
157/p	
156/p	
155/p	
154/p	
153/p	
152/p	
151/p	
150/p	
149/p	
148/p	
147/p	
146/p	
145/p	
144/p	
143/p	
142/p	
141/p	
140/p	
139/p	
138/p	
137/p	
136/p	
135/p	
134/p	
133/p	
132/p	
131/p	
130/p	
129/p	
128/p	
127/p	
126/p	
125/p	
124/p	
123/p	
122/p	
121/p	
120/p	
119/p	
118/p	
117/p	
116/p	
115/p	
114/p	
113/p	
112/p	
111/p	
110/p	
109/p	
108/p	
107/p	
106/p	
105/p	
104/p	
103/p	
102/p	
101/p	
100/p	
99/p	
98/p	
97/p	
96/p	
95/p	
94/p	
93/p	
92/p	
91/p	
90/p	
89/p	
88/p	
87/p	
86/p	
85/p	
84/p	
83/p	
82/p	
81/p	
80/p	
79/p	
78/p	
77/p	
76/p	
75/p	
74/p	
73/p	
72/p	
71/p	
70/p	
69/p	
68/p	
67/p	
66/p	
65/p	
64/p	
63/p	
62/p	
61/p	
60/p	
59/p	
58/p	
57/p	
56/p	
55/p	
54/p	
53/p	
52/p	
51/p	
50/p	
49/p	
48/p	
47/p	
46/p	
45/p	
44/p	
43/p	
42/p	
41/p	
40/p	
39/p	
38/p	
37/p	
36/p	
35/p	
34/p	
33/p	
32/p	
31/p	
30/p	
29/p	
28/p	
27/p	
26/p	
25/p	
24/p	
23/p	
22/p	
21/p	
20/p	
19/p	
18/p	
17/p	
16/p	
15/p	
14/p	
13/p	
12/p	
11/p	
10/p	
9/p	
8/p	
7/p	
6/p	
5/p	
4/p	
3/p	
2/p	
1/p	

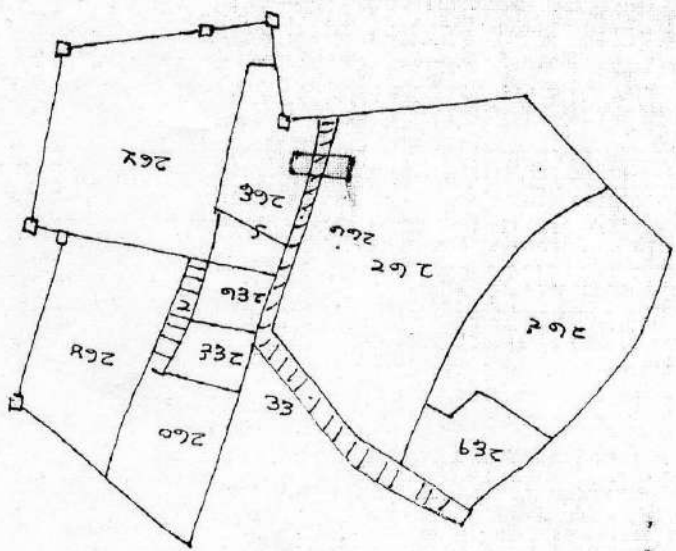
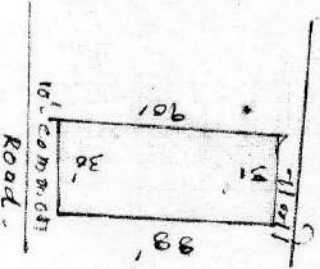

प्लॉट नं. 278 - 98' x 30' - 2930-00-00
 प्लॉट नं. 277 - 88' x 30' - 2930-00-00
 प्लॉट नं. 276 - 88' x 30' - 2930-00-00
 प्लॉट नं. 275 - 88' x 30' - 2930-00-00
 प्लॉट नं. 274 - 88' x 30' - 2930-00-00
 प्लॉट नं. 273 - 88' x 30' - 2930-00-00
 प्लॉट नं. 272 - 88' x 30' - 2930-00-00
 प्लॉट नं. 271 - 88' x 30' - 2930-00-00
 प्लॉट नं. 270 - 88' x 30' - 2930-00-00
 प्लॉट नं. 269 - 88' x 30' - 2930-00-00
 प्लॉट नं. 268 - 88' x 30' - 2930-00-00
 प्लॉट नं. 267 - 88' x 30' - 2930-00-00
 प्लॉट नं. 266 - 88' x 30' - 2930-00-00
 प्लॉट नं. 265 - 88' x 30' - 2930-00-00
 प्लॉट नं. 264 - 88' x 30' - 2930-00-00
 प्लॉट नं. 263 - 88' x 30' - 2930-00-00
 प्लॉट नं. 262 - 88' x 30' - 2930-00-00
 प्लॉट नं. 261 - 88' x 30' - 2930-00-00
 प्लॉट नं. 260 - 88' x 30' - 2930-00-00

1. नया प्लॉट
 2. पुराना प्लॉट